



Before using your washing machine, please read this manual carefully and keep it for future reference.

## 2.7 Cu.Ft. Washer and Dryer

### OWNER'S MANUAL



**MLC27N3AWW**

#### **Read This Manual**

Inside you will find many helpful hints on how to use and maintain your washing machine properly. Just a little preventative care on your part can save you a great deal of time and money over the life of your washing machine. You'll find many answers to common problems in the chart of troubleshooting tips. If you review the chart of Troubleshooting Tips first, you may not need to call for service.

Midea America Corp.  
300 Kimball Drive, Parsippany, NJ, USA 07054  
Customer Service 1-866-646-4332  
[www.midea.com](http://www.midea.com)

## Contents

### Contents

Safety And Precautions.....	2
Safety and precautions.....	2
Important safety instructions.....	3
Grounding instructions.....	6
Before operating this machine.....	6
Attention shall be paid to protecting the machine.....	6
Cautions during handling machine.....	6
Cautions when washing clothes.....	7
Installation Requirements.....	8
Installation Requirements.....	8
Tools and parts.....	8
Location requirements.....	9
Installation clearances.....	9
Electrical requirements.....	9
Washer dimensions.....	10
Unpacking the washing machine.....	10
Installation Instructions.....	11
Dispose the packing materials.....	11
Remove transport bolts and foam.....	11
Select the location.....	11
Connect inlet pipe.....	11
Install inlet pipe.....	12
Drain system options.....	12
Level the washer.....	13
Electrical connection.....	13
Operating Instructions.....	14
Checklist and preparation before washing clothes.....	14
View of control panel.....	18
Washing clothes at first time.....	22
Select the procedure.....	23
Table of washing procedures.....	24
Care And Cleaning .....	25
Troubleshooting Tips.....	29
Remove The Problems.....	30
Appendix.....	31
Technical Specifications.....	32

## Safety And Precautions

### Safety and precautions

This manual contains important information on the installation, use, and care of your appliance. Please read this manual carefully before installation and operation of this machine to prevent injury and property damage.

#### WHAT YOU NEED TO KNOW ABOUT SAFETY INSTRUCTIONS

Warnings and Important Safety Instructions in this manual DO NOT cover all possible conditions and situations that may occur. It is your responsibility to use common sense, caution and care when installing, maintaining and operating your washer.

#### IMPORTANT SAFETY SYMBOLS AND PRECAUTIONS



#### WARNING

This indicates that hazards or unsafe practices may cause **serious personal injury or death**. To reduce the risk of fire, explosion, electric shock, or personal injury when using your washer, these basic safety precautions **SHOULD** be followed.

#### State of California Proposition 65 Warnings



#### WARNING

The California Safe Drinking Water and Toxic Enforcement Act requires the Governor of California to publish a list of substances known to the State of California to cause cancer, birth defects, or other reproductive harm, and requires business to warn of potential exposure to such substances. This product contains a chemical known to the State of California to cause cancer, birth defects, or other reproductive harm. This appliance can cause low-level exposure to some of the substances listed, including benzene, formaldehyde, and carbon monoxide.

## Safety And Precautions

### Important safety instructions

SAVE THESE INSTRUCTIONS



**WARNING**

WARNING – To reduce the risk of fire, electric shock, or injury to persons when using your appliance, follow basic precautions, including the following:

- Read all instructions before using the appliance.
- Do not wash articles that have been previously cleaned in, washed in, soaked in, or spotted with gasoline, dry-cleaning solvents, or other flammable or explosive substances, as they give off vapours that could ignite or explode.
- Do not add gasoline, dry-cleaning solvents, or other flammable or explosive substances to the wash water. These substances give off vapours that could ignite or explode.
- Under certain conditions, hydrogen gas may be produced in a hot-water system that has not been used for 2 weeks or more. **HYDROGEN GAS IS EXPLOSIVE.** If the hot-water system has not been used for such a period, before using a washing machine, turn on all hot-water faucets and let the water flow from each for several minutes. This will release any accumulated hydrogen gas. As the gas is flammable, do not smoke or use an open flame during this time.
- Always unplug the washing machine from the power supply before attempting any service. Disconnect the power cord by grasping the plug, not the cord.
- To reduce the risk of fire, clothes, cleaning rags, mop heads and the like which have traces of any flammable substance, such as vegetable oil, cooking oil, petroleum based oils or distillates, waxes, fats, etc., must not be placed in the washing machine. These items may contain flammable substances which, even after washing, may smoke or catch fire.
- Never place items in the washer that have been dampened with gasoline or any combustible or explosive substance. Do not wash or dry anything that has been soaked in or spotted with any type of oil (including cooking oils). Doing so can result in fire, explosion, or death.
- Do not allow children to play on or in the appliance. Close supervision of children is necessary when the appliance is used near children.
- Pets and kids may climb into the machine. Check the machine before every operation.
- Glass door or protector may be very hot during the operation. Keep kids and pets far away from the machine during the operation.
- This machine is not intended for use by persons (including kids) with reduced physical, sensory or mental capabilities, or lack of experience and knowledge, unless they have been given supervision or instruction concerning use of the machine by a person responsible for their safety.
- Kids should be supervised to ensure that they do not play with the machine.
- When children become old enough to operate the appliance, it is legal responsibility of the parents or legal guardians to ensure that they are instructed in safe practices by qualified persons.

## Safety And Precautions

### Important safety instructions

SAVE THESE INSTRUCTIONS



**WARNING**

- Do not machine wash fiberglass materials (such as curtains and window coverings that use fiberglass materials.) Small particles may remain in the washing machine and stick to fabrics in subsequent wash loads causing skin irritation.
- Before the appliance is removed from service or discarded, remove the door and cut off the power cord.
- Do not reach into the appliance if the tub or agitator is moving.
- Do not install or store this appliance where it will be exposed to the weather.
- Do not tamper with controls.
- Do not repair or replace any part of the appliance or attempt any servicing unless specifically recommended in the user-maintenance instructions or in published user-repair instructions that you understand and have the skills to carry out.
- Never stop a tumble dryer before the end of the program and spread out so that the heat is dissipated.
- Pull out its plug from the power socket before cleaning or maintenance.
- Make sure that all pockets are emptied.
- Sharp and rigid items such as coin, brooch, nail, screw or stone etc. may cause serious damages to this machine.
- Pull out its plug and cut off water supply after the operation.
- Please check whether the water inside the drum has been drained before opening its door. Please do not open the door if there is any water visible.
- Do not try to repair the machine by yourself. The machine may be damaged or more troublesome repair work may be caused and even dangerous operation may take place if it is repaired by any inexperienced or unqualified staff.
- If the plug (power cord) is damaged, it shall be replaced by the manufacturer or a service agent to avoid any danger.
- Take care that power voltage and frequency shall be identical to those of washing machine.
- Do not use any socket with rated current less than that of washing machine. Never pull out power plug with wet hand.
- To ensure your safety, power cord plug must be inserted into an earthed three-pole socket. Check carefully and make sure that your socket is properly and reliably earthed.
- This machine shall be repaired only by an authorized service center and only authentic accessories can be used.
- An appliance shall be clearly and permanently marked with a warning that the appliance is intended for use only with fabrics that have been washed with water as a cleaning agent.
- To reduce the risk of fire, do not dry articles containing foam rubber or similarly textured rubber like materials.

## Safety And Precautions

### Important safety instructions

SAVE THESE INSTRUCTIONS



**WARNING**

- If connected to a circuit protected by fuses, use time-delay fuses with this appliance.
- Do not dry articles that have been previously cleaned in, washed in, soaked in, or spotted with gasoline, dry-cleaning solvents, or other flammable or explosive substances, as they give off vapours that could ignite or explode.
- Do not use fabric softeners or products to eliminate static unless recommended by the manufacturer of the fabric .
- Do not use heat to dry articles containing foam rubber or similarly textured rubber-like materials. The interior of the appliance should be cleaned periodically by qualified service personnel.
- Do not place items exposed to cooking oils in your dryer. Items contaminated with cooking oils may contribute to a chemical reaction that could cause a load to catch fire.

## Safety And Precautions

### Grounding instructions



**WARNING**

- This appliance must be grounded . In the event of a malfunction or breakdown, grounding will reduce the risk of electric shock by providing a path of least resistance for the electric current. This appliance is equipped with a cord

- Grounding conductor and a grounding plug. The plug must be plugged into an appropriate outlet that is properly installed and grounded in accordance with all local codes and ordinances.

WARNING-Improper connection of the equipment grounding conductor can result in electric shock. Connect to individual branch Circuit. Check with a qualified electrician or serviceman if you are in doubt as to whether the washer is properly grounded.

DO NOT modify the plug provided with the appliance if it will not fit the outlet . Please have a proper outlet installed by a qualified electrician.

### Before operating this machine



**WARNING**

- Packing materials may be dangerous to kids. Please keep all packing materials (plastic bags, foams etc) away from kids.
- Washing machine shall not be installed in A bathroom,very wet rooms as well as rooms with explosive or caustic gases.
- Make sure that the water and electric must be connected by a qualified technician in accordance with the manufacturer's instructions and local safety regulations.
- Before operating this machine, all packages and transport bolts must be removed. Otherwise, the washing machine may be seriously damaged during operation.
- Before first use, test the unit by selecting cotton and hot water without a load.
- This washing machine is for indoor use only.

### Attention shall be paid to protecting the machine



**WARNING**

- Do not climb up and sit on top cover of the machine.
- Do not lean against machine door.
- Please do not close the door with excessive forces. If it is found difficult to close the door, please check if the excessive clothes are preventing the door from closing properly.

### Cautions during Handling Machine



**WARNING**

- Transport bolts shall be reinstalled to the machine when transporting from one location to another.
- The accumulated water shall be drained out of the machine.
- Handle the machine carefully. Never hold each protruded part on the machine while lifting.
- Machine door can not be used as the handle during transportation..

## Safety And Precautions

### Cautions when washing clothes



**WARNING**

- Cold tap water shall be used and hot water may be also connected according.
- Your washing machine is only for home use and is only designed for the textiles suitable for machine washing.
- Flammable and explosive or toxic solvents are forbidden. Gasoline and alcohol etc. shall not be used as detergents. Please only select the detergents suitable for machine washing .
- It is forbidden to wash carpets.
- Be careful of burning when washing machine drains hot washing water.
- Never refill the water by hand during washing.
- After the program is completed, please open the door after the signal or disconnect the power supply to the machine.
- Always follow the fabric care instructions recommended by the clothing manufacturer.
- Do not use the washing machine if it has a worn power cord or loose plug. Contact an authorized service agent.
- Do not operate the washing machine if any guards, panels and /or fasteners except transport fixing bolts have been removed. Check the fill hose connections on a regular basis to ensure that they are tight and not leaking.
- Do not operate the washing machine if parts are missing or broken.
- Do not touch the door if washing at high temperatures.

Note:

- The Important Safeguards and Warnings indicated in this manual do not cover all possible conditions which may occur. Common sense, caution and care must be exercised when installing, maintaining or operating the washing machine.
- Always contact your dealer,distributor, service agent or the manufacturer about any problems or conditions that you do not understand.

## Installation Requirements

### Installation requirements



**WARNING**

- 1.This machine must be properly grounded. If there is any short circuit, grounding can reduce the danger of electrical shock.  
This machine is equipped with power cord, that has a grounding wire and terminal.
- 2.This appliance shall be operated in a circuit separate from other electrical appliances. Otherwise, power protector may be tripped or fuse may be burned out.

#### **WARNING – Risk of Fire**

Instillation of this appliance must be performed by a qualified installer.

Install the appliance according to the manufacturer's instructions and local codes.

Otherwise, air flow will be obstructed and increase the risk of fire.

To reduce the risk of severe injury or death, follow all installation instructions.

Save these instructions.

#### **Failure to comply with these warnings could result in serious personal injuries.** Note: Environmental Protection

- If you plan to dispose this machine, please comply with the local waste disposal regulations. Cut off the power cord so that it will not be put into reuse.  
Remove the door so that kids and animals will not be trapped in the machine.
- Do not use excessive detergents.
- Decontaminant and bleach can be used to pre-treat the stains on the clothes only when very necessary.

### Tools and parts

Gather the required tools and parts before starting installation. The parts in the right supplied are in the washer drum.

1/4" nut driver 3/8"socket with ratchet  
3/8" open–end wrench  
Adjustable wrench or 7/16" socket with ratchet  
Adjustable wrench or 9/16" open–end wrench  
Channel–lock adjustable pliers  
Carpenter's level

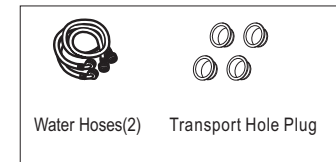

# Installation Requirements

## Location requirements

Selecting the proper location for your washer improves performance and minimizes noise and possible washer “walk.” Your washer can be installed under a custom counter, or in a basement, laundry room, closet, or recessed area. See “Drain System.” Companion appliance location requirements should also be considered. Proper installation is your responsibility.

You will need

1. A water heater set to deliver 111° F (44° C) –129° F (54° C) water to the washer.
2. A grounded electrical outlet located within 6 ft. (1.8 m) of where the power cord is attached to the back of the washer. See “Electrical Requirements.”
3. Hot and cold water faucets located within 4 ft. (1.2 m) of the hot and cold water fill valves, and water pressure of 20-100 psi (137.9–689. 6 kPa) .
4. A level floor with a maximum slope of 1" (25 mm) under entire washer. Installing the washer on soft floor surfaces, such as carpets or surfaces with foam backing is not recommended.
5. A sturdy and solid floor to support the washer with a total weight (water and load) of 200lbs.
6. Do not operate your washer in temperatures below 32° F (0° C) . Some water can remain in the washer and can cause damage in low temperatures.

## Installation clearances

1. The location must be large enough to allow the washer door to be fully opened.
2. Additional spacing should be considered for ease of installation and servicing. The door opens more than 90° and it is not reversible.
3. Additional clearances might be required for wall, door, and floor moldings.
4. Additional spacing of 25mm (1") on all sides of the washer is recommended to reduce noise transfer.
5. Companion appliance spacing should also be considered.

## Electrical requirements

### ⚠ WARNING



#### Electrical Shock Harzard

Connect to grounded 3 prong outlet with an individual 15 or 20 amp branch circuit protected by a 15 or 20 amp circuit breaker. Connect to individual branch circuit.  
Do not remove ground prong.  
Do not use an adapter.  
Do not use an extension cord.  
Failure to follow these instructions can result in electrical shock, fire, or death.

# Installation Requirements

## Electrical requirements

1. A 120V~.60Hz, AC only, 15-or 20amp, fused electrical supply is required. A time-delay fuse or circuit serving only this appliance be provided .
2. This washer is equipped with a power supply cord having a 3 prong grounding plug.
3. To minimize possible shock hazard ,the cord must be plugged into a mating, 3 prong, grounding type outlet, grounded in accordance with local codes and ordinances. If a mating outlet is not available, it is the personal responsibility and obligation of the customer to have the properly grounded outlet installed by a qualified electrician.
4. If codes permit and a separate ground wire is used, it is recommended that a qualified electrician determine that the ground path is adequate.
5. Do not ground to a gas pipe .
6. Check with a qualified electrician if you are not sure the washer is properly grounded.
7. Do not have a fuse in the neutral or ground circuit.

## Washer dimensions

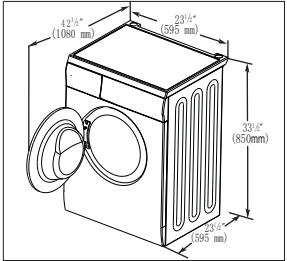

The dimensions shown are for the recommended spacing.

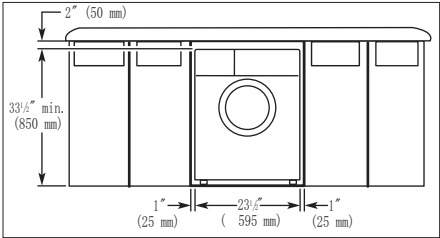

## Unpacking the washing machine

Unpack your washing machine and check if there are any damages during transportation. Also make sure that all the items (water hoses and transport hole plug) in the attached bag are received. If there is any damage to the washing machine during transportation, or any item is missing, please contact the local dealer immediately.

## Installation Instructions

### Dispose the packing materials

The packing materials of this machine may be dangerous to kids. Please dispose them properly and avoid easy access by kids or pets. Please dispose the related packing materials according to the relevant local regulations.

### Remove transport bolts and foam

Before using this washing machine, transport bolts must be removed from the backside of this machine. Please take the following steps to remove the bolts:

1. Loosen all bolts with 7/16" socket to remove bolt 13mm.
2. Cover the holes with transport hole plugs.
3. Keep the transport bolts properly for future use.

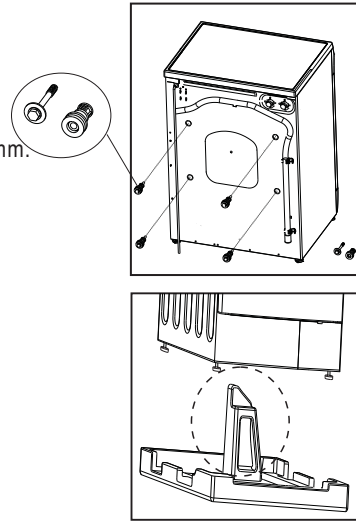

Make sure the small triangle foam is removed with the bottom one together. If not, lay the unit down with side surface, then remove the small foam from the bottom of the unit manually.

### Select the location

Before installing the washing machine, the location characterized as follows shall be selected:

- Rigid, dry, and level surface (if not level, please make it level with reference to the following figure "Adjust Leg")
- Sufficient ventilation
- Room temperature is above 32
- Keep far away from the heat sources such as coal or gas.
- Make sure that the washing machine is not on the power cord.
- Do not install the washing machine on the carpet floor.

### Connect inlet hose

Connect the inlet pipe as indicated in the figure.  
For the model which has hot valve, please connect the hot valve to hot water tap.

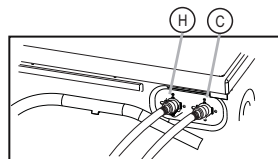

## Installation Instructions

### Install inlet pipe

1. Connect the inlet hose to tap and tighten by turning clockwise.
2. Connect the other end of inlet hose to the inlet valve at the backside of washing machine and tighten by turning clockwise.

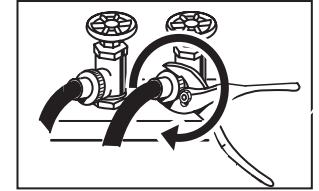

Note: Please use a standard tap. If there is any leakage after connection, repeat the steps to connect the inlet hose.

### Drain system options

Standpipe drain system – wall or floor (views A & B)  
The standpipe drain requires a minimum diameter standpipe of 2" (50 mm).

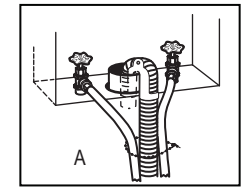

Capacity can be no less than 17 gal. (64 L) per minute.  
The top of the standpipe must be at least 60cm(23.6") high and no higher than 100cm (39.4") from the bottom of the washer.

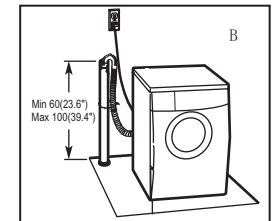

Laundry tub drain system (view C)

The laundry tub needs a minimum 20 gal. (76 L) capacity. The top of the laundry tub must be at least 60cm(23.6") above the floor.

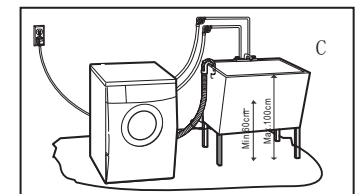

Floor drain system (view D). The floor drain system requires a siphon break that may be purchased separately.  
The siphon break must be a minimum of 28"(710 mm) from the bottom of the washer. Additional hoses might be needed.

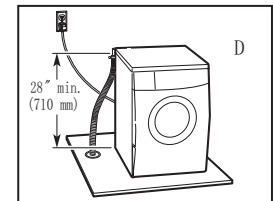



## Installation Instructions

### Level the washer

1. When positioning the washing machine, please first check if the legs are closely attached to the cabinet. If not, please turn them to their original positions with hand or spanner and tighten the nuts with spanner.
2. After positioning the washing machine, press four corners on top cover of washing machine in sequence. If the washing machine is not stable when being pressed, this leg shall be adjusted.

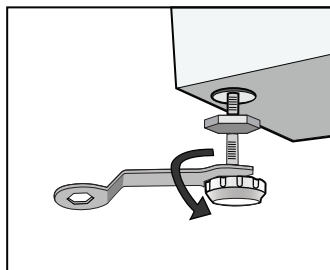

3. Ensure the positioning status of washing machine.

Loosen the lock nut with spanner and turn the leg with hand until it closely contacts with the floor. Press the leg with one hand and fasten the nut closely to the cabinet with the other hand.

4. After being locked properly, press four corners again to make sure that they have been adjusted properly. If it is still unstable, repeat Steps 2 and 3

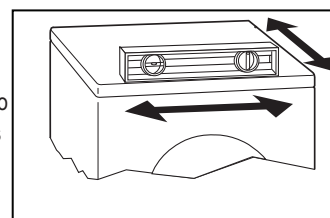

5. Put a solid cylinder (e.g. pop cans) oppositely on the top cover of the washing machine from in the left, right, front and back directions. If the cylinder keeps stable, the washing machine is positioned level. If it rolls, the washing machine is not leveled. The rolling direction is the direction of lower ground surface. Then the two legs in this direction shall be raised at the same time until the washing machine is level. Steps 1~3 are repeated to make the bottom legs closely against the ground and the nuts shall be locked tightly.

### Electrical connection

- As the maximum current through the unit is 12A when you are using its heating function, please make sure the power supply system (current, power voltage and wire) at your home can meet the normal loading requirements of the electrical appliances.
- Please connect the power to a socket which is correctly installed and properly grounded.
- Make sure power and voltage at install location is same to that in the machine's rating label.
- Power plug must match the socket and chassis must be properly and effectively grounded.
- Do not use multi-purpose plug or socket as extension cord.
- Do not connect and pull out plug with wet hand.
- When connecting and pulling out the plug, hold the plug tightly and then pull it out. Do not pull power cord forcibly.
- If power cord is damaged or has any sign of being broken, a new power cord must be selected or purchased from its manufacturer or service center for replacement.

## Operating Instructions

### Operating instructions



**WARNING** – To reduce the risk of fire, electric shock, or injury to persons, read the **IMPORTANT SAFETY INSTRUCTIONS** before operating this appliance.

### Checklist and preparation before washing clothes

Please read Operating Instructions carefully to avoid issues with the washing machine and garment damages.

#### Check if the first-washed clothes will be discolored.

After placing a small amount of liquid detergent on a white towel rub the towel against a hidden corner of the garment to see if it will discolor.

As for the scarves and those clothes that easily get discolored among imported clothes, please wash them separately.

As for the stains on sleeves, collars and pockets, use the liquid detergent and a brush to spot clean.

Finally load the clothes in the washing machine to achieve ideal washing effects.

As for temperature-sensitive clothes, follow the garment manufacturers recommended cleaning instructions.

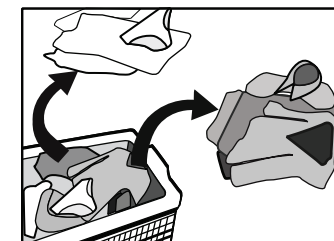

#### Keep in Mind:

Never leave clothes to be washed in washing machine for a long period of time.

This may cause mold and spotting.

clothes may also discolor or be damaged if the clothing manufacturer's cleaning instructions are not followed.

#### Clothes that cannot be washed by washing machine

The clothes that may get distorted if being immersed in water:

Ties, waistcoats, outer garments etc. may have shrinkage if being immersed in water; the discolored clothes such as blended spinning clothes of artificial fiber etc.



## Operating Instructions

### Checklist and preparation before washing clothes

Embossed clothes, resin clothes etc. may get distorted when being submerged in water. Fabrics such as: cotton, wrinkle-style silk, fur products and fur decorations.

Clothes with decoration, long dress and traditional clothes etc are products that gets discolored easily.

Please do not wash clothes without material labels and washing requirements.

Never wash clothes stained with chemicals such as gasoline, petroleum, benzene, paint thinner or alcohol.

#### Please pay attention with regard to detergents

"High efficiency HE " detergent or powder detergentspecial for drum washing machine shall be selected according to fiber types (cotton, synthetic fiber, soft products and wool products), colors, washing temperatures, soil level and types. Otherwise, excessive bubbles may be generated and overflow. may take place.

Bleach can damage clothes, so it is suggested to follow manufacturer's recommendations.

Powder detergents can easily leave the residues in the clothes that can generate a bad smell, and needs to be sufficiently rinsed.

Detergent may not be dissolved completely if there is too much detergent or water temperature is rather low. It can remain in clothes, pipes and washing machines to pollute the clothes.

Washing shall follow the weight of clothes, soil level, local water hardness as well as the recommendations from the detergent's manufacturer. Please consult the water company if you are not clear of water hardness.

#### Note:

Keep detergents and additives in safe and dry places out of reach to kids.

#### Please take out contents of the pockets.

Please check the pockets of the clothes to be washed, empty the rigid items such as decorations and coins, otherwise the washing machine may be damaged.

#### For the clothes to be washed, they are classified according to the following characteristics:

The symbol types of care labels: the clothes to be washed are classified into cotton, blended fiber, synthetic fiber, silk, wool and artificial fiber.

Color: white and other colors shall be identified. All new colored articles shall be washed in a separate load.

## Operating Instructions

### Checklist and preparation before washing clothes

Size: the articles of different sizes are washed together to increase the washing effects.

Sensitivity: soft articles shall be washed separately. As for new pure wool textiles, curtains and silks, delicate cycle shall be selected. Check the labels in all washing articles.

The clothes shall be sorted before being put into washing machine. As for the curtains with hooks, the hooks shall be removed before being washed.

The decorations on the clothes may damage the washing machine. As for the clothes with buttons or embroideries, they shall be turned over before being washed.

#### Clean up fasteners:

Zips shall be zipped closed and buttons or hooks shall be fixed. The loose band or ribbon shall be bound together.



#### WARNING

It is suggested to put bras into the pillow case with zip or buttons sealed to prevent the steel wire from popping out of bras into the drum and damaging the machine.

Delicate textiles such as laced curtains, straightjackets, small articles (tight socks, handkerchiefs, ties etc.) shall be put into string bag for washing.

When washing a single big and heavy clothing such as jeans, padded jackets, weighted jackets etc., it may easily cause the washing machine to go out of balance and give an error code .

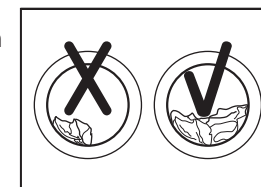
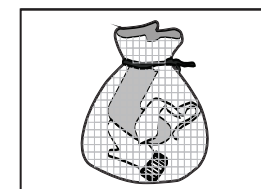

#### Clean away dusts, stains and pet hairs from the clothes.

The clothes may be damaged and disturb washing effects during the friction between dusts, stains and clothes.

#### To protect baby skin

Baby articles (baby clothes and towels) including napkins shall be washed separately.

Rinsing times shall be increased to ensure the thorough rinsing and cleaning without the detergent residues.

**It is suggested that the parts that are easily stained such as white socks, collars and sleeves etc. shall be hand washed before being put into washing machine to achieve ideal washing effects.**

Please use powder or liquid detergents. The residues of the soap could remain in the gaps of the clothes if soap is used.

# Operating Instructions

## Checklist and preparation before washing clothes

### The clothes which easily get pill shall be turned over for washing

The clothes which easily get pill shall be washed separately; otherwise the other articles can be stained with dust and thread residue etc. Preferably, black clothes and cotton clothes shall be washed separately because they can easily get stained with the thread residue of other colors when being washed together.  
Please check before washing.

### Washing machine shall not wash water-proof materials (ski suits, outside napkin pads, curtains).

As for the fiber products that water can not get soaked easily into such as water-proof cushions, and clothes, it is better not to wash. Otherwise there will be water bursting out or abnormal vibration to cause danger while rinsing and draining so that the clothes also may be damaged. (Such as outside napkin pads, raincoats, umbrella, ski suits, car covers, sleeping sacks etc.)

### Cautions during Draining

Draining of water-proof clothes and fiber products:  
In the normal washing and draining status, moistures of water-proof clothes and fiber products may not be drained causing the machine to go out of balance and excessive vibration.

# Operating Instructions

## View of control panel

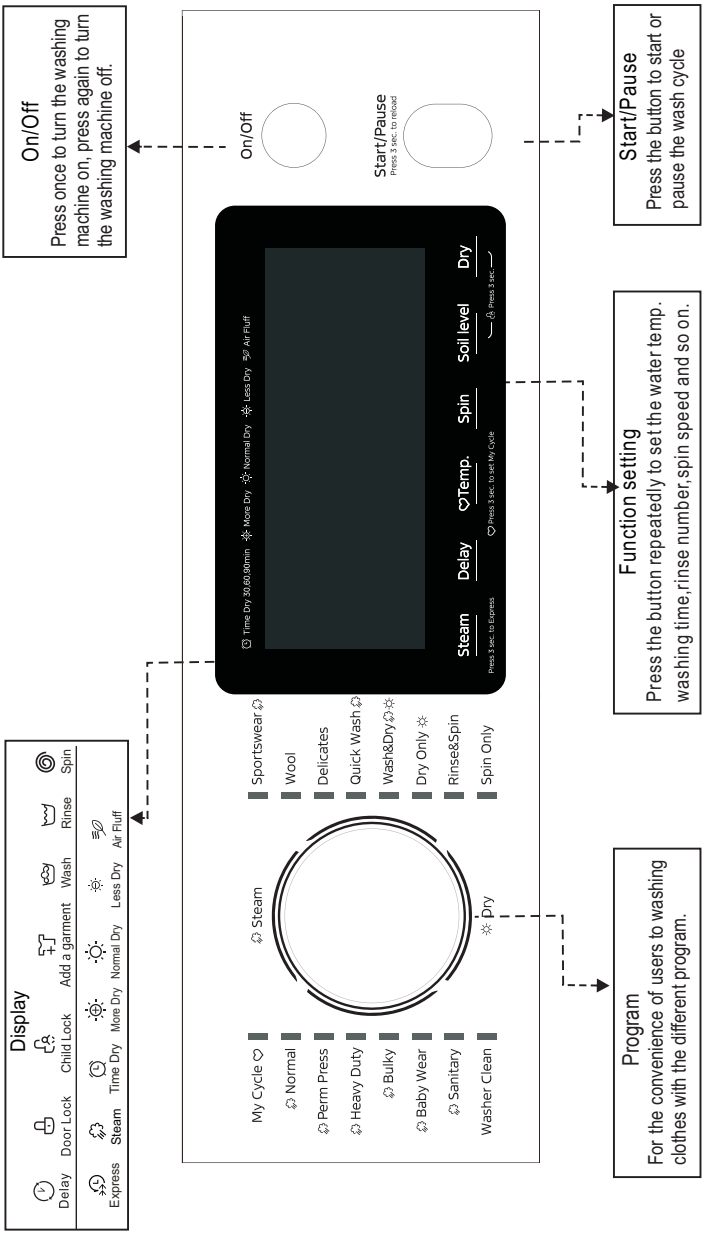

**Notes:** 1. The Control panel line chart is for reference only, Please refer to real product as standard.  
2. The Control panel could be changed without written notice. Please visit the website of Washing Machine or call up the service line for consultation.

## Operating Instructions

### List of programs / wash cycles

#### - Normal

Hard-wearing textiles, heat-resistant textiles made of cotton or linen.

#### - Heavy Duty

This program is intended for washing heavy clothing like towels.

#### - Bulky

This program is intended for washing large clothing .

#### - Sports Wear

Washing the activewear.

#### - Spin Only

Extra spin with adjustable spin speed.

#### - Rinse & Spin

Extra rinse with spin.

#### - Washer Clean

This program is specially set in this machine to clean the drum and tube. It applies high temperature sterilization to make the clothes washing more green. When this procedure is performed, the clothes or other washing cannot be added. When proper amount of chlorine bleaching agent is put in, the cleaning effect will be improved. The customer can use this procedure regularly to clean as needed.

#### - Quick Wash

Extra short program approx, suitable for lightly soiled washing as a small amounts of laundry.

#### - Delicates

For delicate, washable textiles, e.g. made of silk, satin, synthetic fibres or blended fabrics.

#### - Sanitary

Give full play to its active enzyme washing powder, with Ex. hot wash and Ex. heavy soil level, suitable for difficult to wash the clothes.

#### - Wool

You can select this procedure to wash wool textiles labeled with "Machine Wash".

Please select the proper washing temperature according to the label on the articles to be washed. Furthermore, the proper detergent shall be selected for wool textiles.

#### - Perm Press

Moderate strength of washing. This function can be used to reduce the wrinkles of clothes.

#### - Baby Wear

Washing the baby's clothes, it can make the baby's wear cleaner and make the rinse performance better to protect the baby skin.

#### - Dry Only

Select it to dry clothes, the temperature is different .The drying time according to the load.

#### - My Cycle

Press Temp. 3sec. to set My Cycle to memory the program.

#### - Wash&Dry

Select it to wash and dry clothes. For hard-wearing textiles, heat-resistant textiles made of cotton or linen.

## Operating Instructions

### View of control panel

#### The Special function

##### - Child Lock

To avoid children operating the unit, the child lock feature can be turned on. To turn on the child lock feature: press the soil level and dry buttons together for three seconds. The other buttons except On/Off button will not work, at this state, the machine power off when you press the key on/off.

Press Soil level and Dry together 3 seconds during the running procedure, the buzzer will beep, Start/Pause button as well as the rotary switch are locked. Press the two buttons for 3 seconds together and buzzer will beep to release to locking.

##### - Delay

Delay function can be set with this button, the delaying time is 0-24h.

Set the delay function:

- 1.Select a program;
- 2.Press the Delay button to choose the time;
- 3.Press Start/Pause to commence the Delay operation.

Cancel the Delay function :

Press the Delay button until the display will be 0h . It should be pressed before starting the program. If the program already started, should press the On/Off button.

Notes: If there is any break in the power supply while the machine is operating, a special memory stores the selected program and when the power is restarted, press the Start/Pause button the left time is continues.

##### - Reload

This operation can be executed during the washing procedure. When the drum of the washer (dryer) machine is still rolling and there is large amount of water with high temperature in the drum. The state is unsafe and the door cannot be opened forcefully. To press "Start/Pause"for 3 sec. to reload, and start the clothes adding in the midway function .

Please follow the steps as bellow:

- 1.Wait until the drum stops rotation.
- 2.The door lock is unlocked.
- 3.Close the door when the clothes needs are loaded and repress the "Start/Pause"button.

Notes: Don't use the Reload function when the water surface over the edge of the inner tub and the temperature is higher.

## Operating Instructions

### View of control panel

#### - Express

Press Steam 3 seconds to select Express function.

This option reduces the overall washer cycle time by optimizing the wash, rinse and spin actions and/or gently raising the wash temperature to get clothes cleaned faster. Option is available on Normal, Perm press, Heavy Duty, Bulky, Sports wear cycles. Total wash time will vary based on cycle chosen and options selected.

#### - Dry

Press the Dry button continuously to choose the dry level: Time Dry 30,60,90min /More Dry / Normal Dry/ Less Dry/ Air Fluff.

🕒 Time Dry 30,60,90min : Drying your laundry and finish within given time. (30/60/90 minutes)

☼ More Dry : This level leaves the clothes completely dry and ready to use.

☼ Normal Dry : This level leaves the clothes ready to fold and store in the wardrobe.

☼ Less Dry : This level leaves the cloths with some humidity. Perfect for ironing.

🌀 Air Fluff : To prevent wrinkles. Drum will rotate every half hour and stop half hour, shaking up the clothes to avoid laundry left in washing machine. The fan will also circulate air through the washer to prevent odors and keep clothes scent fresh. This function lasts for up to 8 hours.

#### Note!

- Drying hints
  - Thoroughly spin you laundry before drying.
  - To ensure proper drying, please sort your laundry according to the fabric type and drying temperature.
  - Synthstic should be set the proper drying time.
- Clothes not suitable for drying
  - Particularly delicate items such as synthetic curtains, woolen and silk, clothes with metal inserts, nylon stockings, bulky clothes, such as jackets, bedcovers, quilts, sleeping bags and duvets must not be dried.
  - Clothes padded with foam-rubber or materials similar to foam-rubber must not be machine dried.
  - Fabrics containing residues of setting lotions or hair sprays, nail solvents or similar solutions must not be machine dried in order to avoid the formation of harmful vapours.

## Operating Instructions

### View of control panel

#### - My Cycle

To save a favorite cycle, set the desired setting for wash cycle, soil level, spin speed and wash temp settings and hold down the My Cycle button for 3 seconds, A beep will sound to indicate the cycle has been saved.

To use your custom cycle, press the My Cycle button before washing a load.

To change the saved cycle, set the desired setting and hold down the My cycle button for 3 seconds.

#### NOTE:

When using My cycle, wash options cannot be modified after the cycle has been started.

#### NOTE:

If you change wash options with My Cycle before starting the cycle, the My Cycle light will turn off and you will be returned to the base cycle.

#### -Steam

SteamCare is the function added before main wash, which will generate warm steam to to sterilize and give performance especially for cold wash.

#### -Soil level

The default level is different for the program, choose the soil level according to needs.

#### -Temp.

When needed, the washing temperature can be adjusted by pressing the temperature button in the following steps: Tap Cold - Cold - Warm - Hot - Ex. hot.

#### -Spin

Press the button to change the spin speed.

### Washing clothes at first time

Before washing clothes at first time, the washing machine shall be operated in one round of the whole procedures without clothes in as follows:

- 1.Connect power source and water.
- 2.Put a little detergent into the box and close it.
- 3.Press the button "On/off".
- 4.Press the button "Start/Pause".

## Operating Instructions

### Washing clothes at first time

The drawer is separated as follows:

I/II: Detergent or washing powder.

☼ : washing additive, such as fabric softener .

#### Put detergent into washing machine.

- 1.Pull out the drawer.
- 2.Fill detergent into Case I/II.
- 3.Fill softener into Case ☼ (when necessary).

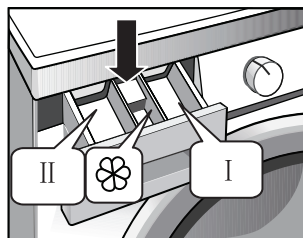

Notes:

- As for the powder detergent or liquid detergent or additive, before they are poured into the detergent box, it is suggested to use some water for dilution to prevent the inlet of detergent box from being blocked and overflowing while filling water.
- Please choose suitable type of detergent for the various washing temperature to get the best washing effect with less water and energy consumption.

### Start up washing machine

Connect the power. Check if water pipes are connected properly. Open the tap completely. Put in the clothes to be washed and fill in the detergent and tackifier. Then press the button "Power", Select the proper procedures and functions and press the button "Start/Pause".

### Select the procedure

The proper washing procedures shall be selected according to the types, quantities, and soil level of the clothes to be washed in combination with the following washing temperature table.

Tap Cold	Cold water with no warm water added.
Cold	Brightly colored, very lightly soiled items.
Warm	Normal soil level articles (including synthetic and wool)
Hot	Moderate soil level, colorful flax, cotton and synthetic articles with certain discolored degree (for example: shirts, night pajamas; slight soil level, pure white flax (for example: underwear)
Ex.hot	High soil level, pure white cotton or flax (for example: coffee table cloths, canteen table cloths, towels, bed sheets)

## Operating Instructions

### Table of washing procedures

Programme	Washing/ Drying Load(kg)	Temp.(°C)	Default Time(h)	Steam	Express	Delay	Soil Level	Spin Speed
	12.0	Default	12.0 1400 rpm					
My Cycle	—	—	—	—	—	○	—	—
☼ Normal	12.0	Warm	1:04	○	○	○	Normal	Med
☼ Perm Press	6.0	Warm	0:57	○	○	○	Normal	High
☼ Heavy Duty	12.0	Hot	1:40	○	○	○	Ex.heavy	High
☼ Bulky	6.0	Cold	1:23	○	○	○	Normal	High
☼ Sports Wear	6.0	Warm	0:57	○	○	○	Ex.heavy	Ex.light
Spin Only	12.0	—	0:13	—	—	○	—	High
Rinse & Spin	12.0	—	0:23	—	—	○	—	High
Washer Clean	—	Ex. hot	1:28	—	—	○	—	—
☼ ☼ Wash&Dry	6.0	Warm	5:43	○	—	○	Normal	Ex.light
☼ Dry Only	6.0	—	4:19	—	—	○	—	Ex.light
☼ Sanitary	6.0	Ex. hot	2:18	○	—	○	Ex.heavy	High
☼ Baby Wear	12.0	Hot	1:37	○	—	○	Normal	High
Wool	2.0	Cold	1:01	—	—	○	Normal	Med
Delicates	2.5	Cold	0:58	—	—	○	Normal	Med
☼ Quick Wash	2.0	Tap cold	0:36	○	—	○	Ex.light	High

● Means must ○ Means optional

Energy test program: Normal.

"Normal" is the standard washing programs to which the information in the label and the fiche relates, and they are suitable to clean normally soiled cotton laundry and that they are the most efficient program in terms of combined energy and water consumptions for washing that type of cotton laundry, that the actual water temperature may differ from the declared cycle temperature.

### Note!

- The parameters in this table are only for user's reference. The actual parameters maybe different with the parameters in above mentioned table.
- The program with ☼ can be choose dry function.

## Care And Cleaning

### Care and cleaning

Before performing maintenance on the unit, disconnect power and turn off the water.



#### WARNING

- Solvents are forbidden to avoid that the washing machine is damaged, and toxic gases are generated or exploded.
- Do not spray the machine with water.
- It is forbidden that the detergents containing PCMX are used to clean the washing machine.
- Service Personnel- Do not contact the following parts while the appliance is energized in case of electric shock: Electrical value, Drain Pump, Door Lock, Dry Heater (Combo), Fan Motor (Combo).

### Cleaning and Maintenance of Washing Machine Cabinet

Proper maintenance on the washing machine can extend the life of the unit. The surface can be cleaned with diluted non-abrasive neutral detergents when necessary. If there is any water overflow, use the wet cloth to wipe it off immediately.

Notes: formic acid and its diluted solvents or equivalent are forbidden.

#### Clean Internal Drum

The rusts left inside the drum by the metal articles shall be removed immediately with chlorine-free detergents.

Never use steel wool.

#### Dispose a Frozen Washing Machine

When the temperature drops below zero and your washing machine gets frozen, you may:

1. Disconnect the power supply for the washing machine.
2. Wash the tap with warm water to loosen inlet pipe.
3. Take down inlet pipe and immerse it in warm water.
4. Pour warm water into washing drum and wait for 10 minutes.
5. Reconnect inlet pipe to the tap and check whether inlet and outlet are working normally.

Notes: when the washing machine is reused, make sure the ambient temperature is above 0 °C

#### Winterizing the unit

If your washing machine is located in the room where it can get frozen easily, please drain the remaining water inside drain pipe and inlet pipe thoroughly.

#### Remove the remaining water in inlet pipe:

1. Close the tap.
2. Screw off the inlet pipe from tap and put its end into the container.
3. Start up any procedure except single Wash or Drain procedure. Water will be drained out of inlet pipe if any for about 40 seconds.
4. Reconnect the inlet pipe to tap.

## Care And Cleaning

### Care and cleaning

#### Remove the remaining water in drain pump



#### WARNING

To avoid burning, it shall be done after the hot water inside the machine cools down.

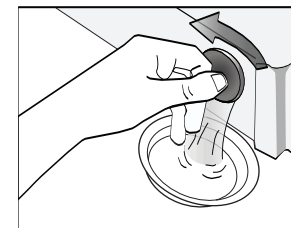

#### Clean detergent box and grooves

Clean detergent drawer and grooves

1. Press down the arrow location on softener cover inside the drawer.
2. Lift the clip up and take out softener cover and wash all grooves with water.
3. Restore the softener cover and push the drawer into position.

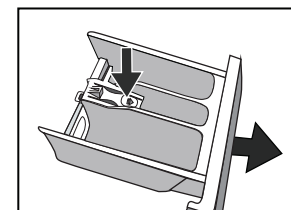

#### Clean inlet filter

Inlet filter shall must be cleaned if there is not any or insufficient water in when the tap is opened.

#### Clean the tap filter:

1. Close the tap.
2. Select any procedure except "Wash" or "Drain" procedure.
3. Press the button "Start/Pause" and keep the procedure running for about 40 seconds.
4. Remove the inlet pipe from the tap.
5. Use water to wash the filter.
6. Reconnect the inlet pipe.

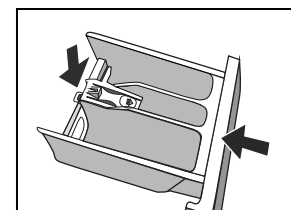
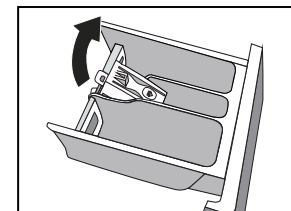

#### Washing the filter in washing machine:

1. Screw off the inlet pipe from the backside of the machine.
2. Pull out the filter with long nose pliers and reinstall it back after being washed.
3. Reconnect the inlet pipe.
4. Open the tap and make sure there is no water leakage.
5. Close the tap.

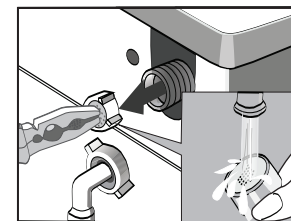



## Care And Cleaning

### Care and cleaning



Pull out the power plug to avoid electrical shock before washing.  
After using the washing machine, pull out the power cord and close the door

**WARNING** tightly to avoid pinching the kids.

#### Remove foreign matters

##### Drain Pump Filter:

Drain pump filter can filter the yarns and small foreign matters from the washings.  
Clean the filter periodically to ensure the normal operation of washing machine.



According to the soil level within the cycles and the frequency of the cycles, you have to inspect and clean the filter regularly.

The pump should be inspected if the machine does not empty and/or spin;

**WARNING** The machine makes an unusual noise during draining due to objects such as safety pins, coins etc. blocking the pump.

The Service panel proceed as follows:

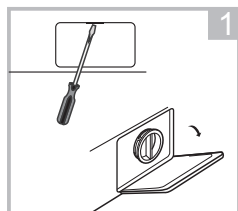

Open the cover filter use a flat blade screwdriver

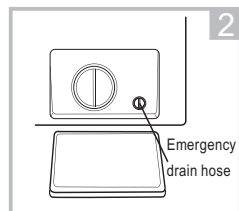

Rotate 90° and pull out the emergency drain hose, and take off the hose cap

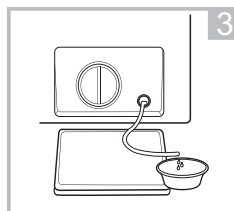

After water runs out, reset the drain hose

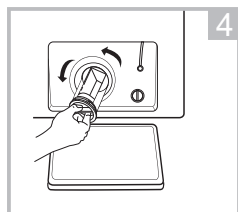

Open the filter by turning to the counter clockwise

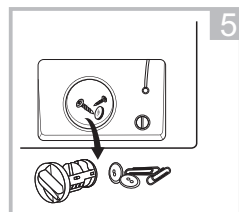

Remove extraneous matter

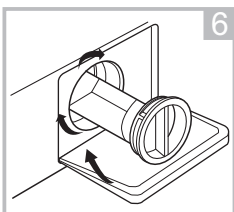

Close the lower cover cap

#### Warning!

When the appliance is in use and depending on the program selected there can be hot water in the pump. Never remove the pump cover during a wash cycle, always wait until the appliance has finished the cycle, and is empty. When replacing the cover, ensure it is securely retight end so.

## Care And Cleaning

### Care and cleaning

#### Emergency Door Release

In case of power failure or other circumstances and door cannot be opened, lower case i it is necessary to open the door under this circumstances, please pull down the pull cord inside emergency door and restore the pull cord after opening the door.

Emergency door pull cord

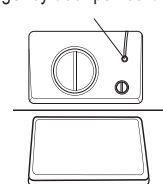

1.Open filter door

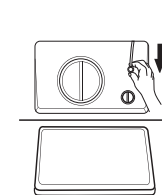

2.Emergency pull cord

#### Warning!

The machine is not allowed to use the emergency switch pull cord during washing. If need to run machine urgently, it is recommended to open door after water is cooled, to avoid getting burned caused by high temperature residual water outflow from the machine tub.



## Troubleshooting Tips

### Troubleshooting tips

Troubles	Reason	Solution
Washing machine cannot start up		Check if the door is closed tightly. Check if power plug is inserted well. Check if water supply tap is opened. Check if button "On/Off" is pressed. Check if button "Start/Pause" is pressed.
Door cannot be opened	Machine's safety protection design is working.	Disconnect the power.
Heating fault	Heating element defective.	Can normally wash the clothes. Only cannot wash with heating. Shall contact the service center promptly.
Water leakage	The connection between inlet pipe or outlet hose and tap or washing machine is not tight. Drain pipe in the room is blocked.	Check and fasten water pipes. Clean up outlet hose and ask a specialized person to repair it when necessary.
Water is overflowed from the bottom of the machine	The inlet pipe is not connected firmly. Outlet hose has water leakage.	Fix the inlet pipe. Replace the drain hose.
Indicator or display does not light.	Power is disconnected. PC board has problems. Harness has connection problem.	Check if the power is shut down and power plug is connected correctly. If not, please call up service line.
Detergent residues in the box	Washing powder is dampened and agglomerated.	Clean and wipe the box. Use liquid detergents or the detergents special for drum.
Washing effects are not good	The clothes are too dirty. Insufficient detergent quantity.	Select a proper procedure. Add the proper detergent quantity according to the instructions in detergent package.
Abnormal noise Great vibration		Check if the transportation bolts has been removed. If cabinet is installed on the solid and level floor. Check if there are any barrettes or metal articles inside. Check if the legs in the washing machine are adjusted level.

## Remove The Problems

### Remove the problems

The start of the appliance does not work or it stops during operation.  
First try to find a solution to the problem, If not, contact the service center.

Description	Reason	Solution
Washing machine cannot start up	Door is not closed properly	Restart after the door is closed Check if the clothes is stuck
Door can't be opened	Washer's safety protection design is working	Disconnect the power, restart the product
Water leakage	The connection between inlet pipe or outlet hose is not tight	Check and fasten water pipes Clean up outlet hose
Detergent residues in the box	Detergent is dampened or agglomerated	Clean and wipe the detergent box
Indicator or display does not light	Disconnect the power PC board or harness has connection problem	Check if the power is shut down and the power plug is connected correctly
Abnormal noise		Check if the fixing (bolts) have been removed Check it's installed on a solid and level floor

Description	Reason	Solution
E30	Door is not closed properly	Restart after the door is closed Check if the clothes is stuck
E10	Water injecting problem while washing	Check if the water pressure is too low Straighten the water pipe Check if the inlet valve filter is blocked
E21	Overtime water draining	Check if the drain hose is blocked
E12	Water overflow	Restart the washer
EXX	Others	Please try again first, call up service line if there are still troubles





















### Note!

- After the check, activate the appliance. If the problem occurs or the display shows other alarm codes again, contact the service center.

## Appendix

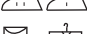
### Appendix

#### Care Lable

Graphic Symbol	Illustration	Graphic Symbol	Illustration
	Hand Wash		No Machine Wash
	Washing (including Machine Wash and Hand Wash)		Do not Wash
	Dry Clean		No Dry Clean
	Warmly Dry Clean		No Wring
	Bleach		No Bleach
	Tumble dry		Do not Tumble Dry
	Iron		Do not Iron
	Steam Iron		Iron with Cloth
	Medium Temperature and Max. Temperature 150°C		Dry after Wash
	Line Dry		Line Dry in Shade

To avoid fire, electrical shock and other accidents, please remember the following:



#### WARNING

- Only the voltage indicated in power label can be used. If you are not clear of the voltage at home, please contact the local power bureau.
- When you are using the heating function, the maximum current through the washing machine will reach 12A. Therefore, please make sure the power supply units (current, voltage and cable) can meet the normal load requirements for the machine.
- Protect the power cord properly. Power cord shall be fixed well so that it will not trip the people or other things and be damaged. Special attention shall be paid to the socket. It shall be plugged into the sockets easily and attention shall be paid to the plug location.
- Do not make the wall-mounted socket overloaded or cable extended. Overloading of the wiring may cause fire or electrical shock. Do not pull out power plug with wet hand.
- To ensure your safety, power plug shall be inserted into an earthed three-pole socket. Carefully check and ensure that your socket is properly and reliably earthed.

## Technical Specifications

### Technical specifications

Model:MLC27N3AWW

Parameter	
Power Supply	120V~ , 60Hz
Dimension(W*D*H)	595*640*850mm(23.4*25.2*33.5")
Net Weight	73kg (161lb)
Washing Capacity	12.0kg (26lb)
Rated Current	9.5A
Standard Water Pressure	0.05MPa~1MPa(7.25psi~145psi)

# MIDEA LAUNDRY DRYER LIMITED WARRANTY

## ATTACH YOUR RECEIPT HERE. PROOF OF PURCHASE IS REQUIRED TO OBTAIN WARRANTY SERVICE.

Please have the following information available when you call the Customer Service Center:

- Name, address and telephone number
- Model number and serial number
- A clear, detailed description of the problem
- Proof of purchase including dealer or retailer name and address

## IF YOU NEED SERVICE:

1. Before contacting us to arrange service, please determine whether your product requires repair. Some questions can be addressed without service. Please take a few minutes to review the Troubleshooting section of the User Manual, or email customerserviceusa@midea.com.
2. All warranty service is provided exclusively by our authorized Midea Service Providers, in the U.S. and Canada.

### Midea Customer Service

**In the U.S.A. or Canada, call 1-866-646-4332 or email customerserviceusa@midea.com.**

If outside the 50 States of the United States or Canada, contact your authorized Midea dealer to determine whether another warranty applies.

## LIMITED WARRANTY

### WHAT IS COVERED

#### FIRST YEAR LIMITED WARRANTY (PARTS AND LABOR)

For one year from the date of purchase, if this major appliance is installed, operated and maintained according to instructions attached to or furnished with the product, Midea America Corporation (hereafter "Midea") will pay for factory specified replacement parts and repair labor to correct defects in materials or workmanship that existed when this major appliance was purchased, or at its sole discretion replace the product. In the event of product replacement, your appliance will be warranted for the remaining term of the original unit's warranty period.

YOUR SOLE AND EXCLUSIVE REMEDY UNDER THIS LIMITED WARRANTY SHALL BE PRODUCT REPAIR OR REPLACEMENT AS PROVIDED HEREIN. Service must be provided by a Midea designated service company. This limited warranty is valid only in the 50 States of the United States or Canada and applies only when the major appliance is used in the country in which it was purchased. This limited warranty is effective from the date of original consumer purchase. Proof of original purchase date is required to obtain service under this limited warranty.

## LIMITED WARRANTY

### WHAT IS NOT COVERED

1. Commercial, non-residential or multiple-family use, or use inconsistent with published user, operator or installation instructions.
2. In-home Instruction on how to use your product.
3. Service to correct improper product maintenance or installation, installation not in accordance with electrical codes or correction of household electrical system (i.e. house wiring, fuses, etc.).
4. Consumable parts (i.e. light bulbs, batteries, air or water filters, etc.).
5. Defects or damage caused by the use of non-genuine Midea parts or accessories.
6. Damage from accident, misuse, abuse, fire, floods, electrical issues, acts of God or use with products not approved by Midea.
7. Repairs to parts or systems to correct product damage or defects caused by unauthorized service, alteration or modification of the appliance.
8. Cosmetic damage including scratches, dents, chips, and other damage to appliance finishes unless such damage results from defects in materials and workmanship and is reported to Midea within 30 days.
9. Routine maintenance of the product.
10. Products that were purchased "as is" or as refurbished products.
11. Products that have been transferred from its original owner.
12. Discoloration, rust or oxidation of surfaces resulting from caustic or corrosive environments including but not limited to high salt concentrations, high moisture or humidity or exposure to chemicals.
13. Pick-up or delivery. This product is intended for in-home repair.
14. Travel or transportation expenses for service in remote locations where an authorized Midea servicer is not available.
15. Removal or reinstallation of inaccessible appliances or built-in fixtures (i.e. trim, decorative panels, flooring, cabinetry, islands, countertops, drywall, etc.) that interfere with servicing, removal or replacement of the product.
16. Service or parts for appliances with original model/serial numbers removed, altered or not easily identified.

**The cost of repair or replacement under these excluded circumstances shall be borne by the customer.**

### DISCLAIMER OF IMPLIED WARRANTIES

IMPLIED WARRANTIES, INCLUDING ANY IMPLIED WARRANTY OF MERCHANTABILITY OR IMPLIED WARRANTY OF FITNESS FOR A PARTICULAR PURPOSE, ARE LIMITED TO ONE YEAR OR THE SHORTEST PERIOD ALLOWED BY LAW. Some states and provinces do not allow limitations on the duration of implied warranties of merchantability or fitness, so this limitation may not apply to you. This warranty gives you specific legal rights, and you also may have other rights that vary from state to state or province to province.

### DISCLAIMER OF REPRESENTATIONS OUTSIDE OF WARRANTY

Midea makes no representations about the quality, durability, or need for service or repair of this major appliance other than the representations contained in this warranty. If you want a longer or more comprehensive warranty than the limited warranty that comes with this major appliance, you should ask Midea or your retailer about buying an extended warranty.

### LIMITATION OF REMEDIES; EXCLUSION OF INCIDENTAL AND CONSEQUENTIAL DAMAGES

YOUR SOLE AND EXCLUSIVE REMEDY UNDER THIS LIMITED WARRANTY SHALL BE PRODUCT REPAIR AS PROVIDED HEREIN. MIDEA SHALL NOT BE LIABLE FOR INCIDENTAL OR CONSEQUENTIAL DAMAGES. Some states and provinces do not allow the exclusion or limitation of incidental or consequential damages, so these limitations and exclusions may not apply to you. This warranty gives you specific legal rights, and you also may have other rights that vary from state to state or province to province.

# Midea REGISTRATION INFORMATION

## PROTECT YOUR PRODUCT:

We will keep the model number and date of purchase of your new Midea product on file to help you refer to this information in the event of an insurance claim such as fire or theft.

Product registration is not mandatory. Failure to complete and return the card or form does not diminish the consumer's warranty rights.

Register online at **<https://us.midea.com/product-registration>**

*Please consider leaving a customer review at **[www.midea.com](http://www.midea.com)**.*

Midea America Corp.  
300 Kimball Drive, Suite 201,  
Parsippany, NJ 07054  
Customer Service 1-866-646-4332

Made in China