

Quick Start Guide

A285M

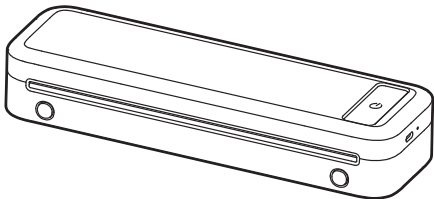

English

1.Product Introduction

1.1 Packing List



Printer×1



Quick Start Guide
×1

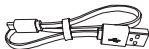

Type-C Cable×1



USB to Type-C
Adapter×1

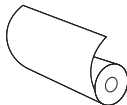

Paper Roll×1

❗ The paper roll has been placed inside the printer.

1.2 Printer Parts Instruction

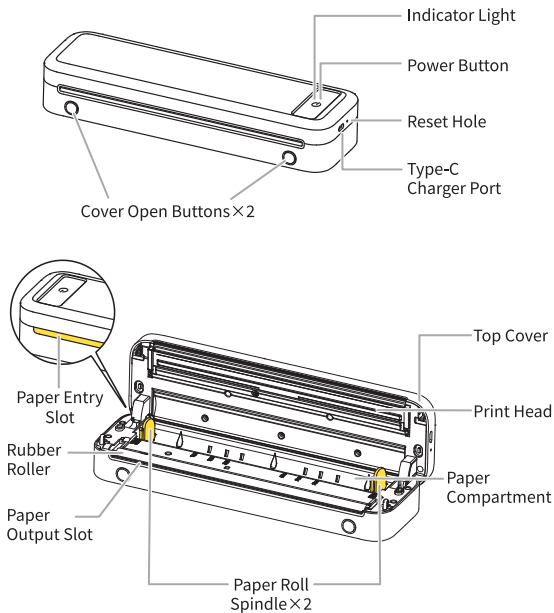

2. Getting Started

2.1 Downloading the App

Method 1: Search for the "Phomemo" app on App Store® or Google Play™ for download and installation.



Phomemo

Method 2: Scan the QR code to download the app.

You can scan the code using your cell phone's camera, the built-in QR code scanning feature of your browser, or a dedicated QR code scanning app.



Download on the
App Store



GET IT ON
Google Play



Phomemo



⚠ As the Safari browser on Apple devices does not support direct QR code scanning, please use your device's built-in QR code scanner instead.

2.2 Paper Installation Guide

- 01** Long press the Power Button for 3 seconds until the Indicator Light is green to power up the printer.

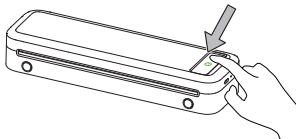

- 02** Press the cover open button with both hands and lift up the top cover.

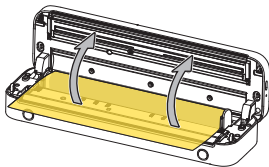

- 03** Remove the protective paper.

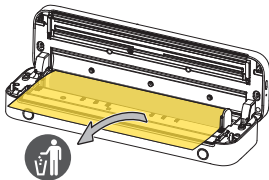

! Please skip this step if your printer does not contain a disposable protective sheet due to different models.

- 04** Unroll the paper roll inside the printer and pull the paper head out higher than the paper exit.

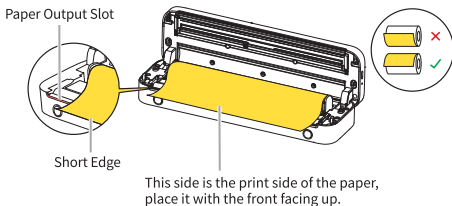

- 05** Put the Top Cover back down, and press down on both of its ends at the same time until you hear a click, indicating the cover is securely closed.

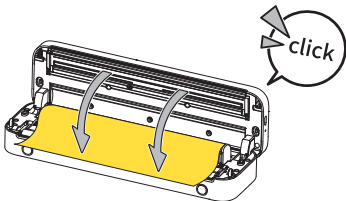

2.3 User Guide: Printing via Mobile App

01 Open the "Phomemo" app.



02 Grant permissions.

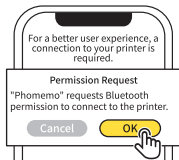

03 Wait for the printer to be searched.



04 Tap [Connect Now].

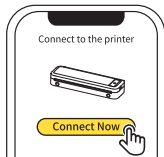

05 Connection successful. Please click [Print Image].

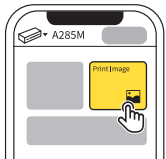

06 Edit your first image before clicking [Print].



! This is an example of printing an image. You can select other texts for printing based on your actual needs.

07 Confirm the preview effect of the image and then click [Print].

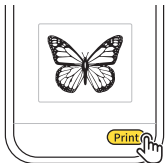

08 Printing is completed.



! The software interface is for reference only. Please refer to the actual operating page for accurate information.

2.4 User Guide: Printing via computer

- 01** Connect the printer to the computer using the original Type-C cable supplied with the printer.

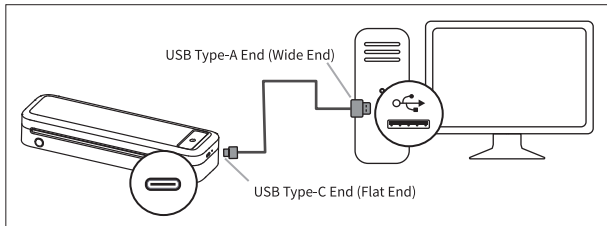

- ❗ • If your computer is Type-C interface, you can use the supplied adapter to convert the interface, the Type-C end of the adapter needs to be plugged into the computer side.
• The adapter is unidirectional, and the Type-C end of the adapter plugged into the printer end will fail to charge or fail to transfer data abnormally.

- 02** Visit a285m.labelife.cc to download and install the driver.

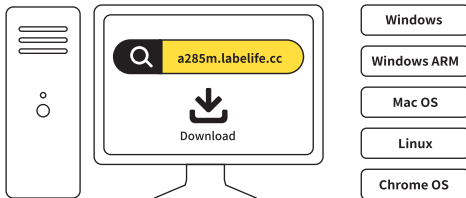

03 Select and open the file you need to print.

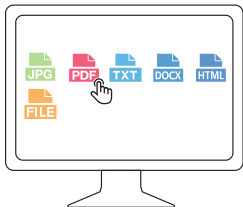

04 Tap [Print].

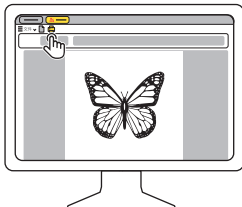

① The file formats supported by the printer include JPG, PDF, TXT, DOCX, HTML, FILE, etc.

05 Select the A285M Printer, and click [Print] to start printing.

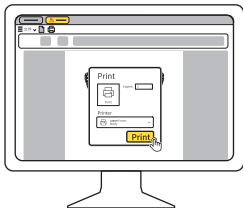

06 Tear open the printed paper.

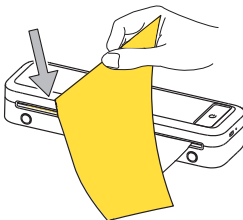

3. Paper types and usage instructions

3.1 Replace the Paper Roll

① The printer supports paper rolls with widths of 53mm, 80mm, 110mm, 210mm, and 216mm.

01 Take out a brand new paper roll.

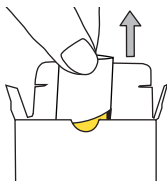

① Please skip this step if the paper roll you have is not newly purchased and boxed.

02 Long press the Power Button for 3 seconds until the Indicator Light is green to power up the printer.

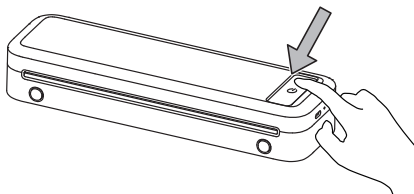

03 Press the cover open button with both hands and lift up the top cover.

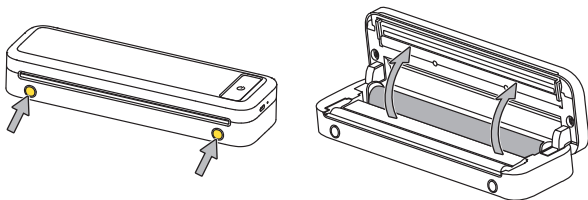

- 04 Remove the paper roll to be replaced.

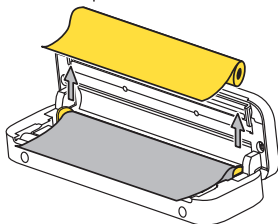

- 05 Gently pinch the top of the Paper Roll Stoppers and remove them.

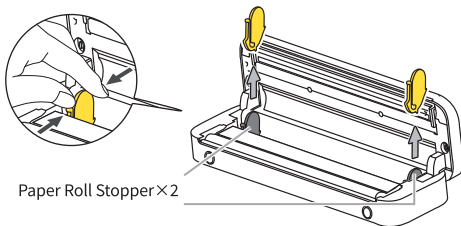

- 06 Please confirm the size of the Paper Roll to be replaced and place the Paper Roll Stoppers into the printer's Paper Compartment according to the illustration. When you hear a "click," the placement is completed.

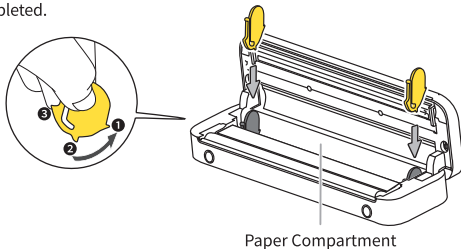

07 Unroll the Paper Roll.

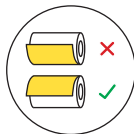
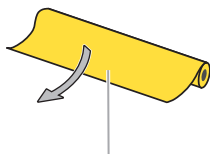

This side is the print side of the paper.
Please place it with the front facing up.

08 Please place the Paper Roll in the Paper Compartment of the printer.

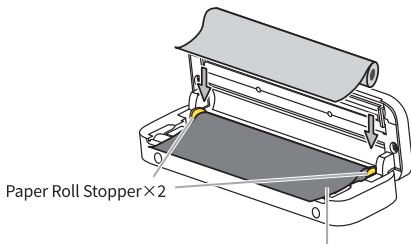

Make sure to place the Paper Roll
between the two Paper Roll Stoppers.

09 Pull the Paper Roll out until it extends beyond the Paper Output Slot, and then close the Flip Cover.

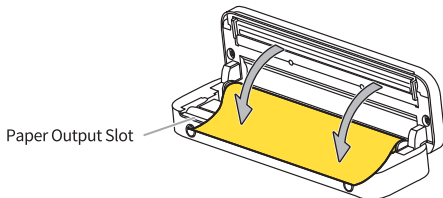

3.2 Instructions for using single-sheet thermal paper

- 01** Please confirm the Paper Roll inside the printer's paper Compartment is removed, and press and hold the power button for three seconds to turn on the printer.

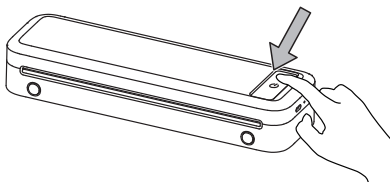

- 02** Take out a new sheet of thermal paper.

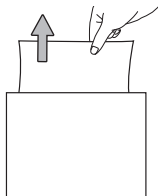

ⓘ If it is not a new individual thermal paper sheet (packaged separately), please disregard this step.

- 03** After the printer is turned on, please load the paper with the text side down in the Paper Entry Slot until the printer automatically pulls it in. When the indicator light turns green, it means the paper is successfully loaded.

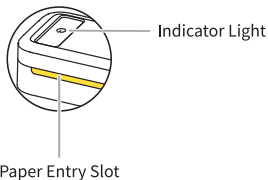
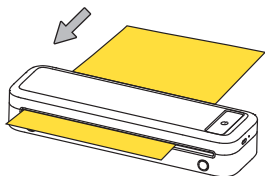





ⓘ The printed content will not appear on the side that reads "non-printing side"

4. Additional Instructions

4.1 Button Instructions

Button Type	Operation	Function
 Power Button	Long press for 3s	Power on/off
	Double press when printer is on	Print a self-test page

4.2 Indicator Light Instructions

Status	Meaning	Advised Action
 Solid Green Light	Functioning/Fully charged	/
 Flashing Green Light	Charging in progress	/
 Solid Red Light	No paper installed	Install paper
	Printer overheated	Pause printing for 5-10 min
	Top Cover open	Close Top Cover
 Flashing Red Light	Low battery	Charge battery for 1h (or at least 20 min for quick usage)
 No light indication after long pressing Power Button for 3s	Battery depleted	Charge for 4h

4.3 Permission Description

For iOS users

- 01 The app requires access to the Internet

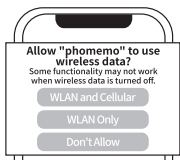

- 02 The app requires Bluetooth permission

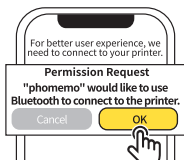

For Android users

- 01 The app requires Bluetooth permission

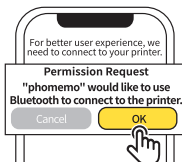

- 02 The app requires permission to search for nearby Bluetooth devices



! For Android 12 and above, the app requires permission to search for nearby Bluetooth devices; for systems below Android 12, the app requires GPS permission in order to search for nearby Bluetooth devices.

- 03 Bluetooth Pairing Request

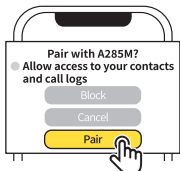

! You can simply tap "Pair" without checking "Allow access to your contacts and call history."

5. More Connection Methods

5.1 Connecting via QR Code

01 Open the “Phomemo” App.



02 Click [Connect] on the top.



03 Tap [Scan QR Code to Connect].

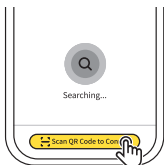

04 Double-click the power button to print the self-test page.

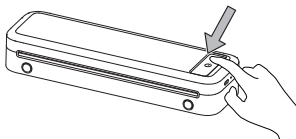

05 Scan the QR code on the self-test page.

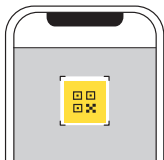

05 Device connected



5.2 Connecting via Bluetooth

01 Open the "Phomemo" app.



02 Click on the top [Connect].

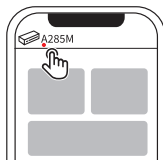

03 Go to Bluetooth Connections and search for the printer.



04 Select your printer

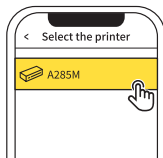

! Turn on Bluetooth permission to quickly find and connect to the printer.

05 Device connected



6. Cleaning and Maintenance

- ❗ • Please make sure the printer is turned off before performing any cleaning or maintenance.
- If you encounter issues such as blank lines, blurry print, or missing characters, it may be caused by dirt on the Print Head. Please follow these steps:

- 01 If you have just finished printing, wait for at least 30 minutes for the Print Head to cool down completely.
- 02 Use a cotton swab dipped in alcohol or a print head cleaning pen (purchased separately) to gently wipe the surface of the Print Head about 5 times to remove any dust and stains.
- 03 Wait 5-10 minutes for the alcohol to evaporate completely. Thus, the cleaning is done, and you can continue using the printer.

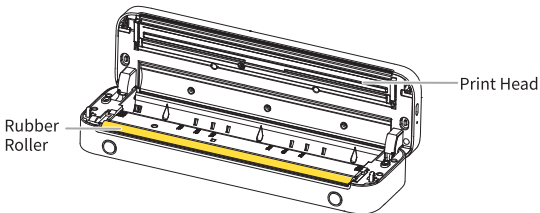

Print Head Warning: HOT component! Touching it when it is hot can cause burns to your fingers. Please wait for at least 30 minutes after turning off the power before touching it.

7. Charging Instructions

01. Please prepare your own power adapter (DC 5V \Rightarrow 2A) with a Type-A port.
02. Insert the Type-C end (flat end) of the USB cable into A285M's Type-C Charger Port and plug the Type-A end (wide end) into the Type-A port of the power adapter.
03. After completing the connection and plugging into the socket, please check the status of the printer indicator lights. In the charging state, the indicator light will flash green.
04. To ensure quick usage, please charge the printer for at least 20 minutes. For a complete charge, wait for 4 hours or until the Indicator Light is solid green.
05. As the printer may heat up during charging, avoid placing it on materials such as cotton or linen.
06. Once the battery is fully charged, please unplug the charger promptly.

- ❗ • Avoid using the printer while charging.
- Using the printer while charging may lead to reduced charging speed, compromised print quality, and shortened battery life.

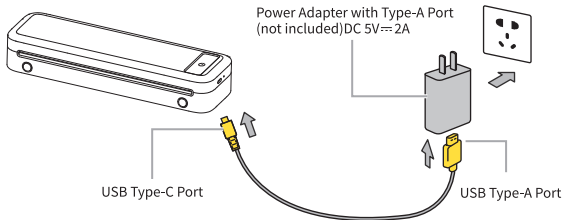

8. Information to User

8.1 FCC WARNING

Note: This equipment has been tested and found to comply with the limits for a Class B digital device, pursuant to part 15 of the FCC Rules. These limits are designed to provide reasonable protection against harmful interference in a residential installation. This equipment generates, uses and can radiate radio frequency energy and, if not installed and used in accordance with the instructions, may cause harmful interference to radio communications. However, there is no guarantee that interference will not occur in a particular installation. If this equipment does cause harmful interference to radio or television reception, which can be determined by turning the equipment off and on, the user is encouraged to try to correct the interference by one or more of the following measures:

- Reorient or relocate the receiving antenna.
- Increase the separation between the equipment and receiver.
- Connect the equipment into an outlet on a circuit different from that to which the receiver is connected.
- Consult the dealer or an experienced radio/TV technician for help.

Important: Change or modifications not expressly approved by the manufacturer responsible for compliance could void the user's authority to operate the equipment.

8.2 ISSED NOTICE (Canada)

- English:

This device contains licence-exempt transmitter(s)/receiver(s) that comply with Innovation, Science and Economic Development Canada's licence-exempt RSS(s). Operation is subject to the following two conditions:

- (1) This device may not cause interference.
- (2) This device must accept any interference, including interference that may cause undesired operation of the device.

IC RF exposure statement:

The device has been evaluated to meet general IC RF exposure requirement. The device can be used in portable exposure condition without restriction.

- French:

L' émetteur/récepteur exempt de licence contenu dans le présent appareil est conforme aux CNR d' Innovation, Sciences et Développement économique Canada applicables aux appareils radio exempts de licence. L' exploitation est autorisée aux deux conditions suivantes :

- 1) L' appareil ne doit pas produire de brouillage;
- 2) L' appareil doit accepter tout brouillage radioélectrique subi, même si le brouillage est susceptible d' en compromettre le fonctionnement

IC Déclaration d'exposition aux RF:

L'appareil a été évalué pour répondre aux exigences générales d'exposition aux RF d'IC. L'appareil peut être utilisé dans des conditions d'exposition portable sans restriction.

Special Notes

The company assumes full responsibility for the revision and explanation of this manual, exercising utmost diligence to guarantee its accuracy. Nevertheless, please note that any technical improvements to the product may not be separately notified, and that the images of the product, accessories, software interfaces, etc. in this manual serve solely as illustrations and references. Due to product updates and upgrades, the actual product may vary slightly from the images. Please refer to the physical product for accurate representations.