

Quick Start Guide

M08F

Itari A4
Portable Printer

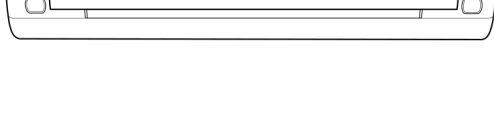

Before using, please read this manual carefully and keep it properly for future reference.

English

01. Package Contents

- ① Printer*1 ② Data Cable *1 ③ Flannel Bag*1 ④ Quick Start Guide*1



02. Printer Components

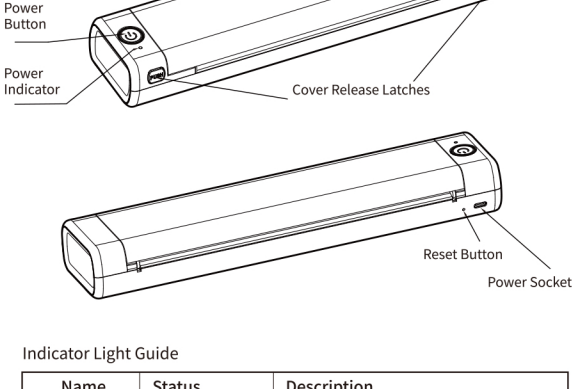

Indicator Light Guide

Name	Status	Description
Power Indicator	Lit (Red)	Out of paper/ Cover is open/ Overheat
	Blinking (Red)	Low power
	Lit (Green)	Normal
	Blinking (Green)	Charging

Button Function

(Power) Button Function	Operation
Turn on the printer	Press and hold the button for around 3 seconds until the power indicator light turns on.
Print QR code	Double-press the button to print QR code. You can scan the QR code using the App on the phone and connect to the printer.
Turn off the printer	Press and hold the button for around 3 seconds until the power indicator light turns off.

03. Precautions

- ① Please use 5V=2A input for charging, and it is recommended to use mobile phone power adapter for charging.
- ② Please connect the USB cable to the power adapter before charging, Please gently insert or unplug the charging cable when charging, to prevent excessive force from damaging the port.
- ③ After the charging is completed, please unplug the charging cable in time.
- ④ In order to avoid danger, do not use or charge in the environment of high temperature, high humidity, heavy smoke and dust, such as in bathroom, steam room, near to open flame, etc.
- ⑤ Improper charging may cause damage to the print head.
- ⑥ Do not touch the print head to prevent scalding caused by overheating.
- ⑦ The tearing blade is sharp, please be careful to avoid touching it by mistake.
- ⑧ If the machine is malfunctioning, insert the reset hole to restart the machine.

Battery warning instructions

- * It is forbidden to disassemble, hit, squeeze the battery, or throw it into fire;
- * If severe swelling occurs, please do not reuse it;
- * Do not place in a high temperature environment, and it is strictly prohibited to use the battery after soaking in water;
- * There is a danger of explosion if the battery is replaced by the wrong type. Be sure to dispose of used battery according to the instructions;
- * If consumers use a power adapter for power supply, they should purchase a power adapter that meets the requirements of corresponding safety standards or a power adapter with CCC certification.

04. Instruction Guide

4.1 Install App

Download the App
Please search for "Phomemo" on your phone's App market and download the App.

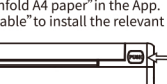
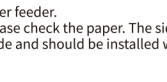
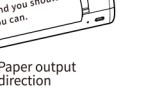

4.2 Install and change the printer's consumable

(1) Installing Consumable
Use two hands to hold the paper and make sure it is straight and aligned. Insert the paper carefully into the printer's feeder until the roller pulls the paper to its optimal position. To get the best printing quality, please use original Phomemo papers.

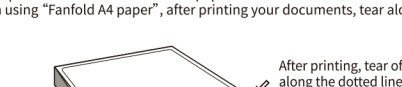

Note:

- ① The paper must be inserted aligned to the paper feeder.
- ② The paper can only be printed on one side, please check the paper. The side printed with "This side should face up" is the non-printable side and should be installed with that side faced up.

(2) Changing Consumable

- ① You can set the paper as "Single paper" or "Fanfold A4 paper" in the App.
- ② Refer to the instructions on "Installing Consumable" to install the relevant consumables.

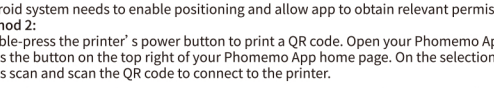

Note:

- ① When you need to take out the printing paper, press the PUSH buttons simultaneously to open the printer cover and take out the paper.
- ② When using "Fanfold A4 paper", after printing your documents, tear along the perforation lines.



4.3 Connect the printer to the App

Method 1:

Turn on your phone's Bluetooth and open your Phomemo App. Press the button on the top right of your Phomemo App home page and select M08F from the list.

Note:
Android system needs to enable positioning and allow app to obtain relevant permissions.

Method 2:

Double-press the printer's power button to print a QR code. Open your Phomemo App and press the button on the top right of your Phomemo App home page. On the selection page, press scan and scan the QR code to connect to the printer.

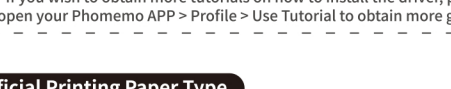

05. How to Download and Install Driver

Method 1:

Use the USB pendrive included in the package to obtain the latest driver. Download the relevant driver according to the your operating system version and follow the instruction to install the driver.

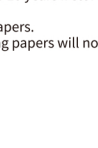
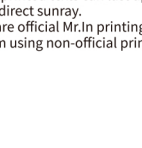

Method 2:

Download the latest driver from the official website. Download the relevant driver according to the your operating system version and follow the instruction to install the driver.

Official website: <https://phomemo.com/pages/download-center-m08f>

Download

- M08F App in Google Play
- M08F App in APP Store
- M08F PC Driver For Windows
- M08F PC Driver For MAC

NOTE · If you wish to obtain more tutorials on how to install the driver, please open your Phomemo APP > Profile > Use Tutorial to obtain more guidance.

06. Official Printing Paper Type

Normal thermal paper: Does not contain Bisphenol-A. The printed texts can last for 7 to 10 years if stored in a dry condition at room temperature without direct sunray.

Writable Quick-drying thermal paper: Thermal paper that does not contain Bisphenol-A, can be written on, and dries ink quickly. The printed texts can last up to 10 years if stored in a dry condition at room temperature without direct sunray.

*The printing papers mentioned above are official Mr.In printing papers.

*Any issues with your printer arising from using non-official printing papers will not be covered under our warranty policy.

07. After-sales Service

6.1 Warranty description

* Although the product has undergone strict testing and quality inspection, accidents may occur during transportation, resulting in damages to the machine. If there is any problem with the printer, please contact us through the following methods. We have a quick response after-sales team to solve the problem professionally.

* If the problem is still not solved through our joint efforts, we will replace you with a new machine for free, and you need not to pay any fees. Your satisfaction makes us advance.

6.2 After-sales information

OnlineContact information:

Whatsapp : +86 13928088284 / +86 15338193665

Skype : Phomemo Team-Jessie / Phomemo Team-Helen

Customer Service phone number: +1 855 957 5321(US only)

Service time: Mon-Fri 9AM-5PM (EST) for any questions & suggestions.

Email address:support@phomemo.com

Official Website:www.phomemo.com

YouTube Please search for "Phomemo" to get the printer operation guide

08. FCC Warning

This device complies with part 15 of the FCC Rules. Operation is subject to the following two conditions:(1) This device may not cause harmful interference, and (2) this device must accept any interference received, including interference that may cause undesired operation.

Any Changes or modifications not expressly approved by the party responsible for compliance could void the user's authority to operate the equipment.

This equipment has been tested and found to comply with the limits for a Class B digital device, pursuant to part 15 of the FCC Rules. These limits are designed to provide reasonable protection against harmful interference in a residential installation. This equipment generates uses and can radiate radio frequency energy and, if not installed and used in accordance with the instructions, may cause harmful interference to radio communications.

However, there is no guarantee that interference will not occur in a particular installation. If this equipment does cause harmful interference to radio or television reception, which can be determined by turning the equipment off and on, the user is encouraged to try to correct the interference by one or more of the following measures:

- Reorient or relocate the receiving antenna.
- Increase the separation between the equipment and receiver.
- Connect the equipment into an outlet on a circuit different from that to which the receiver is connected.
- Consult the dealer or an experienced radio/TV technician for help.

The device has been evaluated to meet general RF exposure requirement. The device can be used in portable exposure condition without restriction.

09. Warranty Card

- ☐ Return ☐ Exchange ☐ Repair

User Info	Name:	Gender:	Phone:
	Address:		

Product Info	Purchase date:
	Product order number:
	Product Serial Number:

Requirements of return /replacement /repair	Reason description:
---	---------------------

Maintenance records	Failure condition:	Maintenance person:
	Handling situation:	Delivery date:
	Maintenance ticket number:	Delivery date: