

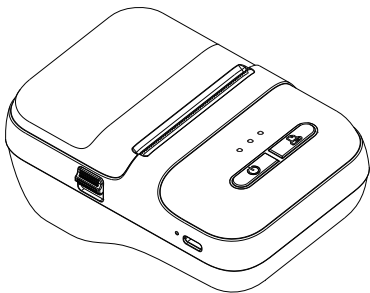

User Manual

CT220B Label Printer



Please read this user manual guide carefully
before operating the product.

Contents

English Version

- Packing List 1
- Appearance Component 2
- Function Description 2
- Description Of Indicator Lights 3
- Paper Roll Loading 4
- Mobile Phone Printing Instruction 6
- Computer Printing Instruction 11
- Trouble Shooting 15
- Specification 18

Katalog

Deutsche Version

- Packliste 20
- Aussehen 21
- Funktionsbeschreibung 21
- Beschreibung der Anzeigeleuchten 22
- Etiketten-Installation 23
- Anleitung zum Drucken mit dem Mobiltelefon.. 25
- Anleitung zum Drucken auf dem Computer.... 30
- Problemdiagnose 34
- Spezifikation 36

● Packing List

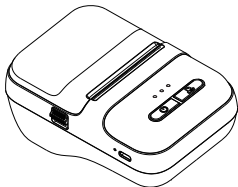

1* Printer

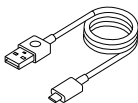

1* USB Cable

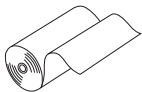

1* 40x30mm
white Labels



Installation Guide



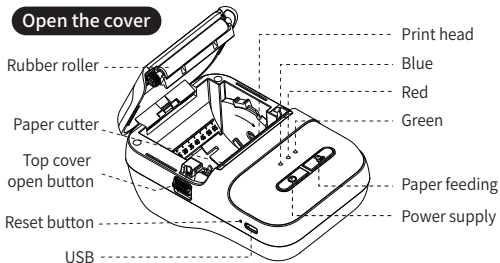

● Appearance Component

Open the cover







● Function Description

Label mode

Diagram	Button	Operating	Features
	Power switch	Press and hold for 2 seconds	Power ON/Off
		Double-click	Print self-test page
	Paper feed button	Click	Advance a piece of paper
		Click	Pause/continue printing
		Press and hold	Test (printing self-test pages for positioning accuracy)
 		Press both buttons together	Switch to Label mode/ Receipt mode

Bill mode

Diagram	Button	Operating	Features
	Power switch	Press and hold for 2 seconds	Power ON/Off
		Double-click	Print self-test page
	Paper feed button	Click	Advance paper by 10 mm
		Double-Click	Advance paper until release
 		Press both buttons together	Switch to Label mode/ Receipt mode

● Description Of Indicator Lights

Indicator light color	Indication status	Status description
Blue	Slow flash	Bluetooth unconnected
	Normally ON	Bluetooth connected
	Flashing	Overheat/Low battery
Red	Normally ON	Charging
Green	Normally ON	Fully charged

● Paper Roll Loading

- ① The paper should load to the left. The thermal side for printing should face down. **(fig.1)**
- ② There is a blue spool holder bracket that should be snug against the paper. Push forward to lock the paper before printing, and push back to unlock. **(fig.2)**
- ③ Pull out part of the paper roll and close the top cover, make sure both sides of the cover are closed. (Note: Face the serrations and tear the label paper down) **(fig.3)**
- ④ Press and hold the power button for 2s to turn on the printer. **(fig.4)**

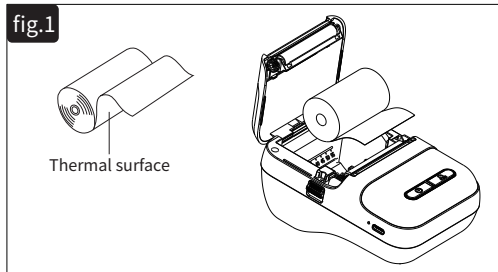

fig.2

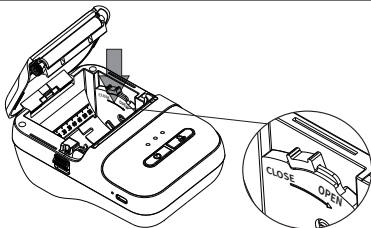

fig.3

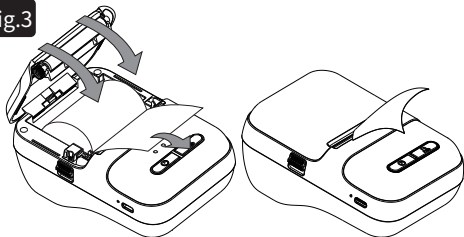
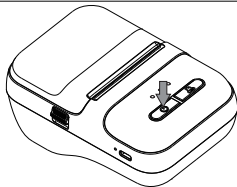

fig.4



● Mobile Phone Printing Instruction

- Scan the QR code below with a mobile phone to download "**Clabel trade**".
- Please follow the software instructions below to operate the software.



Clabel trade



Available on the
App Store



GET IT ON
Google Play

Download label editing app
"Clabel trade" from Google
Play Store or Apple APP Store
and install it.

⚠ Mobile phone printing ONLY for Bluetooth version.

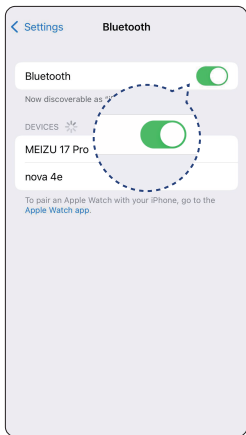

① Enter the mobile phone system settings and set Bluetooth to ON.

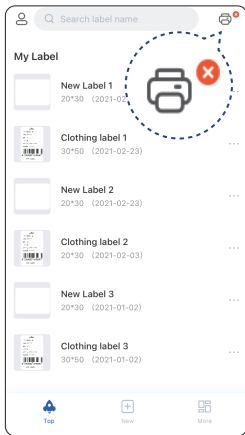

② Enter the clabel trade editing software and click the "Connect" button.

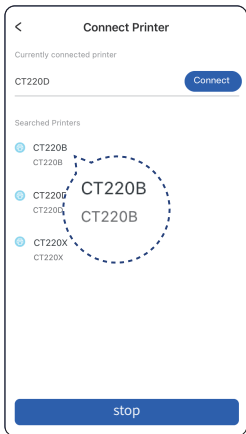

③ Click the Bluetooth name at the beginning of CT220B to connect.

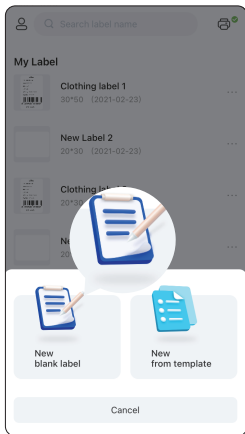

④ Click the new tab.

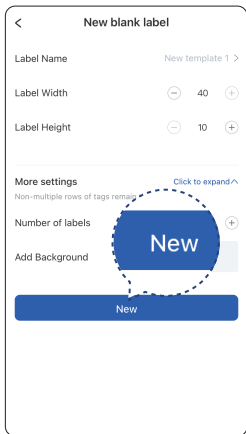

⑤ Enter label name,
width, height click
New after.

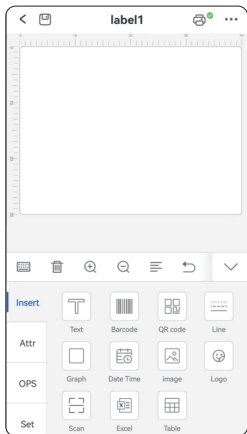

⑥ Editing funtion:
Text, Barcode, QR code, Line, Graph,
Date time, Image, Logo, Scan, Excel, Table.
Set:
Label name, Label size(width/height),
Label rows.
Attr:
Date type, Barcode types, Zoom way,
Font size.

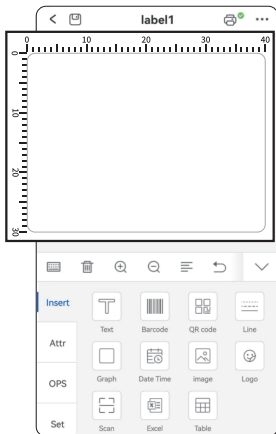

⑦ The area with size is the label content editing area.

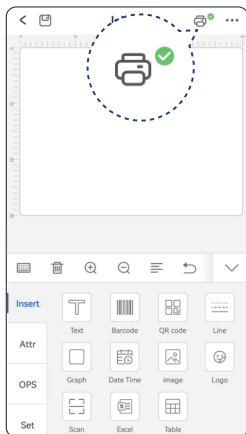

⑧ Add the print content, and then click [icon] in the upper right corner.

- Computer Printing Instruction



Windows

Visit website:<https://ga.ctaiot.com>
to download "Clabel trade" and driver.

 Download the driver from the above url and read the instructions on driver installation/software installation on the website.

Windows Installation

① Install the software and driver.

◆ Step 1

Click to open the downloaded "Clabel trade" installation package.(fig.1)

◆ Step 2

Click"install immediately".(fig.2)

◆ Step 3

Click to open the downloaded print driver package.(fig.3)

◆ Step 4

Click the printer to the computer via USB. Click on the USB printer and follow the prompts to proceed to the next steps.(fig.4)

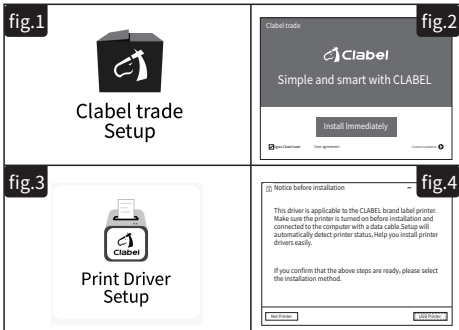

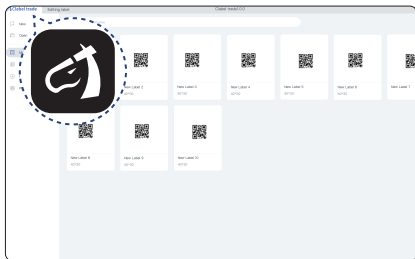

② Open the downloaded clabel trade editing software.

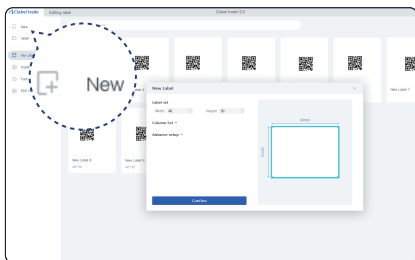

③ Click new, enter the label width and label height, and then click OK.

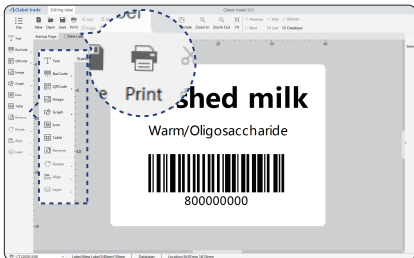

④ Add the printed content to the editing area and click Print.

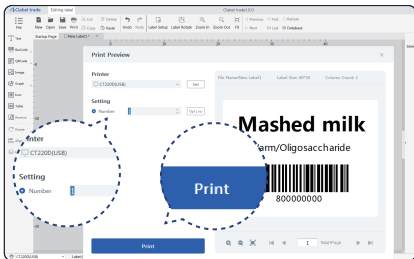

⑤ Select the driver, enter the print quantity, and click Print to finish printing.

Trouble Shooting

Symptom	Cause	Correction
Bluetooth failed to connect	<ul style="list-style-type: none"> - Low version of mobile phone. - The Bluetooth permission is not enabled. 	<ul style="list-style-type: none"> - Machine only suitable for Android 6.0 or above. - Please turn on the permission for the Bluetooth and location in your smartphone.
Print is not centered, offset	<ul style="list-style-type: none"> - The label size is not selected correctly. - Software operation is improper. - Clearance mismatch. - Paper holder is not locked to the left. 	<ul style="list-style-type: none"> - Please select the corresponding label size before printing. - It can be adjusted through the adjustment button on the APP. - Click the paper feed button on the printer, and locate the paper gap. - Go to our product page to watch the video.
Machine does not work on computer	<ul style="list-style-type: none"> - The model is not chosen correctly. 	<ul style="list-style-type: none"> - Check the printer preview page for the correct model of printer selected, the correct model will be shown with the machine model "CT220B".

Symptom	Cause	Correction
The print is not clear and pixelated	<ul style="list-style-type: none"> - Printing appears broken needle. - Font is not clear. 	<ul style="list-style-type: none"> - Print the self-check page and check if the black line on the self-check page is normal. - Select other font in the app, and adjust the font size and bolded font. - Please adjust the print density to make the print more clearly. Choose the print content >Print>Print settings>Print density.
Printed content is all garbled	<ul style="list-style-type: none"> - The print mode is not adjusted properly. 	<ul style="list-style-type: none"> - Check whether the printer mode is print mode,if not, switch to print mode (press and hold the power button and paper feeding button at the same time for three seconds, the printer will print a self-test page to confirm the mode.)

FCC Warning Statement

Changes or modifications not expressly approved by the party responsible for compliance could void the user's authority to operate the equipment.

NOTE: This equipment has been tested and found to comply with the limits for a Class B digital device, pursuant to Part 15 of the FCC Rules. These limits are designed to provide reasonable protection against harmful interference in a residential installation. This equipment generates uses and can radiate radio frequency energy and, if not installed and used in accordance with the instructions, may cause harmful interference to radio communications. However, there is no guarantee that interference will not occur in a particular installation. If this equipment does cause harmful interference to radio or television reception, which can be determined by turning the equipment off and on, the user is encouraged to try to correct the interference by one or more of the following measures:

- Reorient or relocate the receiving antenna.
 - Increase the separation between the equipment and receiver.
 - Connect the equipment into an outlet on a circuit different from that to which the receiver is connected.
 - Consult the dealer or an experienced radio/TV technician for help.
- NOTE: This device and its antenna(s) must not be co-located or operation in conjunction with any other antenna or transmitter

RF Exposure Statement

To maintain compliance with FCC's RF Exposure guidelines, This equipment should be installed and operated with minimum distance of 20cm between the radiator and your body. This device and its antenna(s) must not be co-located or operation in conjunction with any other antenna or transmitter

● Specification

Print technology	Thermal printing
Print resolution	203dpi
Media type	Continuous paper, gap paper
Print speed	50mm/s
Label width	20-58mm
Battery capacity	2000 mAh
Interface	USB,Bluetooth
Power input	Output,DC 5V=2A
Machine size	128mm*84mm*61mm
Machine weight	290g
Barcode	CODE128,CODE39,CODE93,EAN8, EAN13,EAN128,UPC-A,UPC-E,ITF14
QR code	QR CODE
Supported operation system	Andiod 6, iOS10, Windows XP, and Above

Shenzhen Dudian Technology Co., Ltd.
11th Floor, Building 3, COFCO Business Park, Dabao Road,
District 67, Xin'an Street, Bao'an District, Shenzhen

  **RoHS**   Made in China