

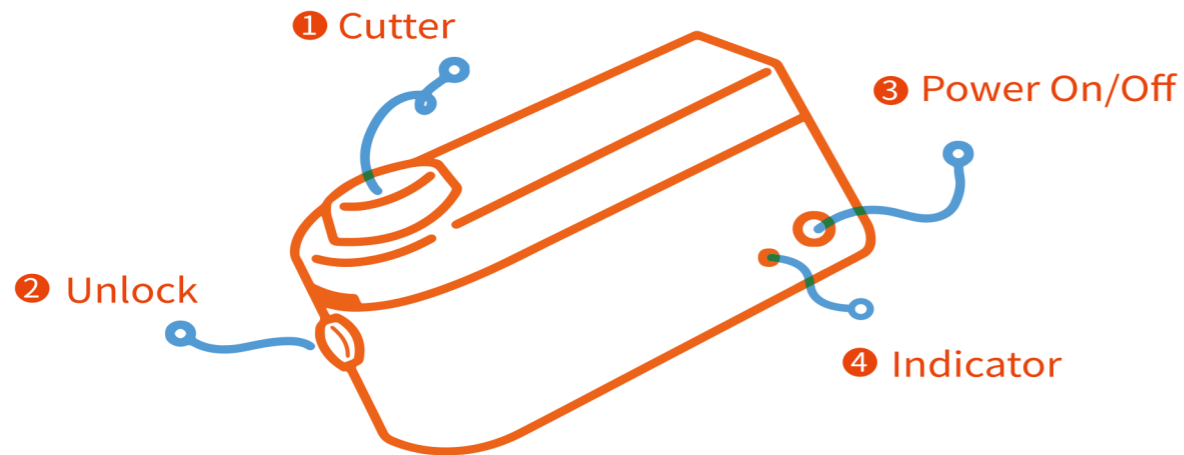

L1 LABEL PRINTER INSTRUCTIONS



Step1. GET STARTED

- 1 To install the label properly, pull out the transparent label lead completely to the paper exit.
- 2 To turn the printer on or off, press and hold the power button.
- 3 The red light will illuminate if the label is either absent or incorrectly installed.

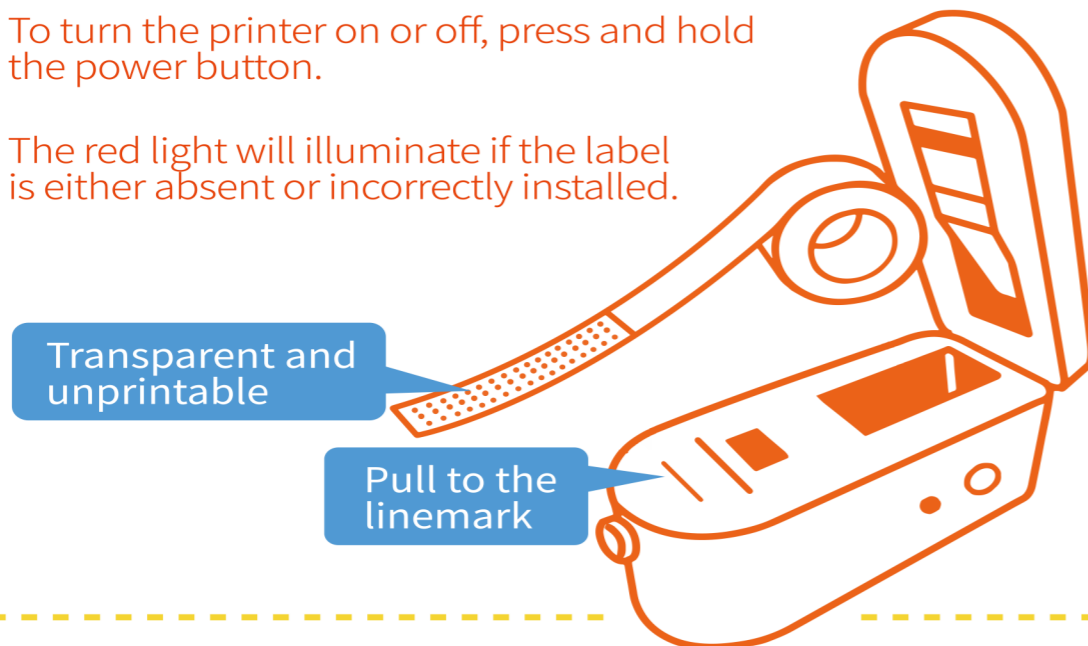

Step2. DOWNLOAD THE APP



- 1 Scan the QR code on the left to download the app directly.
 - 2 Search for "MakeID-Life" on App Store or Google Play and download the app.
- ⚠ The app is only for mobile devices, not computers.

Step3. GET CONNECTED

- 1 Turn on the bluetooth and open the APP
 - 2 Search and connect to the device by clicking the top-right corner of the app.
- ⚠ If you connect to Bluetooth through settings, it will not work.

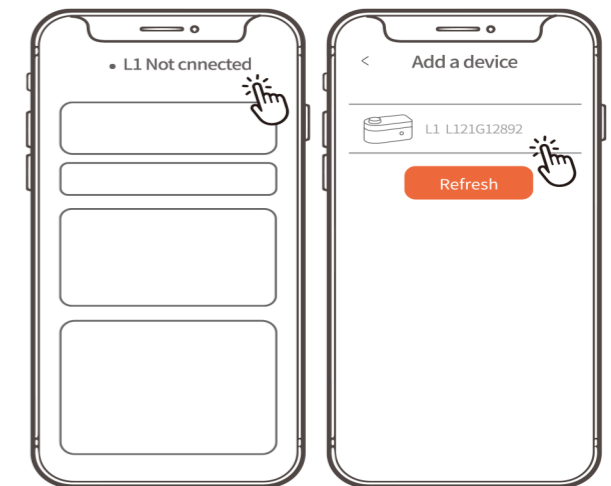

Since our printer and app development needs to comply with Google's low-power Bluetooth communication protocol requirements, we need to obtain the location permission of the Android device in order to search and connect when searching for devices.

START YOUR LABEL PRINTER JOURNEY TODAY!

Check package box for multilingual user guide (English, Deutsch, Español, Français, Italiano, 日本語, 한국어, 中文繁體).

