



The pinnacle of performance and security

HP LaserJet Enterprise MFP M631, M632 series



The world's most secure printing<sup>1</sup>



Maximum productivity.  
High-speed performance.



More. Pages, Performance,  
and Protection.

# The world's most secure printing<sup>1</sup>



Only HP enterprise printers repair themselves from attacks in real time while offering outstanding manageability. Automatically monitor threats, detect intrusions, and validate operating software while centrally managing your fleet with ease.



## Always on guard

Only HP Enterprise printers offer built-in security features that are always on guard.<sup>1</sup>

- With HP Sure Start, each device regularly checks its operating code and repairs itself from attempted hacks.
- Whitelisting checks firmware during startup to help ensure its authentic, good code—digitally signed by HP.
- Run-time intrusion detection continually monitors activity to detect and stop attacks, then automatically reboots.
- HP Connection Inspector inspects outgoing network connections to stop suspicious requests like malware.

Get instant notification of potential security issues so immediate action can be taken to prevent potential attacks. This MFP works with leading Security Information and Event Management (SIEM) tools like Splunk, ArcSight, and McAfee.



## Take security to the next level

Help protect your device with more than 250 embedded security features.<sup>2</sup> Protect information on the MFP and in transit over the network. Store data on the 256-bit encrypted HP High-Performance Secure Hard Disk.<sup>3</sup>

Add features such as card readers and more through the Hardware Integration Pocket.<sup>4</sup> Equip your MFP to store and protect larger files with the optional 1 GB memory upgrade. Further safeguard data stored on the MFP—keys, passwords, certificates, and more—using the optional HP Trusted Platform Module.<sup>5</sup>

Easily develop, deploy, and integrate HP and third-party solutions with the HP Open Extensibility Platform. Optional HP Access Control solutions can help you reinforce security, while helping to reduce costs.

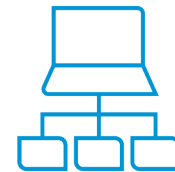

## Centralise control to help build business efficiency

Centralise control of your printing environment with HP Web Jetadmin.<sup>6</sup> Optional HP JetAdvantage Security Manager offers an effective, policy-based approach to help secure HP devices.<sup>7</sup> Easily set security configuration policies and automatically validate settings across the fleet.

HP JetAdvantage Secure Print<sup>8</sup> and HP Access Control (HPAC) help secure documents by requiring authentication to release print jobs. In addition, extend capabilities and easily customise with HPAC—integrate job accounting, manage rights, and establish quotas for things such as colour use.<sup>9</sup> Save IT time and make printing easy for the entire enterprise by using a single driver for all HP devices.

### ▶ For more information

#### Fleet management

HP Web Jetadmin visit: [hp.com/go/wia](http://hp.com/go/wia)

Solution brief: <http://h20195.www2.hp.com/V2/GetPDF.aspx/4AA5-2718EEW.pdf>

Video: <http://hp.brightcovegallery.com/solutions/detail/video/4271055504001/>

HP Universal Print Driver visit: [hp.com/go/upd](http://hp.com/go/upd)

Solution brief: <http://h20195.www2.hp.com/V2/GetPDF.aspx/4AA2-4781EEW>

#### Security

HP JetAdvantage Security Solutions visit: [hp.com/go/printsecurity](http://hp.com/go/printsecurity)

Solution brief: <http://h20195.www2.hp.com/V2/GetPDF.aspx/4AA3-1295EEW.pdf>

Video: <http://hp.brightcovegallery.com/products/detail/video/4270905124001/>

HP JetAdvantage Security Manager visit: [hp.com/go/securitymanager](http://hp.com/go/securitymanager)

Brochure: <http://h20195.www2.hp.com/V2/GetPDF.aspx/4AA3-9275EEW.pdf>

Video: <http://hp.brightcovegallery.com/products/detail/video/4270837770001/>

# Maximum productivity. High-speed performance.

Get the job done with an MFP equipped for high-speed performance and designed for energy efficiency. Be confident that your employees can speed through their tasks without interruption.

## Keep business moving

Breeze through tasks—this MFP prints your first page from ready/sleep mode as fast as 5.2/7.9 seconds.<sup>10,11</sup> Print up to 61 pages per minute (ppm),<sup>12</sup> A4 simplex (M632 series)—with up to 85% duplex efficiency. Print on A5 paper in landscape mode at speeds up to 100 ppm (M632 series).<sup>13</sup>



Print directly from your smartphone, tablet, or notebook PC to your Wi-Fi Direct<sup>®14</sup>/Bluetooth<sup>®</sup> Low Energy<sup>15</sup> enabled MFP—without accessing the company network. Or choose managed mobile print solutions (HP PrinterOn Enterprise or HP Access Control) for advanced management and reporting capabilities.<sup>16</sup>

## Loaded for productivity

Spend less time loading paper with a 3,750-sheet maximum capacity.<sup>17</sup> Options for this series include a 1x550 and 2,000-sheet HCI feeder, a 3x550-sheet paper feeder, or a 1x550-sheet paper feeder with a cabinet to store supplies.<sup>18</sup> The wheeled stand allows you to relocate the MFP. Standard and optional 550-sheet input trays fit a whole ream of paper and support paper sizes from A6 to 216 x 356 mm.



Equip employees to breeze through tasks using the new, intuitive interface on the 20.3 cm touchscreen. (For more information, see Appendix A, page 15.) The 3-bin stapler/stacker with job offset allows you to set up each bin for a different department or option, such as face down, fax, and copy (M631z and Flow M632z models only).

## Designed to conserve

Help keep productivity up and energy use down. This efficient MFP is designed for exceptionally low energy consumption—thanks to its innovative design and specially formulated toner.<sup>19</sup>



Help cut costs with HP Auto-On/Auto-Off Technology<sup>20</sup> and HP Instant-on Technology<sup>21</sup>—intelligence that readies your MFP right when you need it and turns it off when you don't. Print efficiently on 60 g/m<sup>2</sup> lightweight media—designed to save energy.

# More. Pages, Performance, and Protection.



Get more pages and help protect your MFP, using Original HP Toner cartridges with JetIntelligence.<sup>22</sup>



## More quality pages than ever before

Get the most prints for your money. Specially redesigned Original HP Toner cartridges with JetIntelligence deliver up to 64% more pages per cartridge than predecessors.<sup>22</sup> Precision black toner is engineered to deliver consistent placement of toner particles and produce sharp text, bold blacks, and crisp graphics.



## Help protect your investment

Don't put your MFP—and print quality—at risk. Help retain the consistent Original HP quality you paid for with innovative, anti-fraud technology. Enable office-wide adherence to printing policies with cartridge authentication technology.



## Ready to work, right away

Speed through print jobs right out of the box. This MFP is shipped with preinstalled, specially designed Original HP LaserJet toner cartridges with JetIntelligence. Auto seal removal enables simple and seamless cartridge replacement, so you can get back to business fast—without costly delays or frustrating messes.



Print uninterrupted and get more pages with optional high-yield and extra-high-yield cartridges.<sup>22,23</sup> (A/X/Y: 11,000/25,000/41,000 pages<sup>24</sup>)



# Give workgroups the speed they need



Accelerate workflow, improve accuracy, and easily connect people throughout your organisation. Complete high-volume scan jobs fast—up to 167 ipm for the Flow models<sup>25</sup>—and avoid extra steps with an MFP designed for maximum productivity.



## Fast, unattended scanning

Turn stacks of paper documents into digital files. Load up to 150 pages into the automatic document feeder for fast two-sided, single-pass scanning.<sup>26</sup> Spend less time waiting with two-sided scan speeds up to 111 images per minute (ipm)<sup>25</sup> (up to 167 ipm<sup>25</sup> for the Flow models). Choose Flow models for advanced workflow features such as HP EveryPage and a pull-out keyboard.<sup>27</sup>



## Easily scan, copy, and fax

Easily make copies or send faxes using the scanner glass or the ADF. Scan a variety of media sizes from the ADF— from checks (68 x 147 mm) to banners (216 x 864 mm). Send scanned documents directly to email, network folders, LAN fax addresses,<sup>28</sup> or Microsoft® SharePoint®. Walk up and print from or scan to a memory device using the easy-access USB.<sup>29</sup>







## Every page, every time

Capture every page easily—with confidence. HP EveryPage gives employees smooth paper-handling capabilities to detect potential errors or missed pages on the spot—for scan jobs of all kinds.<sup>27</sup>

Help ensure every scanned document is properly oriented, cropped to size, and greyscale-optimised.

Flow MFP

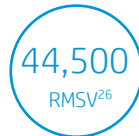
 <p><b>HP EveryPage</b> featuring ultrasonic multi-feed detection</p>	 <p><b>167</b> ipm<sup>12</sup></p> <p><b>Faster scan speeds</b></p>	 <p><b>Automatic</b> page orientation, auto-crop, and auto-tone</p>
 <p><b>Pull-out keyboard</b></p>	 <p><b>Built-in OCR</b></p>	 <p><b>44,500</b> RMSV<sup>26</sup></p> <p><b>Extended Life ADF</b></p>

# Get to know the HP LaserJet Enterprise MFP M631 series

HP LaserJet Enterprise MFP M631z shown

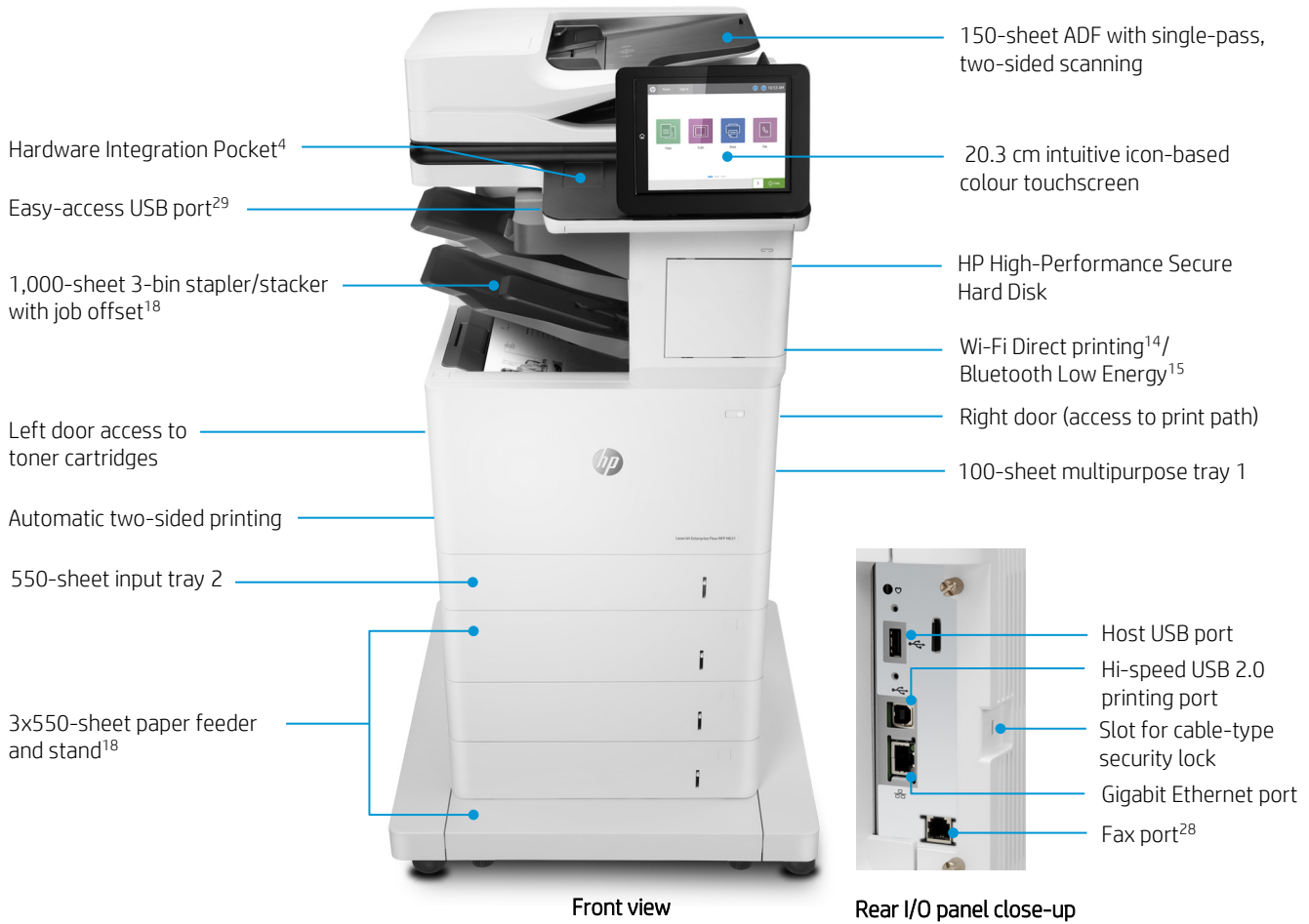

## Series at a glance

<b>Model (product number)</b>	MFP M631dn (J8J63A)	Flow MFP M631h (J8J64A)	MFP M631z (J8J65A)
<b>Print speeds (A4)<sup>12</sup></b>	Up to 52 ppm	Up to 52 ppm	Up to 52 ppm
<b>Fax capabilities</b>	Optional	Optional	✓
<b>HP High-Performance Secure Hard Disk</b>	Optional	✓	✓
<b>100-sheet tray 1, 550-sheet tray 2</b>	✓	✓	✓
<b>550-sheet paper feeder<sup>30</sup></b>	Optional (up to four)	Optional (up to four)	Optional (up to one)
<b>1x550-sheet paper feeder with stand and cabinet<sup>30</sup></b>	Optional	Optional	Not available
<b>3x550-sheet paper feeder and stand<sup>30</sup></b>	Optional	Optional	✓
<b>1x550 and 2,000-sheet HCl feeder and stand<sup>30</sup></b>	Optional	Optional	Not available
<b>Envelope feeder</b>	Optional (up to two)	Optional (up to two)	Optional (up to one)
<b>3-bin stapler/stacker with job offset</b>	Not available	Not available	✓
<b>Advanced workflow features, including pull-out keyboard<sup>27</sup></b>	Not available	✓	Not available
<b>Direct mobile printing</b>	Optional wireless direct <sup>14</sup> /NFC <sup>31</sup>	Optional wireless direct <sup>14</sup> /NFC <sup>31</sup>	Embedded Wi-Fi Direct <sup>14</sup> / Bluetooth Low Energy <sup>15</sup>
<b>Wireless networking</b>	Optional <sup>32</sup>	Optional <sup>32</sup>	Optional <sup>32</sup>

# Get to know the HP LaserJet Enterprise MFP M632 series

HP LaserJet Enterprise Flow MFP M632z shown

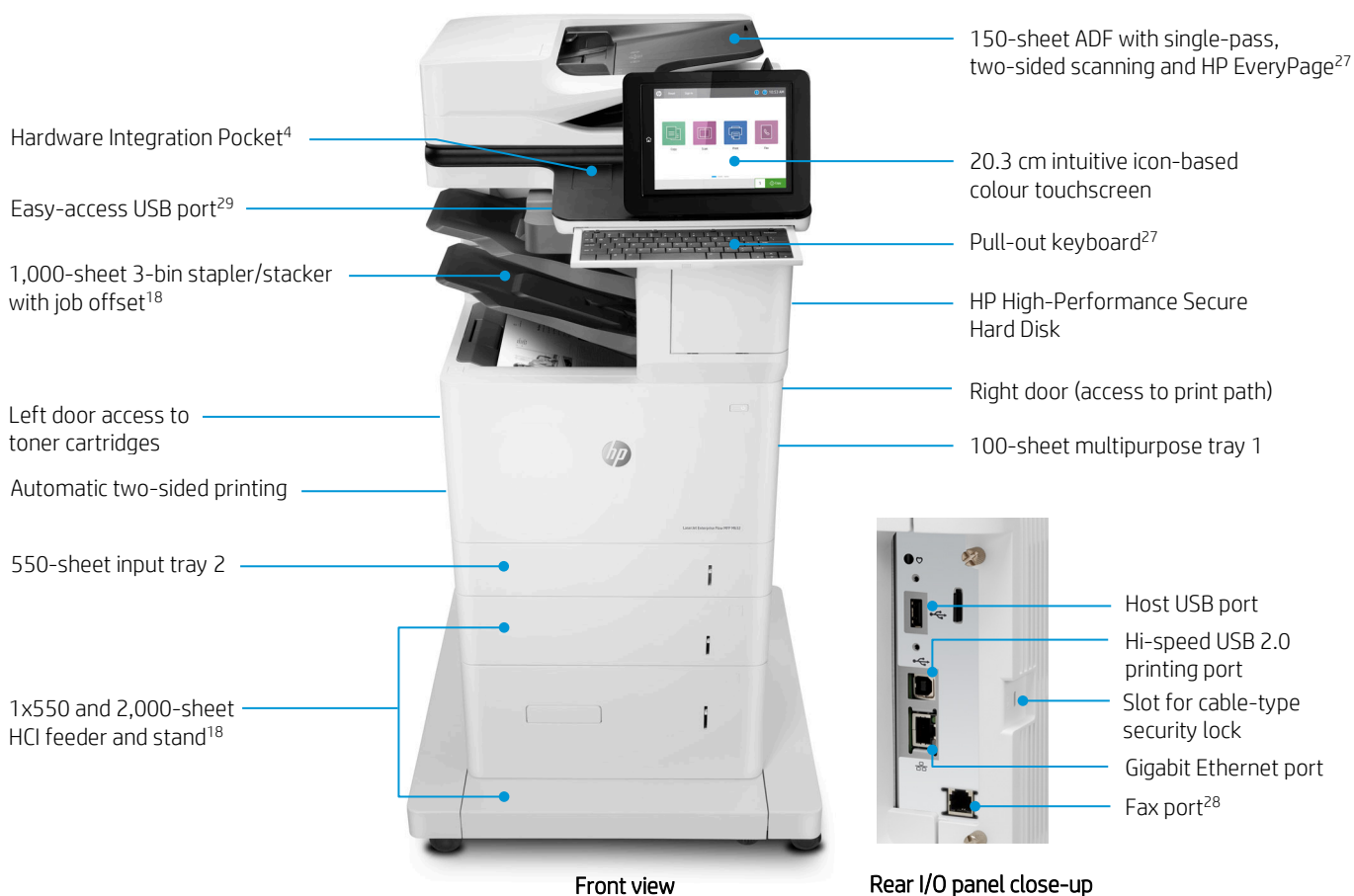

## Series at a glance

<b>Model (product number)</b>	MFP M632h (J8J70A)	MFP 632ft (J8J71A)	Flow MFP M632z (J8J72A)
<b>Print speeds (A4)<sup>12</sup></b>	Up to 61 ppm	Up to 61 ppm	Up to 61 ppm
<b>Fax capabilities</b>	Optional	✓	✓
<b>HP High Performance Secure Hard Disk</b>	✓	✓	✓
<b>100-sheet tray 1, 550-sheet tray 2</b>	✓	✓	✓
<b>550-sheet paper feeder<sup>30</sup></b>	Optional (up to four)	Optional (up to one)	Optional (up to one)
<b>1x550-sheet paper feeder with stand and cabinet<sup>30</sup></b>	Optional	✓	Not available
<b>3x550-sheet paper feeder and stand<sup>30</sup></b>	Optional	Not available	Not available
<b>1x550 and 2,000-sheet HCI feeder and stand<sup>30</sup></b>	Optional	Not available	✓
<b>Envelope feeder</b>	Optional (up to two)	Optional (up to one)	Optional (up to one)
<b>3-bin stapler/stacker with job offset</b>	Not available	Not available	✓
<b>Advanced workflow features, including pull-out keyboard<sup>27</sup></b>	Not available	Not available	✓
<b>Direct mobile printing</b>	Optional wireless direct <sup>14</sup> /NFC <sup>31</sup>	Optional wireless direct <sup>14</sup> /NFC <sup>31</sup>	Optional wireless direct <sup>14</sup> /NFC <sup>31</sup>
<b>Wireless networking</b>	Optional <sup>32</sup>	Optional <sup>32</sup>	Optional <sup>32</sup>

# Paper-handling accessories



550-sheet paper feeder (J8J89A)

1x550-sheet paper feeder with stand and cabinet (J8J91A)

3x550-sheet paper feeder and stand (J8J93A)

1x550 and 2,000-sheet HCI feeder and stand (J8J92A)

Envelope feeder (J8J90A)

3-bin stapler/stacker

Standard		M632fht	M631z	Flow M632z		M631z, Flow M632z
Optional	Add up to one: M631z, M632fht, Flow M632z <sup>30</sup>  Add up to four: M631dn, Flow M631h, M632h <sup>30</sup>	M631dn, Flow M631h, M632h <sup>30</sup>	M631dn, Flow M631h, M632h <sup>30</sup>	M631dn, Flow M631h, M632h <sup>30</sup>	Add up to one: M631z, M632fht, Flow M632z  Add up to two: M631dn, Flow M631h, M632h	Not available

## What's new

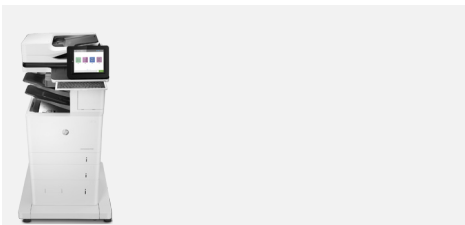

HP LaserJet Enterprise Flow MFP M632z



HP LaserJet Enterprise Flow MFP M630z

Benefits

Print speed: up to 61 ppm, simplex; up to 50 ipm, duplex <sup>12</sup>	Up to 57 ppm, simplex; up to 39 ipm, duplex	7% faster simplex, 28% faster duplex—with up to 85% duplex efficiency
150-sheet ADF and duplex scan speeds up to 167 ipm, <sup>25</sup> black and colour (Flow models)	100-sheet ADF with duplex scan speeds up to 60/45 ipm (black/colour)	Increased workflow productivity with 1.5 times more ADF capacity, and more than 3.5 times as fast two-sided colour scanning
FPO as fast as 5.2/7.9 seconds from ready/sleep <sup>10,11</sup>	FPO as fast as 8.5/11 seconds from ready/sleep	Up to 36% faster FPO from ready; 28% from sleep
250+ embedded security settings, <sup>2</sup> including HP Sure Start, run-time intrusion detection, and whitelisting	HP Sure Start not available; Whitelisting and run-time intrusion detection available with firmware upgrade	Enhanced protection with key security technologies designed to thwart attackers' efforts and self-heal
3-bin stapler/stacker with job offset and up to 3,200-sheet input, standard (3,750 sheets maximum <sup>17</sup> ); input trays hold 550 sheets	Up to 3,100-sheet input (standard/maximum); input trays hold 500 sheets	Improved paper-handling options and 21% higher maximum input capacity; with 550 sheet trays, you can add a whole ream before the paper runs completely out
Original HP Toner cartridges with JetIntelligence; Extra High Yield black (~41,000 pages) <sup>23,24</sup>	Original HP toner cartridges; Extra High Yield black not available	Up to 64% more professional-quality pages, <sup>22</sup> peak printing performance, and anti-fraud technology



# Technical specifications

	HP LaserJet Enterprise MFP M631 series	HP LaserJet Enterprise MFP M632 series
<b>Product number</b>	M631 dn: J8J63A Flow M631h: J8J64A M631z: J8J65A	M632h: J8J70A M632fht: J8J71A Flow M632z: J8J72A
<b>Control panel/data entry</b>	20.3 cm (8-inch) SVGA LCD (colour graphics), smooth gesture-enabled touchscreen; Easy-access USB; Hardware Integration Pocket <sup>4</sup>	
	Flow M631h: Plus pull-out keyboard	Flow M632z: Plus pull-out keyboard
<b>Print speed<sup>12</sup></b>	Simplex: Up to 52 ppm, A4 (55 ppm, letter) Duplex: Up to 43 ipm, A4 (45 ipm, letter) A5: Up to 80/6 (landscape/portrait) <sup>13</sup>	Simplex: Up to 61 ppm, A4 (65 ppm, letter) Duplex: Up to 50 ipm, A4 (53 ipm, letter) A5: Up to 100/6 (landscape/portrait) <sup>13</sup>
<b>First page out</b>	From ready: <sup>10</sup> As fast as 5.2/5.1 seconds (A4/letter) ( <i>all models</i> ) From sleep: <sup>11</sup> Flow M631h, M632h, M632fht: as fast as 7.9/7.8 seconds (A4/letter) M631z, Flow M632z: as fast as 12.2/12.1 seconds (A4/letter)	
<b>Print resolution</b>	FastRes 1200 (600 x 600 x 8bpp dpi), 1200 x 1200 dpi ( <i>all models</i> )	
<b>Scanning resolution</b>	Up to 600 dpi ( <i>all models</i> )	
<b>ADF scan speed<sup>25</sup></b>		
Single-sided	M631 dn, M631z, M632h, M632fht: Up to 69/75 ppm (A4/letter, black and colour) Flow M631h, Flow M632z: Up to 83/90 ppm (A4/letter, black and colour)	
Two-sided	M631 dn, M631z, M632h, M632fht: Up to 111/120 ipm (A4/letter, black and colour) Flow M631h, Flow M632z: Up to 167/180 ipm (A4/letter, black and colour)	
<b>Features</b>		
Printing	Print preview, duplex printing, print multiple pages per sheet (2, 4, 6, 9, 16), collation, watermarks, store print jobs	
Scanning	Flatbed scanner, up to 220 x 365 mm (8.75 x 14.375 in); 150-sheet ADF with two-sided, single-pass scanning; Advanced features: Optimise text/picture, image adjustments, job build, output quality setting, selectable scan resolution 75 to 600 dpi, auto detect colour, edge erase, job notification, blank page suppression, Quick Sets Flow M631h, M632z: Plus HP EveryPage with ultrasonic multi-feed detection, Embedded Optical Character Recognition (OCR), auto-orientation, auto-crop-to-page, auto-tone	
Digital sending	Standard: Scan to email, save-to-network folder, save-to-USB drive, send to SharePoint, send to FTP, send to Internet fax, <sup>28</sup> local address book, SMTP over SSL, send to LAN fax, <sup>28</sup> blank page removal, edge erase, auto colour sense, auto crop to content, compact PDF, Quick Sets Optional: via HP Digital Sending Software (HP DSS): send to folder, send-to-workflow, send-to-printer, authentication, digital fax (send to LAN, Internet), OCR, local address book Flow M631h, Flow M632z: Plus HP EveryPage with multi-pick detect, embedded Optical Character Recognition (OCR), auto orientation, auto crop to page, auto-tone	
File formats <sup>33</sup>	PDF, JPEG, TIFF, MTIFF, XPS, PDF/A; Scan to easy-access USB: PDF, JPEG, TIFF, MTIFF, XPS, PDF/A; Print from easy-access USB: PDF, PS, Print Ready files (.prn, .pcl, .cht) Flow M631h, Flow M632z: Plus TEXT (OCR), Unicode TEXT (OCR), RTF (OCR), Searchable PDF (OCR), Searchable PDF/A (OCR), HTML (OCR), CSV (OCR); Scan to easy access USB: TEXT (OCR), Unicode TEXT (OCR), RTF (OCR), Searchable PDF (OCR), Searchable PDF/A (OCR), HTML (OCR), CSV (OCR)	
Copying	Two-sided copying, scalability, image adjustments (darkness, contrast, background cleanup, sharpness), N-up, N or Z-ordering, content orientation, collation, booklet, job build, edge-to-edge, job storage, ID Copy, Book Copy, A-to-B Copy (different media sizes); Copy resolution: up to 600 x 600 dpi (flatbed), up to 600 x 450 dpi (ADF)	
Faxing	M631z, M632fht, Flow M632z: Fax speed: <sup>34</sup> 33.6 kbps/3 seconds per page (A4/letter); fax forwarding, receive fax polling, broadcasting to up to 210 locations, speed dial up to 1000 numbers, each with 210 destinations, auto-fax reduction, auto-redialling, stored faxes, fax archiving, scale-to-fit, fax address book, LAN/Internet fax, fax number confirmation, holiday fax schedule Fax resolution: Standard 203 x 98 dpi, fine 203 x 196 dpi, superfine 300 x 300 dpi, best up to 300 x 300 dpi (400 x 400 dpi for received faxes only); 256 levels of grey M631 dn, Flow M631h, M632h: Fax optional	
<b>Processor</b>	1.2 GHz ( <i>all models</i> )	

	HP LaserJet Enterprise MFP M631 series	HP LaserJet Enterprise MFP M632 series
<b>Memory</b>	<p>M631 dn, M631z, M632h, M632fht, Standard: 2 GB system memory (1.5 GB printer and 512 MB scanner); Maximum: 2.5 GB system memory with installation of 1 GB DDR3 144-pin Accessory DIMM (only 512 MB is addressable by the system)</p> <p>Flow M631h, Flow M632z, Standard: 2.5 GB system memory (1.5 GB printer and 1 GB scanner); Maximum: 3 GB system memory with installation of 1 GB DDR3 144-pin Accessory DIMM (only 512 MB is addressable by the system)</p>	
<b>Storage</b>	<p>M631 dn: Standard 16 GB EMMC; Optional HP High-Performance Secure Hard Disk (AES 256 hardware encryption or greater; secure erase capabilities: Secure File Erase-Temporary Job Files, Secure Erase-Job Data, Secure ATA Erase-Disk)</p> <p>All other models: Embedded HP High-Performance Secure Hard Disk, minimum 320 GB (AES 256 hardware encryption or greater; secure erase capabilities: Secure File Erase-Temporary Job Files, Secure Erase-Job Data, Secure ATA Erase-Disk)</p>	
<b>Durability ratings</b>		
Recommended monthly page volume <sup>35</sup>	5,000 pages to as high as 30,000 pages ( <i>all models</i> )	
Recommended monthly scan volume <sup>26</sup>	<p>M631 dn, M631z, M632h, M632fht: 14,250 pages to as high as 23,750 pages</p> <p>Flow M631h, Flow M632z: 26,750 pages to as high as 44,500 pages</p>	
Duty cycle <sup>36</sup>	Up to 300,000 pages ( <i>all models</i> )	
<b>Media specifications</b>		
Input capacity	<p>M631 dn, Flow M631h, M632h: Up to 650 sheets standard (up to 3,750 maximum)<sup>30</sup></p> <p>Tray 1: Up to 100 sheets</p> <p>Tray 2: Up to 550 sheets</p>	
	<p>M631z: Up to 2,300 sheets standard (2,850 sheets maximum)<sup>30</sup></p> <p>Tray 1: Up to 100 sheets</p> <p>Tray 2: Up to 550 sheets</p> <p>3x550-sheet paper feeder and stand</p>	<p>M632fht: Up to 1,200 sheets standard (1,750 sheets maximum)<sup>30</sup></p> <p>Tray 1: Up to 100 sheets</p> <p>Tray 2: Up to 550 sheets</p> <p>1x550 sheet paper feeder with stand and cabinet</p> <p>Flow M632z: Up to 3,200 sheets standard (3,750 sheets maximum)<sup>30</sup></p> <p>Tray 1: Up to 100 sheets</p> <p>Tray 2: Up to 550 sheets</p> <p>1x550 and 2,000-sheet HCl feeder and stand</p>
Output capacity	<p>M631 dn, Flow M631h, M632h, M632fht: Up to 500 sheets; Up to 75 envelopes</p> <p>M631z, Flow M632z: Up to 1,000 sheets, with 3-bin stapler/stacker</p>	
Two-sided printing	Automatic ( <i>all models</i> )	
Media sizes	<p>Tray 1: A4, A5, A6, RA4, B5 (JIS), B6 (JIS), 16K, 10 x 15 cm, Oficio (216 x 340 mm), postcards (JIS single and double), envelopes (DL ISO, C5, C6, B5); Letter, legal, statement, executive, Oficio (8.5 x 13 in), 3 x 5 in, 4 x 6 in, 5 x 7 in, envelopes (No. 9, No. 10, Monarch); Custom media sizes: 76 x 127 to 216 x 356 mm (3 x 5 to 8.5 x 14 in)</p> <p>Trays 2, 3, 4, and 5: A4, A5, A5-R, RA4, B5 (JIS), 16K; Letter, legal (trays 3, 4, 5 only), executive; Custom media sizes: 99 x 148 to 216 x 297 mm (3.9 x 5.8 to 8.5 x 11 in)</p> <p>HCl: A4; Letter, legal; Custom media sizes: 210 x 279 to 216 x 356 mm (8.27 x 11 to 8.5 x 14 in)</p> <p>Duplex: A4, A5, RA4, B5 (JIS), Oficio (216 x 340 mm); Letter, legal, executive</p> <p>ADF: A4, RA4, A5, A6, B5, B6 (JIS), Postcard (JIS), DPostcard (JIS); Letter, legal, Oficio, executive, statement, 16K, 4 x 6 in, 5 x 7 in, 5 x 8 in</p>	
Media weights	<p>Tray 1: Plain: 60 to 199 g/m<sup>2</sup> (16 to 53 lb); Envelopes: 60 to 90 g/m<sup>2</sup> (16 to 24 lb)</p> <p>Trays 2, 3, 4, and 5, HCl, duplex: 60 to 120 g/m<sup>2</sup> (16 to 32 lb)</p> <p>ADF: 45 to 199 g/m<sup>2</sup> (12 to 53 lb)</p>	
Media types	Paper (plain, light, bond, recycled, heavy, extra heavy, cardstock, pre-printed, pre-punched, coloured, rough, heavy rough), mono transparency, labels, letterhead, envelope, heavy envelope	
<b>Print languages</b>	HP PCL 6, HP PCL 5 (HP PCL 5 driver available from the Web only), HP postscript level 3 emulation, native PDF printing (v 1.7), Apple AirPrint <sup>37</sup>	
<b>Fonts</b>	105 internal TrueType fonts scalable in HP PCL, 92 internal scalable fonts in HP postscript level 3 emulation (Euro symbol built-in); 1 internal Unicode Font (Andale Mono WorldType); 2 Internal Windows Vista® 8 Fonts (Calibri, Cambria); Additional font solutions available via third-party flash memory cards; HP LaserJet Fonts and IPDS Emulation available at <a href="http://hp.com/go/laserjetfonts">hp.com/go/laserjetfonts</a>	

	HP LaserJet Enterprise MFP M631 series	HP LaserJet Enterprise MFP M632 series
<b>Connectivity</b>	2 Hi-Speed USB 2.0 Host; 1 Hi-Speed USB 2.0 Device; 1 Gigabit Ethernet 10/100/1000T network M631z, M632fht, Flow M632z: Plus fax M631 dn, Flow M631h, M632h: Optional fax	
<b>Mobile printing</b>	HP ePrint, <sup>38</sup> AirPrint, <sup>37</sup> Mopria-certified, Google Cloud Print™ 2.0 MFP M631z: Plus built-in Wi-Fi Direct <sup>14</sup> and Bluetooth Low Energy <sup>15</sup> M631 dn, Flow M631h, M632h, M632fht, Flow M632z: Optional wireless direct printing <sup>14</sup> and NFC touch-to-print enabled with purchase of accessory <sup>31</sup>	
<b>Network capabilities</b>	Standard: via HP Jetdirect Ethernet embedded print server supports: 10Base-T, 100Base-Tx, 1000Base-T; 802.3az (EEE) support on Fast Ethernet and Gigabit Ethernet; IPsec Optional: 802.11a/b/g/n wireless networking enabled with purchase of accessory <sup>32</sup>	
<b>Network protocols</b>	Via built-in networking solution: TCP/IP, IPv4, IPv6 Print: TCP-IP port 9100 Direct Mode, LPD (raw queue support only), Web Services Printing, IPP 2.0, Apple AirPrint, <sup>37</sup> HP ePrint, FTP Print, Google Cloud Print Discovery: SLP, Bonjour, Web Services Discovery IP Config: IPv4 (BootP, DHCP, AutoIP, Manual, TFTP Config, ARP-Ping), IPv6 (Stateless Link-Local and via Router, Statefull via DHCPv6) Management: SNMPv2/v3, HTTP/HTTPS, Telnet, TFTP Config, FTP FW Download, Syslog Security: SNMPv3, SSL Cert Management, Firewall, ACL, 802.1x	
<b>Security</b>	Identity management: Kerberos authentication, LDAP authentication, 1000 user PIN codes, optional HP and 3rd party advanced authentication solutions (e.g., badge readers) Network: IPsec/firewall with Certificate, Pre-Shared Key, and Kerberos authentication, Supports WJA-10 IPsec configuration Plug-in, 802.1X authentication (EAP-PEAP; EAP-TLS), SNMPv3, HTTPS, Certificates, Access Control List Data: Storage Encryption, Encrypted PDF and Email (uses FIPS 140 validated cryptographic libraries from Microsoft), Secure Erase, SSL/TLS (HTTPS), Encrypted Credentials Device: Security lock slot, USB port disablement, Hardware Integration Pocket for security solutions, <sup>4</sup> Intrusion Detection with Red Balloon Security Technology - Constant in-device monitoring for attacks, HP Sure Start Secure Boot - BIOS Integrity Checking with self-healing capability, Whitelisting - loads only known good code (DLLs, EXEs, etc.) Security management: Compatible with HP JetAdvantage Security Manager, <sup>7</sup> Device Security Syslog Messages processed and accessible in ArcSight, McAfee, and Splunk SIEMs	
<b>Compatible operating systems<sup>39</sup></b>	Windows® 10 all 32- and 64-bit editions (excluding RT OS for Tablets), Windows 7 all 32- and 64-bit editions, Windows 8/8.1 all 32- and 64-bit editions (excluding RT OS for Tablets), Windows Vista all 32-bit editions (Home Basic, Premium, Professional, etc.), Windows XP SP3 32-bit editions (XP Home, XP Pro, etc.) Mac OS 10.12 Sierra, OS X 10.10 Yosemite, OS X 10.11 El Capitan Mobile OS: Android™ Linux Boss (5.0), Linux Debian (7.0, 7.1, 7.2, 7.3, 7.4, 7.5, 7.6, 7.7, 7.8, 7.9, 8.0, 8.1, 8.2, 8.3, 8.4, 8.5, 8.6), Linux Fedora (22, 23, 24), Linux Mint (17, 17.1, 17.2, 17.3, 18), Linux Red Hat Enterprise (6.0, 7.0), Linux SUSE (13.2, 42.1), Linux Ubuntu (12.04, 14.04, 15.10, 16.04, 16.10) Other: UNIX	
<b>Compatible network operating systems</b>	Citrix MetaFrame Presentation Server 3.0, Citrix MetaFrame XP Presentation Server (Feature Release 1, 2, and 3), Citrix on Windows Server 2003/2003R2, Citrix on Windows Server 2008/2008R2/2008 R2 SP1, Citrix on Windows Server 2012/2012R2, Citrix Presentation Server 4.0/4.5, Citrix XenApp 5.0 (Plus Feature Pack 2 and 3) for Windows Server 2008 Terminal Services 32- and 64-bit, Citrix XenApp 6.0/6.5 [for Windows Server 2008 R2 Terminal Services, 32- and 64-bit], Citrix XenApp 6.0/6.5/7.5 [for Windows Server 2008 R2 SP1 Terminal Services, 32- and 64-bit], Citrix XenApp 7.5 [for Windows Server 2012 and 2012 R2 Terminal Services, 64-bit], Citrix XenDesktop 5.6 [for Windows Server 2008 R2 Terminal Services, 32- and 64-bit], Citrix XenDesktop 5.6/7.0/7.5 [for Windows Server 2008 R2 SP1 Terminal Services, 32- and 64-bit], Citrix XenDesktop 7.0/7.5 [for Windows Server 2012 and 2012 R2 Terminal Services, 64-bit] Novell NetWare 6.5/SP8 Novell Clients <a href="http://novell.com/iprint">novell.com/iprint</a> , Novell iPrint Appliance v1.0, Novell Open Enterprise Server 11/SP1, Novell Open Enterprise Server 2 for Linux, Novell Servers <a href="http://novell.com/iprint">novell.com/iprint</a> Windows Server 2003/2003 R2 32-/64-bit (SP1/SP2) Standard/Enterprise/Datacenter (+ Cluster and Terminal Services), Windows Server 2003/2003 R2 32-bit (SP1/SP2), Standard/Enterprise (+ Cluster and Terminal Services), Windows Server 2008 32-/64-bit (SP2) Standard/Enterprise (+ Cluster and Terminal Services), Windows Server 2008 R2 64-bit (SP1) Standard/Enterprise (+ Cluster and Terminal Services), Windows Server 2008/2008 R2 32-/64-bit (SP1/SP2) Standard/Enterprise/Datacenter (+ Cluster and Terminal Services), Windows Server 2012/2012 R2 64-bit Standard/Foundation/Essentials/Datacenter (+ Cluster and Terminal Services)	
<b>System requirements, Windows</b>	A compatible operating system (see above), 2 GB available hard disk space (OS hardware requirements, see <a href="http://microsoft.com">microsoft.com</a> )	

	HP LaserJet Enterprise MFP M631 series	HP LaserJet Enterprise MFP M632 series
<b>System requirements, Macintosh</b>	A compatible operating system (see above), 1.3 GB available hard drive space; Internet (OS hardware requirements, see <a href="http://apple.com">apple.com</a> )	
<b>Dimensions (width x depth x height)</b>	<p>M631 dn, Flow M631h: 512 x 558 x 640 mm (20.15 x 22 x 25.2 in); Maximum:<sup>40</sup> 1030 x 808 x 865 mm (40.5 x 31.7 x 34.1 in)</p> <p>M631z: 661 x 658 x 1234 mm (26 x 25.9 x 48.5 in); Maximum:<sup>40</sup> 1030 x 890 x 1500 mm (40.5 x 35 x 59.1 in)</p>	<p>M632h: 512 x 558 x 640 mm (20.15 x 22 x 25.2 in); Maximum:<sup>40</sup> 1030 x 808 x 865 mm (40.5 x 31.7 x 34.1 in)</p> <p>M632ft: 665 x 600 x 1094 mm (26.15 x 26 x 43.2 in); Maximum:<sup>40</sup> 1030 x 890 x 1356 mm (40.5 x 35 x 53.7 in)</p> <p>Flow M632z: 661 x 658 x 1234 mm (26 x 25.9 x 48.5 in); Maximum:<sup>40</sup> 1030 x 890 x 1500 mm (40.5 x 35 x 59.1 in)</p>
<b>Weight (with print cartridges)</b>	<p>M631 dn, Flow M631h: 33.2 kg (73.2 lb)</p> <p>M631z: 62.5 kg (137.8 lb)</p>	<p>M632h: 33.2 kg (73.2 lb)</p> <p>M632ft: 52.5 kg (115.8 lb)</p> <p>Flow M632z: 64.3 kg (141.8 lb)</p>
<b>What's in the box</b>	HP LaserJet Enterprise Multifunction Printer, Power Cord, HP 37A Black Original LaserJet Toner Cartridge (~11,000 pages), <sup>24</sup> CD with software drivers and documentation	
<b>Software included<sup>33</sup></b>	HP Connected, HP Device Experience (DXP), HP PCL 6 (XPS) Printer Driver, HP Software Installer/Uninstaller, Mac OS Welcome Screen (Directs users to <a href="http://123.hp.com">123.hp.com</a> or OS App Source for printer software), Online user manuals	
<b>Downloadable software</b>	HP Easy Start (Guided Software Install for Windows OS and Mac); HP ePrint Software (ePrint Mobile Driver for Windows); HP ePrint Software (for Windows); HP JetAdvantage Security Manager; <sup>7</sup> HP Mobile Printing <a href="http://hp.com/us/en/ads/mobility/overview">hp.com/us/en/ads/mobility/overview</a> ; HP PCL6 (XPS) print driver only (No installer for "Add Printer" installs); HP PCL6 (XPS) print driver with installer; Product Documentation and Support; HP Proxy Agent Software; HP Universal Print Drivers (PCL6 and PS for Windows); Linux/Unix Print Drivers; Mac Software Solution; Printer Administrator Resource Kit; SAP (PS Print Drivers); HP Web Jetadmin; <sup>6</sup> Windows driver only solution; Windows Full Software Solution	
<b>Warranty</b>	One-year, next-business day, onsite warranty. Warranty and support options vary by product, country and local legal requirements. Go to <a href="http://hp.com/support">hp.com/support</a> to learn about HP world-class service and support options in your region.	

# Environmental and power specifications

	HP LaserJet Enterprise MFP M631 series	HP LaserJet Enterprise MFP M632 series
<b>Environmental ranges</b>		
Temperatures	Operating range: 15 to 32.5° C (59 to 90.5° F); Recommended operating range: 15 to 27° C (59 to 80.6° F); Storage: -20 to 40° C (-4 to 104° F)	
Relative Humidity Range	Operating range: 10 to 80% RH; Recommended operating range: 30 to 70% RH; Storage range: 10 to 90% RH	
<b>Acoustic power emissions<sup>41</sup></b>		
Ready mode	M631dn, Flow M631h, M631z: Inaudible	M632h, M632fht: Inaudible Flow M632z: 3.5 B(A)
Active printing	M631dn, Flow M631h, M631z: 6.9 B(A)	M632h, M632fht: 7.0 B(A) Flow M632z: 6.9 B(A)
Active copying	M631dn, Flow M631h: 7.4 B(A) M631z: 7.6 B(A)	M632h, M632fht: 7.4 B(A) Flow M632z: 7.6 B(A)
Active scanning	M631dn, Flow M631h: 7.2 B(A) M631z: 7.3 B(A)	M632h, M632fht: 7.2 B(A) Flow M632z: 7.3 B(A)
<b>Acoustic pressure emissions (bystander)</b>		
Ready mode	M631dn, Flow M631h, M631z: Inaudible	M632h, M632fht: Inaudible Flow M632z: 15 dB(A)
Active printing	M631dn, Flow M631h: 55 dB(A) M631z: 53 dB(A)	M632h: 56 dB(A) M632fht, Flow M632z: 54 dB(A)
Active copying	M631dn, Flow M631h: 59 dB(A) M631z: 60 dB(A)	M632h, M632fht, Flow M632z: 60 dB(A)
Active scanning	<i>All models: 58dB(A)</i>	
<b>Power specifications<sup>42</sup></b>		
Power supply	Built-in 115V or 220V power supply (Not dual voltage, power supply varies by part number with # Option code identifier) 100 V-127 V nominal @ +/-10% (min 90 V, max 140 V); 50-60 Hz nominal +/- 3 Hz (min 47 Hz, max 63 Hz); 12 A 220 V-240 V nominal @ +/-10% (min 198 V, max 264 V); 50-60 Hz nominal +/- 3 Hz (min 47 Hz, max 63 Hz); 6 A	
Power consumption	Printing/copying: 740 watts; Ready: 29 watts; Sleep: 3.3 watts; Auto-off/wake on LAN: 0.8 watts; Manual off: 0.1 watts	
Energy-saving features	HP Auto-On/Auto-Off Technology, <sup>20</sup> Instant-on Technology, <sup>21</sup> Instant-on Copy	
<b>Environmental specifications</b>	ENERGY STAR® certified; Blue Angel compliant; CECP; EPEAT® Silver registered models available <sup>43</sup>	
<b>Typical Electricity Consumption (TEC)<sup>42</sup></b>	2.219 kWh/week (Blue Angel); 2.348 kWh/week (ENERGY STAR®)	2.626 kWh/week (Blue Angel); 2.849 kWh/week (ENERGY STAR)
<b>Safety and regulatory compliance</b>	IEC 60950-1:2005 +A1:2009 +A2:2013 (International); EN60950-1:2006 +A11:2009 +A1:2010 +A12:2011 +A2:2013 (EU); EN 60825-1:2007 / IEC 60825-1:2007 (Class 1 Laser Product); EN 62479:2010 / IEC 62479:2010; Low Voltage Directive 2006/95/EC with CE Mark (Europe); GS Certificate (Germany, Europe); UL/cUL Listed and UC CoC (US/Canada); CAN/CSA C22.2 No. 60950-1-07 2nd Ed. 2011-12; Compliance with Laser safety standards 21 CFR 1040.10 and 1040.11 except for deviations pursuant to Laser notice No. 50, Dated June 24, 2007; Other safety approvals as required by individual countries	
<b>Electromagnetic emission standard</b>	CISPR 22: 2008/EN 55022: 2010 (Class A), EN 61000-3-2: 2006 +A1: 2009 + A2: 2009; EN 61000-3-3 :2008; EN 55024:2010; FCC Title 47 CFR, Part 15 Class A (USA); ICES-003, Issue 4 (Canada); EMC Directive 2004/108/EC with CE Marking (Europe); other EMC approvals as required by individual countries	
<b>Telecom compliance certification</b>	M631z, M632fht, Flow M632z (Telecom wired): ES 203 021; R&TTE Directive 1999/5/EC with CE marking (Europe); FCC Rules and Regulations 47 CFR Part 68; Industry Canada CS03; and other Telecom approvals as required by individual countries.	
	M631z (Telecom wireless): EN301 489-1 v1.9.2/EN 301 489-1v2.2.1 (2012-09) EN300 328 v1.9.1, FCC Title 47 CFR Part 15 Subpart C (section 15.247)/IC:RSS-210 IEC 62311:2007/EN62311:2008 and other Telecom approvals as required by individual countries.	



# Ordering information

Use accessories and supplies specifically designed for the MFP to help provide efficient performance. To order the accessories and supplies listed here, go to [hp.com](http://hp.com). To contact HP by country, please visit [hp.com/go/contact](http://hp.com/go/contact). If you don't have access to the Internet, contact your qualified HP dealer.

<b>MFP</b>	HP LaserJet Enterprise MFP M631dn	J8J63A
	HP LaserJet Enterprise Flow MFP M631h	J8J64A
	HP LaserJet Enterprise MFP M631z	J8J65A
	HP LaserJet Enterprise MFP M632h	J8J70A
	HP LaserJet Enterprise MFP M632fht	J8J71A
	HP LaserJet Enterprise Flow MFP M632z	J8J72A
<b>Supplies</b>	HP 37A Black Original LaserJet Toner Cartridge (~11,000 pages) <sup>24</sup>	CF237A
	HP 37X High Yield Black Original LaserJet Toner Cartridge (~25,000 pages) <sup>24</sup>	CF237X
	HP 37Y Extra High Yield Black Original LaserJet Toner Cartridge (~41,000 pages) <sup>24</sup>	CF237Y
	HP Staple Cartridge Refill (5,000 staples)	J8J96A
<b>Accessories</b>	HP LaserJet 550-sheet paper feeder	J8J89A
	HP LaserJet 1x550-sheet paper feeder with stand and cabinet	J8J91A
	HP LaserJet 1x550 and 2,000-sheet HCl feeder and stand	J8J92A
	HP LaserJet 3x550-sheet paper feeder and stand	J8J93A
	HP LaserJet envelope feeder	J8J90A
	HP Internal USB Ports (AA Module - CSR-A)	B5L28A
	HP Secure High Performance Hard Disk Drive (FIPS - CSR-A)	B5L29A
	HP Foreign Interface Harness (FIH)	B5L31A
	HP LaserJet MFP Analog Fax Accessory 500	CC487A
	HP Jetdirect 2900nw Print Server	J8031A
	HP Jetdirect 3000w NFC/Wireless Accessory <sup>14,31</sup>	J8030A
	HP Trusted Platform Module Accessory	F5S62A
	HP LaserJet Keyboard Overlay Kit Sweden (Flow models only)	A7W14A
	HP LaserJet Keyboard Overlay Kit - Danish/French-Switzerland/German-Switzerland (in the box when ordering BAZ option) (Flow models only)	A7W13A
	HP LaserJet 220v Maintenance Kit (225,000 pages)	J8J88A
	HP 300 ADF Roller Replacement Kit (150,000 pages)	J8J95A
1 GB Memory DIMM Kit	E5K48A	
<b>HP Services</b>	Boost performance—it's your choice. HP Care provides options to help you manage imaging and printing—from Care Pack services to customisable and advisory services. With HP Managed Print Services, we oversee everything for you.	Make sure your imaging and printing investments are protected with Care Pack, part of HP Care. Pick your package of services to keep your MFP running and your business moving. Now your office can spend less time trouble-shooting and more time getting things done. For details, visit <a href="http://hp.com/go/cpc">hp.com/go/cpc</a> . <sup>44</sup>
	HP 3 Year Next Business Day + Defective Media Retention LJ Enterprise MFP M63x Hardware Support	U9NK0E
	HP 5 Year Next Business Day + Defective Media Retention LJ Enterprise MFP M63x Hardware Support	U9NK2E
	HP 1 Year Post-Warranty Next Business Day + Defective Media Retention LJ Enterprise MFP M63x Hardware Support	U9NL8PE
<b>Solutions</b>	HP Web Jetadmin: <a href="http://hp.com/go/wja">hp.com/go/wja</a>	
	HP Universal Print Driver: <a href="http://hp.com/go/upd">hp.com/go/upd</a>	
	HP JetAdvantage Security Manager: <a href="http://hp.com/go/securitymanager">hp.com/go/securitymanager</a>	
	HP LaserJet Fonts, Barcodes, and IPDS Emulation available at <a href="http://hp.com/go/laserjetfonts">hp.com/go/laserjetfonts</a>	
	HP JetAdvantage On Demand Cloud Solutions: <a href="http://hp.com/go/JetAdvantageondemand">hp.com/go/JetAdvantageondemand</a> To learn more about available infrastructure, management, and workflow solutions, visit <a href="http://hp.com/go/printing/solutions">hp.com/go/printing/solutions</a>	

# Appendix A: Control panel features

## Upgrade to a modern interface

The HP LaserJet Enterprise MFP M631/M632 series is powered by HP FutureSmart 4.0 firmware. Its modern, tablet-like interface keeps things simple and intuitive across your fleet of Enterprise devices. A scalable control panel interface improves future extensibility and allows for customisation, along with a robust set of new apps and usability features. You can even customise with your own wallpaper image and company logo. The new Message Center, with more detailed information and helpful animations, makes it easy to address device events. The simplified home screen displays just four core apps by default (three apps for products without fax). Additional apps are easily accessed by swiping right to left, like with a smartphone or tablet.

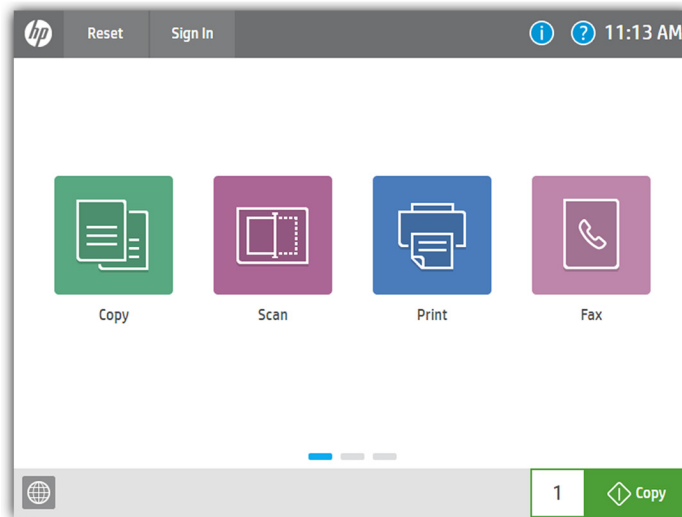

## Edit jobs right at the MFP

The control panel features an enhanced image preview—now for both copies and scans. Right from the device's 20.3 cm colour touchscreen control panel, you can easily preview and edit scans before sending them. You can apply changes (like rotating) to a single page, or to multiple pages at once. Batch separation allows users to create separate PDF or PDF/A files from scanned pages. The Flow MFP M631h and M632z models can also create PDF OCR and PDF/A OCR files.



The new user interface enables **swiping**, **rotate**, and **drag-and-drop** capabilities

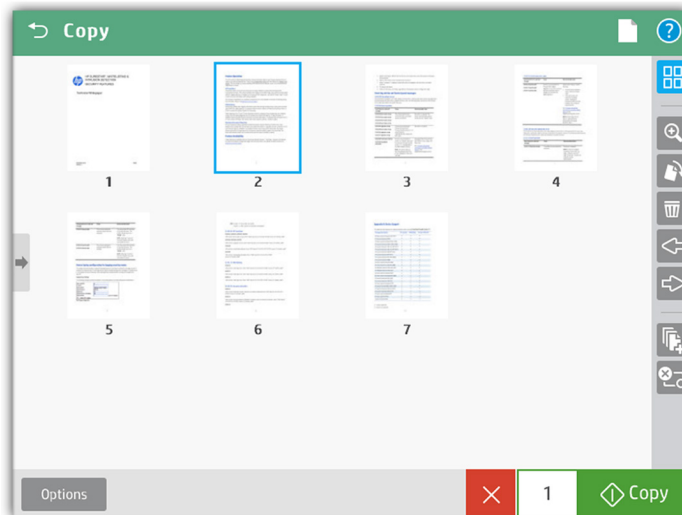

You can start a **preview** prior to committing to the copy job

## Use Quick Sets to launch automated workflows

The MFP's digital sending capability allows users to route documents to a variety of destinations like email recipients, network folders, fax, FTP, a USB device, or Microsoft SharePoint.

Quick Sets automate all of the steps of a complicated workflow and provide easy access to the configurations you use most, such as page size, resolution, and file format. You can also specify security settings, such as encrypted PDFs to be delivered through encrypted and signed emails.

Help users find what they need by moving individual Quick Sets to any screen or folder using the home screen customisation feature. With Quick Sets, IT can promote or block access to certain device features. Calls to the helpdesk can be reduced when users have everything they need and are restricted from accessing settings they shouldn't tamper with.

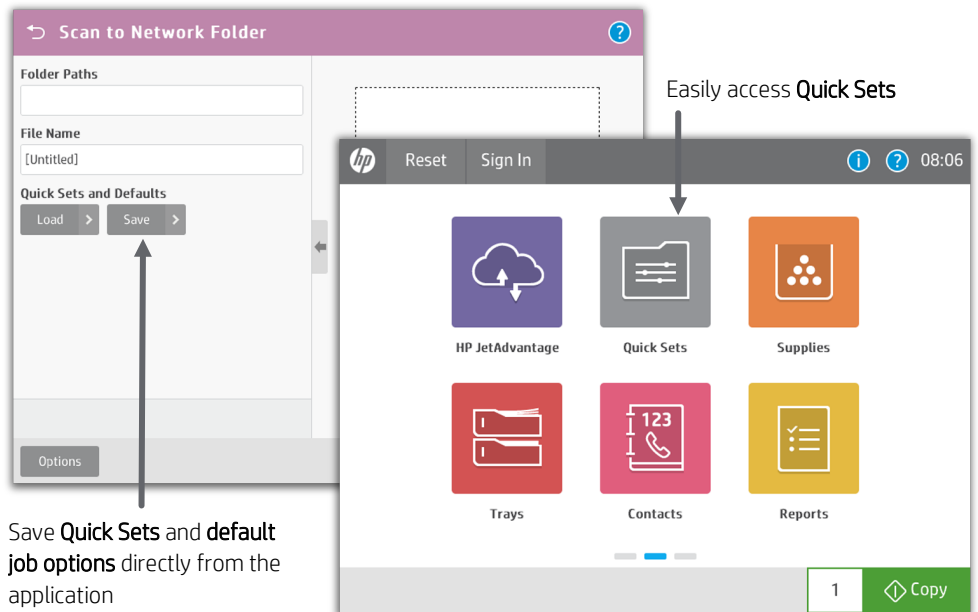

Save **Quick Sets** and **default job options** directly from the application

## Troubleshoot with ease

The HP LaserJet Enterprise MFP M631/M632 series can help save your IT department valuable time when it comes to troubleshooting problems. The Remote Control Panel allows users to operate the user interface remotely, so IT can troubleshoot problems without running to the MFP.<sup>45</sup> Users can also quickly troubleshoot technical issues with HP's innovative, cloud-based Online Help services that are relevant and up to date. Easily solve problems from your PC or mobile device. A Quick Response (QR) code on the touchscreen links to Online Help using smart phones and tablets.<sup>46</sup> You can also find these links in the HP Embedded Web Server event log.

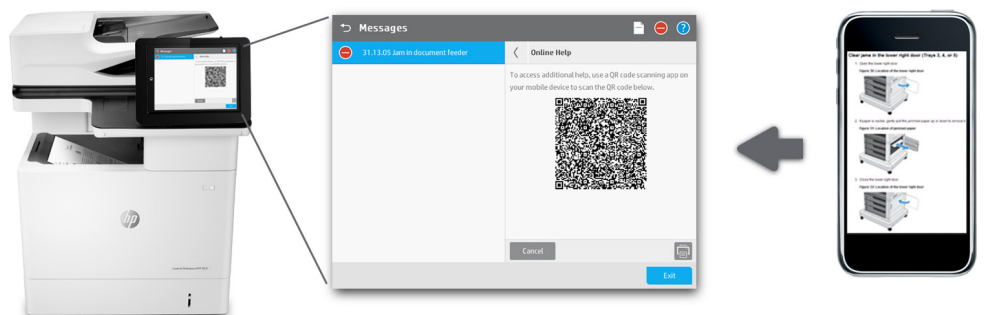

<sup>1</sup> Based on HP review of 2018 published security features of competitive in-class printers. Only HP offers a combination of security features that can monitor to detect and automatically stop an attack then self-validate software integrity in a reboot. For a list of printers, visit [hp.com/go/printersthatprotect](http://hp.com/go/printersthatprotect). For more information: [hp.com/go/printersecurityclaims](http://hp.com/go/printersecurityclaims).

<sup>2</sup> Some features require additional purchase. A FutureSmart service pack update may be required to activate security features. Learn more at [hp.com/go/printsecurity](http://hp.com/go/printsecurity).

<sup>3</sup> The HP High Performance Secure Hard Disk is standard on all models except the M631dn. It can be added to the M631dn with an optional accessory.

<sup>4</sup> Solutions deployed through the Hardware Integration Pocket (HIP) may require additional purchase.

<sup>5</sup> Use of the optional HP Trusted Platform Module accessory may require a firmware upgrade.

<sup>6</sup> HP Web Jetadmin is available for download at no additional charge at [hp.com/go/wia](http://hp.com/go/wia).

<sup>7</sup> HP JetAdvantage Security Manager must be purchased separately. For details, see [hp.com/go/securitymanager](http://hp.com/go/securitymanager).

<sup>8</sup> HP JetAdvantage Secure Print works with any network-connected printer or MFP. On-device authentication is available for many HP LaserJet, PageWide, and OfficeJet Pro devices and selected non-HP devices. Some devices may require a firmware upgrade. Internet connection required for cloud storage and retrieval of print jobs. Print-job release from a mobile device requires a network connection and QR code. For more information and a list of supported printers and MFPs, see [hp.com/go/JetAdvantageSecurePrint](http://hp.com/go/JetAdvantageSecurePrint).

<sup>9</sup> Colour access control capabilities vary from device to device.

<sup>10</sup> Measured using ISO/IEC 17629. Exact speed varies depending on the system configuration, software application, driver, and document complexity. Learn more at [hp.com/go/printerclaims](http://hp.com/go/printerclaims).

<sup>11</sup> Measured after 15 minutes in sleep. Exact speed varies depending on the system configuration, software application, driver, document complexity, and time in sleep.

<sup>12</sup> Measured using ISO/IEC 24734; excludes first set of test documents. For more information, see [hp.com/go/printerclaims](http://hp.com/go/printerclaims). Exact speed varies depending on the system configuration, software application, driver, and document complexity.

<sup>13</sup> Measured using ISO 24734 Feature Test, A5 Landscape Feed. Speed may vary based on content, PC, media orientation, and media type. A5 landscape printing cannot be duplexed.

<sup>14</sup> Wi-Fi Direct printing is embedded in the HP LaserJet Enterprise M631z model. All other models can add wireless direct with purchase of the optional HP Jetdirect 3000w NFC/Wireless Direct Accessory. Mobile device needs to be connected directly to the signal of a Wi-Fi Direct® supported MFP or printer prior to printing. Depending on mobile device, an app or driver may also be required. For details, see [hp.com/go/mobileprinting](http://hp.com/go/mobileprinting). Wi-Fi Direct is a registered trademark of Wi-Fi Alliance®.

<sup>15</sup> Bluetooth® Low Energy is standard only on the HP LaserJet Enterprise MFP M631z model, and it cannot be added to other models.

<sup>16</sup> Requires purchase of server software such as HP JetAdvantage Connect or HP Access Control Secure Pull Printing. Learn more at [hp.com/go/businessmobileprinting](http://hp.com/go/businessmobileprinting).

<sup>17</sup> Purchase of optional paper trays required to reach maximum input capacity. The M631z has a maximum input capacity of 2,850 sheets, the M632fht has a maximum input capacity of 1,750 sheets, and all other models have a maximum input capacity of 3,750 sheets.

<sup>18</sup> Standard and optional paper-handling accessories vary by model. See Paper-handling accessories, page 9, for details.

<sup>19</sup> Energy claim based on TEC data reported on [energystar.gov](http://energystar.gov) as of January 2017. Data normalised to determine energy efficiency of in-class laser printers with published speeds of 55 to 65 ppm (letter). Subject to device settings. Actual results may vary.

<sup>20</sup> HP Auto-On/Auto-Off Technology capabilities are subject to printer and settings.

<sup>21</sup> Compared with products that use traditional fusing.

<sup>22</sup> Based on ISO/IEC 19752 cartridge yields for HP 81X High Yield Black Original LaserJet Toner cartridges compared with HP 37Y Extra High Yield Black Original LaserJet Toner cartridges. Learn more at [hp.com/go/learnaboutsupplies](http://hp.com/go/learnaboutsupplies).

<sup>23</sup> HP 37X High Yield and 37Y Extra High Yield Black Original LaserJet Toner cartridges are not included in printer purchase; purchase separately. Learn more at [hp.com/go/learnaboutsupplies](http://hp.com/go/learnaboutsupplies).

<sup>24</sup> Toner cartridge yields established using ISO/IEC test standards. Actual yields and costs vary considerably depending on images printed, number of colour pages printed, and other factors.

<sup>25</sup> Scan speed measured from ADF at default 300 dpi (black-and-white, greyscale, and colour). Actual processing speeds may vary depending on scan resolution, network conditions, computer performance, and application software.

<sup>26</sup> The Recommended Monthly Scan Volume (RMSV) is up to 44,500 for the Flow M631h and Flow M632z models and up to 23,750 pages for all other models. HP recommends that the number of scanned pages per month be within the stated range for optimum device performance, based on factors including supplies replacement intervals and device life over an extended warranty period.

<sup>27</sup> The pull-out keyboard and HP EveryPage are only available on the HP LaserJet Enterprise Flow MFP M631h and Flow MFP M632z models.

<sup>28</sup> Fax capability is optional on the HP LaserJet Enterprise MFP M631dn, MFP Flow M631h, and MFP M632h models.

<sup>29</sup> An administrator must enable the easy-access USB port before use.

<sup>30</sup> The MFP is limited to a total of six input feeders. The HP LaserJet Enterprise MFP M631z, M632fht, and Flow M632z can add up to one additional optional 550-sheet paper feeder or envelope feeder. The M631dn, Flow M631h, and M632h can add up to four additional optional 550-sheet paper feeders; or, they can add one of the other optional accessories (1x550-sheet paper feeder and stand, 3x550-sheet paper feeder with stand and cabinet, or 1x550 and 2,000-sheet HCL feeder and stand) and up to one additional optional 550-sheet paper feeder or envelope feeder. The optional maximum configurations may raise glass height above best customer usability standards.

<sup>31</sup> Touch-to-print capability can be added to all models (except M631z) with purchase of the optional HP Jetdirect 3000w NFC/Wireless Direct Accessory. Mobile device must support Near Field Communication (NFC)-enabled printing. For more information, see [hp.com/go/businessmobileprinting](http://hp.com/go/businessmobileprinting).

<sup>32</sup> All models can add wireless networking with the purchase of the HP Jetdirect 2900nw Print Server. Wireless performance is dependent on physical environment and distance from access point, and may be limited during active VPN connections.

<sup>33</sup> Scan software not included in box. HP Scan and TWAIN driver available for download at [hp.com/support](http://hp.com/support).

<sup>34</sup> Based on standard ITU-T test image #1 at standard resolution and MMR encoding, the HP fax device can transmit at 3 sec/page for V.34 and 6 sec/page for V.17.

<sup>35</sup> HP recommends that the number of printed pages per month be within the stated range for optimum device performance, based on factors including supplies replacement intervals and device life over an extended warranty period.

<sup>36</sup> Duty cycle is defined as the maximum number of pages per month of imaged output. This value provides a comparison of product robustness in relation to other HP LaserJet or HP Color LaserJet devices, and enables appropriate deployment of printers and MFPs to satisfy the demands of connected individuals or groups.

<sup>37</sup> Supports the following devices running iOS 4.2 or later: iPad, iPad 2, iPhone (3GS or later), iPod touch (3rd generation or later). Works with HP's AirPrint-enabled printers and requires the printer be connected to the same network as your iOS device. Wireless performance is dependent on physical environment and distance from the access point.

<sup>38</sup> Printer requires ePrint account registration. App or software may be required. Wireless operations are compatible with 2.4 GHz operations only. Learn more at [hp.com/go/mobileprinting](http://hp.com/go/mobileprinting).

---

<sup>39</sup> Full solution software available only for Windows 7 and newer, UPD software available only for Windows 7 and newer, HP Software for Mac and Windows is no longer included on the CD, but can be downloaded from [123.hp.com](http://123.hp.com). Legacy Windows Operating Systems (XP, Vista, and equivalent servers) get print and Scan drivers only with a reduced feature set, Windows RT OS for Tablets (32- and 64-bit) uses a simplified HP print driver built into the RT OS.

<sup>40</sup> Maximum dimensions measured with right side jam access door open, left side cartridge door open, all trays open and extended, and ADF open.

<sup>41</sup> Acoustic values are subject to change. For current information, see [hp.com/support](http://hp.com/support).

<sup>42</sup> Power requirements are based on the country/region where the printer is sold. Do not convert operating voltages. This will damage the printer and void the product warranty. ENERGY STAR® value typically based on measurement of 115V device.

<sup>43</sup> EPEAT® registered where applicable. EPEAT registration varies by country. See [epeat.net](http://epeat.net) for registration status by country.

<sup>44</sup> Service levels and response times may vary depending on your geographic location. Service starts on date of hardware purchase. Restrictions and limitations apply. For details, visit [hp.com/go/cpc](http://hp.com/go/cpc).

<sup>45</sup> Availability dependent on firmware or software updates or upgrades.

<sup>46</sup> Online Help must be enabled on the printer or MFP. Mobile device must have an Internet connection to access online services.

Sign up for updates  
[hp.com/go/getupdated](http://hp.com/go/getupdated)



---

© Copyright 2017-2019 HP Development Company, L.P. The information contained herein is subject to change without notice. The only warranties for HP products and services are set forth in the express warranty statements accompanying such products and services. Nothing herein should be construed as constituting an additional warranty. HP shall not be liable for technical or editorial errors or omissions contained herein.

Apple, AirPrint, iPad, iPhone, and iPod are trademarks of Apple Inc. Android and Google Cloud Print are trademarks of Google Inc. ENERGY STAR is a registered trademark owned by the U.S. Environmental Protection Agency. Microsoft, Windows, and Windows Vista are U.S. registered trademarks of the Microsoft group of companies. Bluetooth is a trademark owned by its proprietor and used by HP Inc. under license.

4AA6-9404EEE, January 2019, Rev. 2

