

BLACK+[®] DECKER



**4.5 CU. FT.
FRONT LOAD WASHER**

INSTRUCTION MANUAL

**CATALOG NUMBER
BFLW45M**

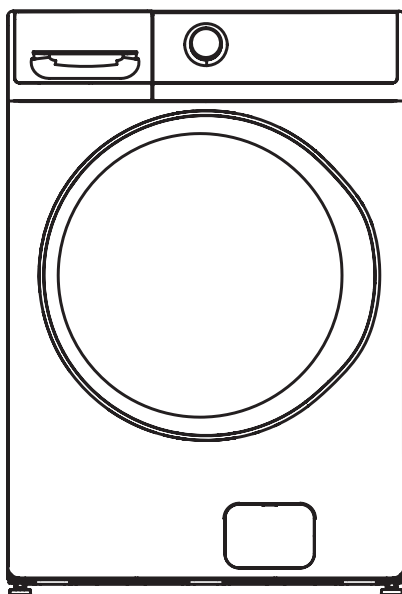

Thank you for choosing BLACK+DECKER!

**PLEASE READ BEFORE RETURNING THIS PRODUCT FOR
ANY REASON.**

If you have a question or experience a problem with your BLACK+DECKER purchase, go to www.blackanddecker.com/instantanswers.

If you can't find the answer or do not have access to the Internet, call 844-299-0879 from 10:30 a.m. to 6:30 p.m. EST Mon. - Fri. to speak with an agent. Please have the catalog number available when you call.

SAVE THIS MANUAL FOR FUTURE REFERENCE.



PRODUCT REGISTRATION

Thank you for purchasing our BLACK+DECKER product. This easy-to-use manual will guide you in getting the best use of your product.

Remember to record the model and serial numbers. They are on a label on the back of the product.

Model number

Serial number

Date of purchase

Staple your receipt to your manual.
You will need it to obtain warranty service.

SAFETY INFORMATION

DANGER

DANGER - Immediate hazards which **WILL** result in severe personal injury or death

WARNING

WARNING - Hazards or unsafe practices which **COULD** result in severe personal injury or death

CAUTION

CAUTION - Hazards or unsafe practices which **COULD** result in minor personal injury

IMPORTANT SAFETY INSTRUCTIONS

WARNING

When using electrical appliances, basic safety precautions should be followed, including the following:

-  **WARNING:** To reduce the risk of fire, electric shock, or injury to persons when using your appliance, follow basic precautions, including the following:
1. READ ALL INSTRUCTIONS BEFORE USING THE APPLIANCE.
 2. Do not wash articles that have been previously cleaned in, washed in, soaked in, or spotted with gasoline, dry-cleaning solvents, or other flammable or explosive substances, as they give off vapors that could ignite or explode.
 3. Do not add gasoline, dry-cleaning solvents, or other flammable or explosive substances to the wash water. These substances give off vapors that could ignite or explode.
 4. Under certain conditions, hydrogen gas may be produced in a hot-water system that has not been used for 2 weeks or more. **HYDROGEN GAS IS EXPLOSIVE.** If the hot-water system has not been used for such a period, before using a washing machine, turn on all hot-water faucets and let the water flow from each for several minutes. This will release any accumulated hydrogen gas. As the gas is flammable, do not smoke or use an open flame during this time.
 5. Always unplug the washing machine from the power supply before attempting any service. Disconnect the power cord by grasping the plug, not the cord.
 6. To reduce the risk of fire, any articles that have traces of any flammable substance, such as vegetable oil, cooking oil, petroleum based oils or distillates, waxes, fats, etc., must not be placed in the washing machine. These items may contain flammable substances that, even after washing, may smoke or catch fire.
 7. Never place items in the washer that have been dampened with gasoline or any combustible or explosive substance. Do not wash anything that has been soaked in or spotted with any type of oil (including cooking oils). Doing so can result in fire, explosion, or death.
 8. Do not allow children to play on or in the appliance. Close supervision is necessary when the appliance is used near children.
 9. Pets and kids may climb into the machine. Check the machine before every operation.

SAFETY INFORMATION

10. Glass door or protector may be very hot during operation. Keep kids and pets far away from the machine during operation.
11. This machine is not intended for use by persons (including children) with reduced physical, sensory or mental capabilities, or lack of experience and knowledge, unless they have been given supervision or instruction concerning use of the machine by a person responsible for their safety.
12. Kids should be supervised to ensure that they do not play with the machine.
13. When children become old enough to operate the appliance, it is the legal responsibility of parents or legal guardians to ensure that they are instructed in safe practices by qualified persons.
14. Do not machine wash fiberglass materials (such as curtains and window coverings that use fiberglass materials). Small particles may remain in the washing machine and stick to fabrics in subsequent wash loads causing skin irritation.
15. Before appliance is removed from service or discarded, remove door.
16. Do not reach into the appliance if the tub or agitator is moving.
17. Do not install or store this appliance where it will be exposed to the weather.
18. Do not tamper with controls.
19. Do not repair or replace any part of the appliance or attempt any servicing unless specifically recommended in the user-maintenance instructions or in published user-repair instructions that you understand and have the skills to carry out.
20. Pull out its plug from the power socket before cleaning or maintenance.
21. Make sure that all pockets are emptied from articles of clothing before placing in machine.
22. Sharp and rigid items such as coin, brooch, nail, screw or stone etc. may cause serious damage to this machine.
23. Pull out its plug and cut off water supply after operation.
24. Please check whether the water inside the drum has been drained before opening its door. Please do not open the door if there is any water visible.
25. If the plug (power cord) is damaged, it shall be replaced by the manufacturer or a service agent to avoid any danger.
26. Take care that power voltage and frequency shall be identical to those of washing machine.
27. Do not use any socket with rated current less than that of washing machine. Never pull out power plug with wet hand.
28. To ensure your safety, power cord plug must be inserted into a grounded three pole socket. Check carefully and make sure that your socket is properly and reliably grounded. See page 19 for additional information about grounding.
29. This machine shall be repaired only by an authorized service center and only authentic accessories can be used.
30. An appliance shall be clearly and permanently marked with a warning that the appliance is intended for use only with fabrics that have been washed with water as a cleaning agent.

SAFETY INFORMATION

31. If connected to a circuit protected by fuses, use time-delay fuses with this appliance.
32. Do not use fabric softeners or products to eliminate static unless recommended by the manufacturer of the fabric softener or product.

SAVE THESE INSTRUCTIONS

HOUSEHOLD USE ONLY

IMPORTANT INSTALLATION INFORMATION

1. This unit must be properly installed and located according to the installation instructions before it is used.
2. Store and install the washer where it will not be exposed to temperatures below freezing or exposed to outdoor weather conditions. This could damage the unit and void the warranty.
3. The (red) hot water hose should be connected to the (red) hot water inlet and the (blue) cold water hose should be connected to the (blue) cold water inlet.
4. The washer must be plugged into an appropriate outlet that is properly installed and grounded in accordance with all local codes and ordinances. Follow all installation instructions.
5. The unit should be installed on a level floor with a maximum slope of 1" (25 mm) over a 3 ft distance.

WHEN NOT IN USE

Turn off the water supply when the unit is not in use in case of leaking or ruptured hoses. It is recommended to replace the hoses every 5 years.

BEFORE FIRST USE

Before washing clothes for the first time, the washing machine should be operated without clothing added.

1. Connect power source and water supply.
2. Put a small amount of detergent into the dispenser and close the dispenser.
3. Close the Door.
4. Select a wash cycle using the dial.
5. Press ON/OFF.
6. Press the Start/Pause button.

NOTE: If water leaks while water is being supplied or drained, check the water connections.

If the washer rocks and vibrates excessively, level your washer again. During rinse cycle when washer is spinning at a very high speed, some vibration is normal.

NOTE: For best performance do not load the tub more than $\frac{3}{4}$ full of dry clothes. DO NOT OVERLOAD.

SET UP & USE

QUICK START GUIDE

Default settings can be changed. See USING THE CONTROL PANEL section for more details.

1. Add HE detergent to the detergent dispenser according to detergent manufacturer's instructions. HE detergent pods can be added to the wash tub before adding clothes.
Add optional pre-wash and/or fabric softener to the detergent dispenser.
2. **Load clothing, maximum full.**
3. Close the Door.
NOTE: Unit will not start with the door open.
4. Press ON/OFF to power on the unit.
5. Turn the selector dial to a cycle such as NORMAL/COTTON.
Defaults are set for each wash cycle. These default settings can be changed on the control panel.
6. Press the Start/Pause button.
For more details on cycles and default setting refer to the wash program chart.

SET UP & USE

CONTROL PANEL

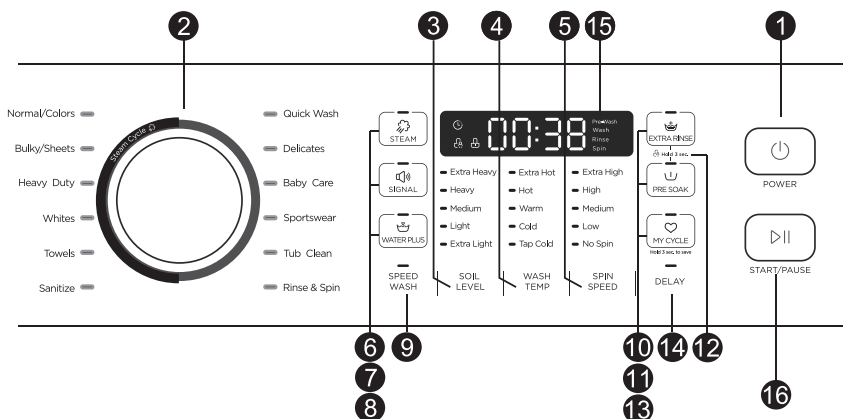

1. POWER

Press to turn the POWER ON. The control panel lights will illuminate. Press again to turn it OFF.

2. Selector Dial

Turn the dial to select the cycle.

3. Soil Level

Press SOIL LEVEL continuously to scroll through the selections: Extra Heavy, Heavy, Medium, Light, Extra Light. The selected soil level will be illuminated on the LED Display. Heavy soil levels will increase wash time.

4. Wash Temp

Select the temperature for the wash cycle from Extra Hot, Hot, Warm, Cold or Tap Cold options by pressing WASH TEMP continuously. The Pre-wash rinse water is cold to prevent stains from setting.

5. Spin Speed

Press SPIN SPEED continuously to choose Extra High, High, Medium, Low or no spin speeds. Refer to the manufacturer's care label when selecting the spin speed. Higher spin speeds remove more water but may increase the possibility of wrinkles on some fabrics.

NOTE: Not all SOIL LEVEL, WASH TEMP and SPIN SPEED options are available for each cycle. Please refer to program chart.

6. Steam

Add steam to assist with loosening stains to Normal/Colors, Bulky/Sheets, Heavy Duty, Whites, Towels or Sanitize Cycles. After selecting the wash cycle press the STEAM button before pressing the START/PAUSE button.

7. Signal

Press to turn the sounds on the control panel on/off when cycles are selected and buttons are pressed. Press and hold to control the volume of the sound.

NOTE: 2 simultaneous beeps when something is selected indicate that the option is not available for a specific setting.

SET UP & USE

8. Water Plus

When selected, it will increase the water level of the wash cycle in Bulky/Sheets, Heavy Duty, Whites, Towels, Sanitize, Delicates, Baby Care and Sportswear Cycles. After selecting the wash cycle press the WATER PLUS before pressing the START/PAUSE button.

9. Speed Wash

When selected, the wash, rinse and spin cycles in Bulky/Sheets, Heavy Duty, Whites, Towels, Sanitize, Delicates, Baby Care and Sportswear Cycles will be optimized. Wash temperatures may be raised slightly. After selecting the wash cycle press SPEED WASH make adjustments to SOIL LEVEL, WASH TEMP and SPIN SPEED before pressing the START/PAUSE button.

10. Extra Rinse

Select to add extra rinse time.

11. Pre Soak

This function begins with a brief tumble and then proceeds to soak the clothes with water and detergent that is dispensed from the detergent compartment. The wash cycle will begin after the pre-soak time. An additional 10-20 minutes will be added to the overall wash time. Press the PRE SOAK button before pressing the START/PAUSE button.

12. Control Lock

Use this option to disable the controls except for the ON/OFF. This feature can prevent children from changing cycles. After a wash cycle has started, press and hold the EXTRA RINSE and PRE SOAK buttons for 3 seconds.

To unlock the washer controls press and hold the EXTRA RINSE and PRE SOAK buttons for 3 seconds.

NOTE: The POWER button can still be used if the controls are locked.

13. My Cycle

This is a setting to save a frequently used program. Select the wash cycle, soil level, spin speed and wash temperature setting. Press and hold the MY CYCLE button for 3 seconds to save the settings. A beep will sound to indicate the settings are saved and the MY CYCLE button will be illuminated.

To use the custom settings, press and hold the MY CYCLE button for 3 seconds before washing a cycle. Wash options cannot be changed once the cycle has started. If selections are changed prior to starting the cycle MY CYCLE will be deactivate and the light will turn off.

To change the MY CYCLE setting, make new selections and press and hold the MY CYCLE button.

14. Delay

To delay the start of your washer up to 24 hours, press the DELAY button to activate after the wash cycles have been selected.

The number shown on the digital display will indicate when the wash cycle will start. 1 hour will be added to the start time each time you press the Delay button up to 24 hours. Once the delay time has been selected, press START/PAUSE to activate. Pressing the Delay button to exceed 24 hours until the display indicates OH will deactivate the delay function and the display will turn off.

To cancel the Delay Start function after the wash program has started, press On/Off.

NOTE: In case of disruption of power supply while operating the program, Press Start/Pause to resume.

SET UP & USE

15. Digital Display

Indicates remaining cycle time, delay start time and error codes. For each cycle time the display will show the remaining time counting down until it reaches 0:00 indicating the end of the cycle.

16. START/PAUSE

Press START/PAUSE to start a cycle after all settings are programmed.

Press START/PAUSE to pause a cycle and to add a garment.

Press START/PAUSE to add a garment

A garment can be added to the load in the beginning of a cycle. Press START/PAUSE, then open the door. Add the item, close the door, and then press the START/PAUSE button again to resume the cycle.

NOTE: A garment can be added when the water level reaches just below the door. Once the water level becomes elevated, the door will not open and should not be forced.

⚠ CAUTION: Do not attempt this function when there is hot water in the tub. The door will not open and should not be forced. Attempting to force the door to open could cause damage to the unit.

NOTE:

During some cycles the washer will drain first, then unlock the door when it is paused. The washer performs automatic systems checks after pressing START/PAUSE. The sound of the door locking and unlocking can be detected. This is normal.

Normal/ Colors	For heavily to lightly soiled colorfast cottons, household linens, and clothes. NOTE: This is the most common cycle.
Bulky/ Sheets	For large items such as comforters, blankets, small rugs and bulky items.
Heavy Duty	Washing large and heavy items to be washed in hot temperatures.
Whites	Washing large and heavy.
Towels	For items such as towels, sheets, pillowcases and dish towels
Sanitize	For heavily soiled items.
Quick Wash	For lightly soiled items needed in a hurry. Cycle time is approximately 40 minutes, depending on selected options.
Delicates	For delicate, washable fabrics made of silk, satin, sythetic, fibers or blended fabrics.
Baby Care	This cycle has a longer rinse time to remove detergent residue.
Sportswear	Removes odor and soil from activewear.
Tub Clean	Use for cleaning the basket of residue and odor. Recommended use of at least once per month. NOTE: Never load Laundry while using tub clean. The laundry may become damaged See the Care and Cleaning section.
Rinse & Spin	To quickly rinse and spin any items at any time.

SET UP & USE

WASH PROGRAM CHART

	Default wash time	Temperature					Spin Speeds				
		Tap cold	Cold	Warm	Hot	Extra Hot	No Spin	Low	Med	High	Extra High
Normal/Colors	1:05	○	○	○	●	○	○	×	○	●	○
Bulky/Sheets	1:14	○	●	○	○	×	○	○	○	●	○
Heavy Duty	1:31	○	○	○	●	○	○	○	○	●	○
Whites	1:03	○	○	○	●	○	○	○	○	●	○
Towels	0:59	○	○	○	●	○	○	○	○	●	○
Sanitize	2:09	×	×	×	×	●	○	○	○	●	○
Rinse & Spin	0:20	×	×	×	×	×	○	○	○	●	○
Tub Clean	1:31	×	×	×	×	●	×	×	×	×	×
Sportswear	0:54	○	○	●	○	×	○	○	○	○	●
Baby Care	1:28	○	○	○	●	○	○	○	○	●	○
Delicates	0:52	○	○	●	×	×	○	○	●	○	×
Quick Wash	0:30	○	○	●	○	×	○	○	●	×	×

	Soil Level					Delay	Extra Rinse	PRE SOAK	My Cycle
	Extra Light	Light	Med	Heavy	Extra Heavy				
Normal/Colors	○	○	●	○	○	○	○	○	○
Bulky/Sheets	○	○	●	○	○	○	○	○	○
Heavy Duty	○	○	○	○	●	○	○	○	○
Whites	○	○	●	○	○	○	○	○	○
Towels	○	○	●	○	○	○	○	○	○
Sanitize	○	○	○	○	●	○	○	○	○
Rinse & Spin	×	×	×	×	×	○	×	×	○
Tub Clean	×	×	×	×	×	○	×	×	×
Sportswear	○	○	●	○	○	○	○	○	○
Baby Care	○	○	●	○	○	○	○	○	○
Delicates	○	○	●	○	○	○	○	×	○
Quick Wash	●	×	×	×	×	○	×	×	○

Note: Wash times are automatically adjusted when default settings are changed.

●Default ○Optional Selection ×Option is not available

SET UP & USE

NOTE: In case of disruption of power supply while operating the program, Press Start/Pause to resume.

USING THE WASHER

- ⚠ WARNING:** Never insert hands inside washer until drum stops spinning.
- Do not insert any fabric with gasoline, petroleum, benzene, paint thinner, alcohol or any other flammable substances.
 - Do not put oil soaked items in the washer.
 - Do not attempt to wash items with plastic, foam or rubber.
 - Never keep clothing in the tub for long periods of time. This can cause mildew, wrinkling etc.

Detergent

1. This washer is designed for high efficiency (HE) detergent only, to avoid excessive sudsing.
2. Add the manufacturer's recommended amount of detergent directly into the detergent compartment before starting your washer.
3. Always reduce the amount of detergent if the load is small or lightly soiled or if your water is very soft. Never use more than the maximum amount recommended by the detergent manufacturer.

Detergent Dispenser

Pull out the drawer. After adding detergents and fabric softeners, slowly close the drawer. Closing it too quickly could result in early dispensing of the detergent or fabric softener.

Detergent Usage

Types of Detergent

Use only HE (High Efficiency) liquid or powdered detergent in the dispenser.

Detergent is released at the beginning of the wash cycle.

Use the recommended amount of detergent from the detergent manufacturer.

Adjust according to the hardness of your water.

HE laundry pods should be placed in the washer drum before filling with clothes.

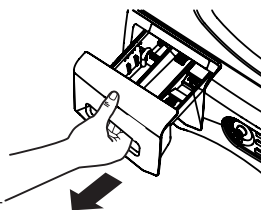

Powdered Detergent

Remove the selection insert and keep it in a safe place outside the washer when using powdered detergent.

1X: Smallest amount

Liquid HE Detergent

There are compartments for different amounts of liquid detergent:

1X: Smallest amount

2X: Most commonly used amount

3X: Largest amount

Using more detergent than recommended can lead to over sudsing, more residue on clothes, and buildup in the washer.

2X: Most commonly used amount

3X: Largest amount

Remove for powder detergent

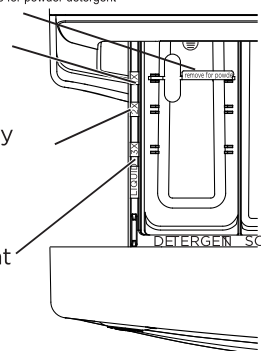

SET UP & USE

Liquid Bleach

Pour the recommended amount of liquid bleach (not to exceed 1/3 cup or 80 mL) into the compartment labeled "LIQUID BLEACH."

Overfilling can cause early dispensing, which could damage clothes.

NOTE: Do not use powdered bleach in the liquid bleach dispenser.

Fabric Softener

If you wish to use fabric softener, pour the manufacturer's recommended amount of liquid fabric softener into the compartment labeled "FABRIC SOFTENER." Dilute with water to the maximum fill line.

Use only liquid fabric softener in the dispenser.

NOTE: Do not pour fabric softener directly on the wash load to avoid staining clothes.

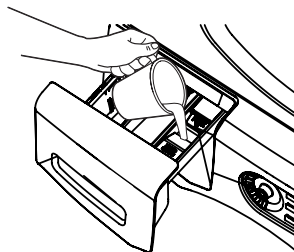

Liquid Bleach Compartment

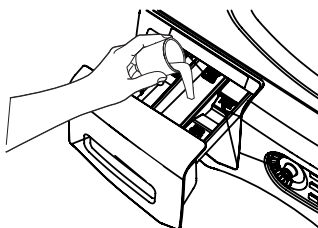

Fabric Softener Compartment

SET UP & USE

SORTING AND LOADING

1. Before loading your laundry, be sure to take out coins, keys and other hard objects, and fasten all hooks and zippers.
2. Follow manufacturer's instructions on clothing tag for washing instructions. Sort laundry according to color (light, medium, dark), Fabric type, (delicates, permanent press items) required wash temperature, soil level etc., Washing items that are not color safe can discolor the other items in the load. Mixing colors can cause the dyes to bleed into the other clothes.
3. Items with embroidery or buttons should be turned inside out.
4. Clothes with hooks or zippers can be washed in a mesh bag as to not get caught on other clothing or scratch the drum.
5. Items that produce a lot of lint should be washed separate.
6. Single heavy items can cause the load to be unbalanced. If the washer vibrates and makes loud sound press start/pause to redistribute the load.
7. Do not load more than full of dry clothes.

CLEANING AND CARE

CLEANING AND MAINTENANCE

⚠ WARNING: Unplug the power cord before cleaning any part of the unit.

The washer should be cleaned regularly. Failure to maintain the unit in a clean condition could lead to deterioration of the surface which could adversely affect the life of the appliance. Do not use harsh chemicals or solvents on any part of the machine or pour water or cleaner directly on it.

CLEANING THE EXTERIOR

Clean with a soft, damp cloth or a mild soap and water solution. Do not use abrasive powders or pads. Do not spray cleaners directly onto the control panel.

CLEANING THE INTERIOR

Select the Tub Clean Cycle and operate the washer without any laundry loaded. 1 cup of bleach can be added directly into the tub. Tub cleaning tablets or powder can be used according to manufacturer's instructions. The tub clean cycle will take about 90 minutes. Do not interrupt the cycle.

Metal objects (safety pins, hair pins, etc.) in the tub may scratch the surface of the tub and cause it to rust. If rust appears on the surface of the tub, apply a neutral cleansing agent to the surface and use a sponge to clean it. Never use a metal brush or scouring pad to clean.

CLEANING THE DETERGENT DISPENSER

1. Open the Detergent dispenser and press down as shown by the arrow.

2. Lift up the clip and remove the cover.

Detergent and fabric softener may build up in the dispenser drawer.

Residue should be removed once or twice a month.

Lock tab is visible only after drawer has been pulled open.

Remove the drawer by first pulling it out until it stops. Then reach back into the left rear corner of the drawer cavity and press down firmly on the lock tab, pulling out the drawer.

3. Rinse with water.

4. Replace the cover and push the dispenser back to its original position.

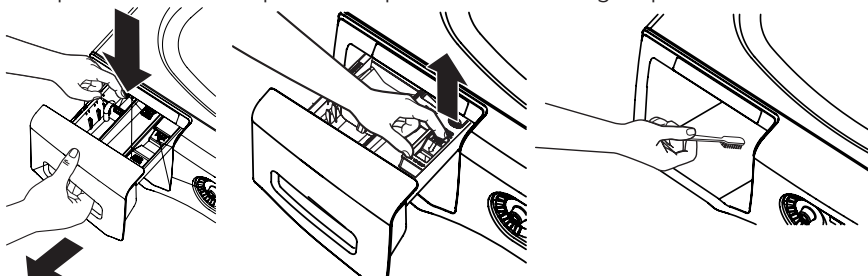

CLEANING AND CARE

CLEANING THE INLET FILTER

Shut off the water supply and disconnect the inlet hose. Pull out the filter with pliers, removing as shown. Clean the filter and reinstall it.

Reconnect the inlet hose.

Turn on the water supply and make sure there is no water leakage.

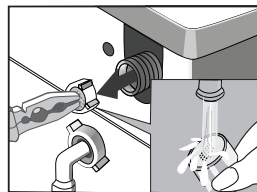

Drain pump filter:

The drain pump filter collects lint and small items so it does not pass through the drain. It should be cleaned approximately once a month depending on frequency of use.

If the washer does not empty or spin properly or if it makes an unusual noise during draining, there may be an obstruction.

⚠ WARNING: The drain pump filter should not be accessed while the unit is operating or cycle has just completed. There may be hot water in the pump. Allow time for water to cool before accessing.

⚠ WARNING: When cleaning the pump filter be aware that there may be residual water remaining even after draining cycle has finished. To avoid spills, place a tray underneath the compartment.

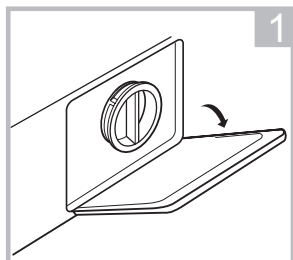

To access the drain pump filter, open the compartment on the bottom right of the machine using a flat head screwdriver, in the notch on the door.

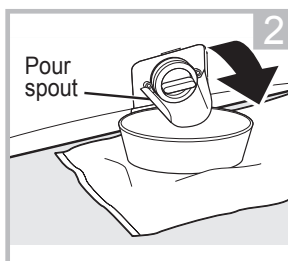

Pull down the pour spout.

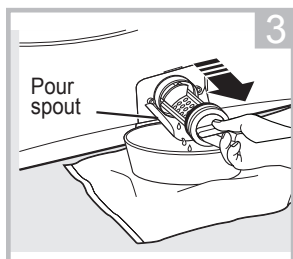

Turn the pump filter counterclockwise to remove. Pull out slowly to allow the water to drain. Clean the debris from the filter.

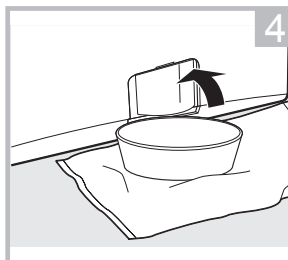

To re-insert the pump filter, turn it clockwise. Tighten securely. Push the pour spout back into place. Close the compartment.

CLEANING AND CARE

CLEANING THE DOOR GASKET

Open the washer door. Using both hands, press down the door gasket. Remove any foreign objects trapped inside the gasket. Wipe with a soft cloth. Make sure there is nothing blocking the holes behind the gasket.

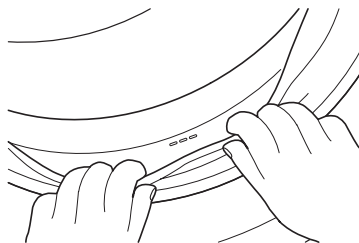

STORAGE:

Do not store the washer in any area that it can be exposed to outdoor weather or cold temperatures that would cause pipes to freeze. For long term storage, or if washer will not be used for a long period of time, disconnect the power supply. Disconnect all the hoses and drain. Clean inside of the unit and keep door open until dried thoroughly, clean all filters.

INSTALLATION INSTRUCTIONS

INSTALLATION WARNINGS AND PRECAUTIONS

WARNING:

1. Plug the power cord into an AC 120V/60Hz wall socket rated at 15 amps or higher. Use the socket for this washer only.
2. Do not use an extension cord.
 - Sharing a wall socket with another appliance, using a power strip, or extending the power cord may result in electric shock or fire.
 - Do not use an electric transformer. It may result in electric shock or fire.
 - Ensure that the power voltage, frequency, and current match the product's specifications. Failing to do so may result in electric shock or fire.
3. Have this appliance installed by a qualified technician or service company.
 - Failing to do so may result in electric shock, fire, explosion, problems with the product, or injury.
4. Remove all foreign substances such as dust or water from the power plug terminals and contact points using a dry cloth on a regular basis.
 - Unplug the power plug and clean it with a dry cloth.
 - Failing to do so may result in electric shock or fire.
5. Plug the power plug into the wall socket firmly. Do not use a damaged power plug, or loosen wall socket.
 - This may result in electric shock or fire.
6. Do not pull or excessively bend the power cord.
7. Do not twist or tie the power cord.
8. Do not hook the power cord over a metal object, place a heavy object on the power cord, insert the power cord between objects, or push the power cord into the space behind the appliance.
 - This may result in electric shock or fire.
9. Do not pull the power cord when unplugging the power plug.
 - Unplug the power plug by holding the plug.
 - Failing to do so may result in electric shock or fire.
10. If the power plug or power cord are damaged, contact your nearest service center.
11. Do not install this appliance near a heater or inflammable material.
12. Do not install this appliance in a humid, oily, or dusty location, or in a location exposed to direct sunlight or water (rain drops).
13. Do not install this appliance in a location where gas may leak.
 - This may result in electric shock or fire.
14. If the washer is moved to a new location, have it checked and re-installed by a qualified service technician.
 - Failing to follow this warning may result in electric shock or fire.

INSTALLATION INSTRUCTIONS

WARNING:

15. Do not install on carpet. Install washer on a level and solid floor that can support its weight.
 - Failing to do so may result in abnormal vibrations, noise, or problems with the product.
16. The washer is heavy. Two or more people may be needed to install and move the appliance.
 - Failing to do so may result in bodily or other injuries.
17. Store and install the washer where it will not be exposed to temperatures below freezing or exposed to outdoor weather conditions.
 - Failing to do so may result in serious leak damage.
18. Position the appliance so that the power plug is easily accessible.
 - Failing to do so may result in electric shock or fire due to electric leakage.
19. To reduce the risk of injury to persons, adhere to all industry recommended safety instructions.
 - Failing to follow all of the safety warnings in this manual may result in property damage, or injury to persons.

INSTALLATION INSTRUCTIONS

GROUNDING INSTRUCTIONS

WARNING

Improper use of the grounding plug can result in a risk of electric shock.

Consult a qualified electrician or serviceman if:

- 1) The grounding instructions are not completely understood.
- 2) You are unsure that the appliance is properly grounded.
- 3) You have any questions about the grounding or electrical instructions.

WARNING

Improper connection of the equipment-grounding conductor can result in a risk of electric shock. Check with a qualified electrician or serviceman if you are in doubt as to whether the appliance is properly grounded.

Do not modify the plug provided with the appliance - if it will not fit the outlet, have a proper outlet installed by a qualified electrician.

Electrical grounding is required for this washer.

This appliance must be grounded. In the event of malfunction or breakdown, grounding will reduce the risk of electric shock by providing a path of least resistance for electric current. This appliance is equipped with a power cord having a three prong grounding plug for use in a properly installed and grounded outlet. The plug must be plugged into an appropriate outlet that is properly installed and grounded in accordance with all local codes and ordinances.

 **WARNING:** An improperly connected equipment-grounding conductor can increase the risk of electrical shock. Check with a qualified electrician or serviceman if you are not sure whether the appliance is properly grounded. Do not modify the plug provided with the appliance. If it does not fit the outlet, have a proper outlet installed by a qualified electrician. To prevent unnecessary risk of fire, electrical shock or personal injury, all wiring and grounding must be done in accordance with the National Electrical Code ANSI/FNPA, No.70 Latest Revision and local codes and ordinances. It is the personal responsibility of the appliance owner to provide adequate electrical service for this appliance. Never connect the ground wire to plastic plumbing lines, gas lines, or hot water pipes.

 **WARNING:** Certain internal parts are intentionally not grounded and may present a risk of electric shock only during servicing.
Service Personnel: Do not make contact the following parts while the appliance is energized: Electrical Valve, Drain Pump, Door or Lock.

 **WARNING:** The maximum current through the unit is 12A when you are using its heating function. Make sure the power supply system (current, voltage and wire) can meet the normal loading requirements of the electrical appliances.

INSTALLATION INSTRUCTIONS

USAGE AND MAINTENANCE CAUTIONS

WARNING:

1. If the appliance is flooded, cut the power immediately and contact your nearest service center.
2. If the appliance emits a strange noise, a burning smell, or smoke, unplug the power plug immediately and contact your nearest service center.
 - Failing to do so may result in electric shock or fire.
3. In the event of a gas leak (such as propane gas, LP gas, etc.), ventilate the area immediately. Do not turn any appliance or light on or off.
 - Do not use a ventilating fan.
 - A spark may result in an explosion or fire.
4. Do not wash items contaminated with gasoline, kerosene, benzene, paint thinner, alcohol, dry cleaning detergent or other flammable or explosive substances.
 - This may result in electric shock, fire, or an explosion.
5. Do not force the washer door open while the washer is operating (high temperature washing/spinning).
 - Water flowing out of the washer may cause burns or cause the floor to be slippery. This may result in injury.
 - Forcing the door open can damage the product or cause injury.
6. Make sure to remove the packaging (sponge, styrofoam) attached to the bottom of the washer and also remove the (4) transport bolts before using the machine.
7. Do not insert your hand or a metal object under the washer.
 - This may result in injury.
8. Do not attempt to operate this appliance if it is damaged, malfunctioning, partially disassembled, or has missing or broken parts, including a damaged cord or plug.
 - This may result in electric shock, fire or death.
9. Do not touch the power plug with wet hands.
 - This may result in electric shock.
10. Do not turn the appliance off by unplugging the power plug while the washer is in operation.
 - Plugging the power plug into the wall socket again may cause a spark and result in electric shock or fire.
11. Keep all packaging material well out of the reach of children, as packaging materials can be dangerous to children.
 - To avoid danger of suffocation, keep out of reach of babies and children.

INSTALLATION INSTRUCTIONS

WARNING:

12. Do not let children or infirm persons use this washer unsupervised.
 - Failing to do so may result in electric shock, burns or injury.
13. Do not attempt to repair, disassemble, or modify the appliance yourself.
 - Do not use any fuse (such as cooper, steel wire, etc.) other than the standard fuse.
 - If you need to repair or reinstall the appliance, contact your nearest service center.
 - Failing to do so may result in electric shock, fire, problems with the product, or injury.
14. If any foreign substance such as water enters the appliance in any area other than the tub, unplug the power plug and contact your nearest service center.
 - Failing to do so may result in electric shock or fire.
15. If the water supply hose comes loose from the faucet and floods the appliance, unplug the power plug.
 - Failing to do so may result in electric shock or fire.
16. Do not mix chlorine bleach with ammonia or acids such as vinegar.
 - Incorrect usage can produce poisonous gas, resulting in serious injury.
17. Do not reach into the washer while parts are moving. Before loading, unloading, or adding items, press the START/PAUSE button and allow the basket to come to complete stop before reaching inside.
 - Failing to do so may result in electric shock, injury or fire.
18. Do not allow children to play on or in the washer. Close supervision of children is necessary when the washer is used near children. As children grow, teach them the proper, safe use of all appliances.
 - Failing to do so may result in serious injury to persons.
19. Keep laundry products out of children's reach. Observe all warnings on product labels and follow instructions.
 - Failing to do so may result in serious injury to persons.
20. Disconnect this appliance from the power supply before attempting any user maintenance. Turning the controls to the OFF position does not disconnect this appliance from the power supply.
 - Failing to do so may result in electric shock, injury or fire.
21. Do not clean the appliance by spraying water directly onto it.
22. Do not use benzene, thinner, or alcohol to clean the appliance.
 - This may result in discoloration, deformation, damage, electric shock or fire.
23. Make sure children do not climb or sit on the unit.
24. Do not lean against the door.
25. Do not modify the plug provided with the appliance.
 - If it will not fit the outlet, have a proper outlet installed by a qualified electrician.

INSTALLATION INSTRUCTIONS

USAGE AND MAINTENANCE WARNINGS

WARNING:

1. Unplug the power plug when the appliance is not being used for long periods of time or during a thunder/lightning storm.
 - Failing to do so may result in electric shock or fire.
2. Keep hands and foreign objects clear of the door and latch area when closing the door.
 - Failing to do so may result in personal injury.
3. If the washer is contaminated by a foreign substance such as detergent, dirt, food waste, etc., unplug the power plug and clean the washer with a damp, soft cloth.
 - Failing to do so may result in discoloration, deformation, damage or rust.
4. The clear portion of the door can be broken by a strong impact. Take care when using the washer.
 - If the clear portion is cracked or broken, it may result in injury.
5. After a water supply failure or when reconnecting the water supply hose, open the faucet slowly.
6. Open the faucet slowly after a long period of non-use.
 - The air pressure in the water supply hose or the water pipe may result in damage to a part or in water leakage.
7. If a drain error occurs during an operation, check if there is a draining problem.
 - If the washer is used when it is flooded because of a draining problem, it may result in electric shock or fire due to electric leakage.
8. Do not insert your hand or a metal object under the washer.
 - This may result in injury.
9. Insert the laundry into the washer completely so that laundry does not get caught in the door.
 - If laundry gets caught in the door, it may result in damage to the laundry or the washer, or result in water leakage.
10. Ensure that the faucet is turned off when the washer is not being used.
 - Ensure that the water supply hose connectors are properly tightened.
 - Failing to do so may result in property damage or injury.
11. Open the faucet and check if the water supply hose connector is firmly tightened and that there is no water leaking before using the product.
 - If the water supply hose connectors are loose, it may result in water leakage.
12. Do not stand on top of the appliance or place objects (such as laundry, lighted candles, lighted cigarettes, dishes, chemicals, metal objects, etc.) on the appliance.
 - This may result in electric shock, fire, problems with the product, or injury.
13. Do not operate the appliance with wet hands.
 - This may result in electric shock.
14. Do not spray volatile material such as insecticide onto the surface of the appliance.
 - As well as being harmful to humans, it may also result in electric shock, fire, or problems with the product.

INSTALLATION INSTRUCTIONS

WARNING:

15. Do not place an object that generates an electromagnetic field near the washer.
 - This may result in injury due to a malfunction.
16. Since the water drained during a high temperature wash is hot, do not touch the water.
 - This may result in burns or injury.
17. Do not wash, or spin, water-proof seats, mats, or clothing.
 - Do not wash thick, hard mats even if the washer mark is on the care label.
 - This may result in injury or damage to the washer, walls, floor, or clothing due to abnormal vibrations.
18. Do not operate the washer when detergent dispenser is removed.
 - This may result in electric shock or injury due to water leakage.
19. Do not insert your hand into the detergent dispenser after opening it.
 - This may result in injury as your hand may be caught.
20. Do not place any non-laundry objects, such as shoes, food waste, or animals into the washer.
 - This can cause abnormal vibrations that can damage the washer, and, in the case of pets, cause severe injury or death.
21. Do not press the buttons using sharp objects such as pins, knives, fingernails, etc.
 - This may result in electric shock or injury.
22. Do not wash laundry contaminated by oils, creams, or lotions usually found in skin care shops or massage clinics.
 - This may result in the rubber seal becoming deformed and cause water leakage.
23. Ensure that the water inlet pipe is connected and the tap is opened before washing clothes.
24. Do not leave metal objects (safety pins, hair pins, etc.) or bleach in the tub for long periods of time.
 - This may cause the tub to rust.
 - If rust appears on the surface of the tub, apply a neutral cleansing agent to the surface and use a sponge to clean it. Never use a metal brush.
25. Do not use hot water from water cooling/heating devices.
 - This may result in problems with the washer.
26. Do not use natural hand-washing soap in the washer.
 - If it hardens and accumulates inside the washer, it may cause problems with the product, discoloration, rust, or bad odors.
27. Do not wash large laundry items such as bedding in the washing net.
 - Failing to do so may result in injury due to abnormal vibrations.
 - Place smaller items, such as lace socks and lingerie in the washing net.
28. Do not use hardened detergent.
 - If it accumulates inside the washer, it may result in water leakage.
29. Do not wash throw rugs or doormats.
 - If you wash throw rugs or doormats, the sand will accumulate inside the washer.
 - It may result in error such as no draining.
30. Do not close the door with excessive force.
31. Do not overfill the unit. Make sure the clothes are distributed well.

INSTALLATION INSTRUCTIONS

UNPACKING THE WASHER

▲ **WARNING:**

Recycle or destroy the carton and plastic bags after the washer is unpacked. Make materials inaccessible to children. Children might use them for play. Cartons covered with rugs, bedspreads or plastic sheets can become airtight chambers causing suffocation.

1. Cut and remove the top and bottom packaging straps.
2. While it is in the carton, carefully lay the washer on its side. **DO NOT** lay the washer on its front or back.
3. Turn down the bottom flaps-remove all base packaging, including the cardboard, styrofoam base and styrofoam tub support (inserted in center of base).

NOTE: If you are installing a pedestal, proceed to the installation instructions that come with the pedestal.

4. Carefully return the washer to an upright position and remove the carton.
5. Carefully move the washer to within 4 feet (122 cm) of the final location.
6. Remove the following from the back side of the washer:

4 transport bolts
4 plastic spacers (including rubber grommets)
4 power cord retainers

REMOVING THE TRANSPORT BOLTS

Before using this washing machine, the transport bolts must be removed from the back of this machine.

Loosen all bolts with a wrench to remove.

Cover the holes with provided transport hole plugs.

Keep the transport bolts in a safe place for future use. If the unit needs to be transported at any time, the transport bolts should be reinserted to avoid damage to the unit.

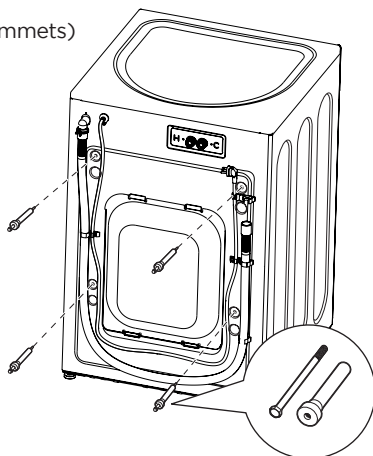

▲ **IMPORTANT:** Failure to remove the transport bolts* can cause the washer to become severely unbalanced.

Save all bolts for future use.

Any damages from failure to remove the transport bolts are not covered by the warranty.

TRANSPORTING THE MACHINE

Transport bolts need to be reinstalled to the machine prior to moving to avoid damage to the unit.

Accumulated water should be drained out of the machine prior to moving.

Handle the machine carefully. The door can not be used as the handle while moving the unit. time, the transport bolts should be reinserted to avoid damage to the unit.

INSTALLATION INSTRUCTIONS

PARTS & FEATURES

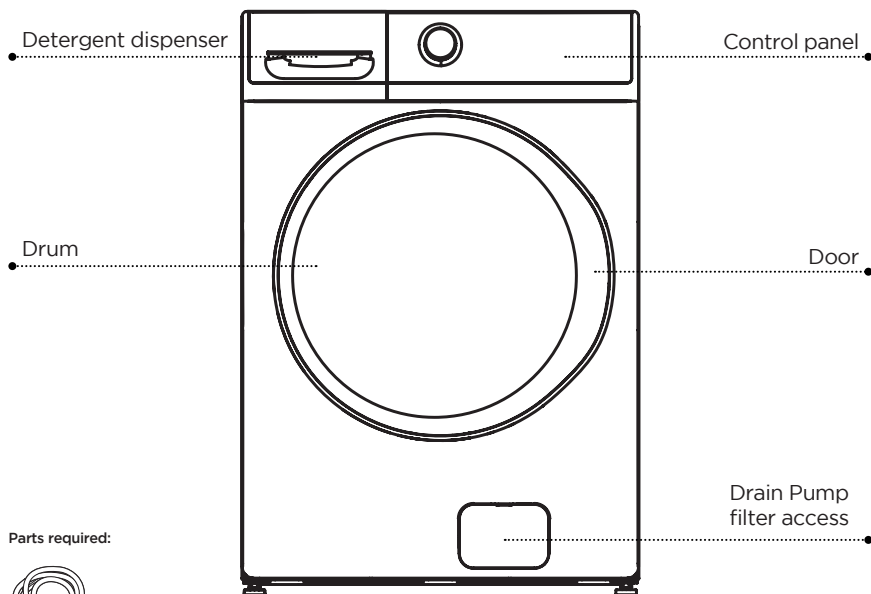

Parts required:



Inlet hoses (Parts required)
Water inlet hoses must be purchased separately at your local home or hardware store. Various lengths up to 8 ft. (240 cm) are available.

Parts included:



Inlet Hose Screens



Cable tie



Transport hole plugs



U Bracket

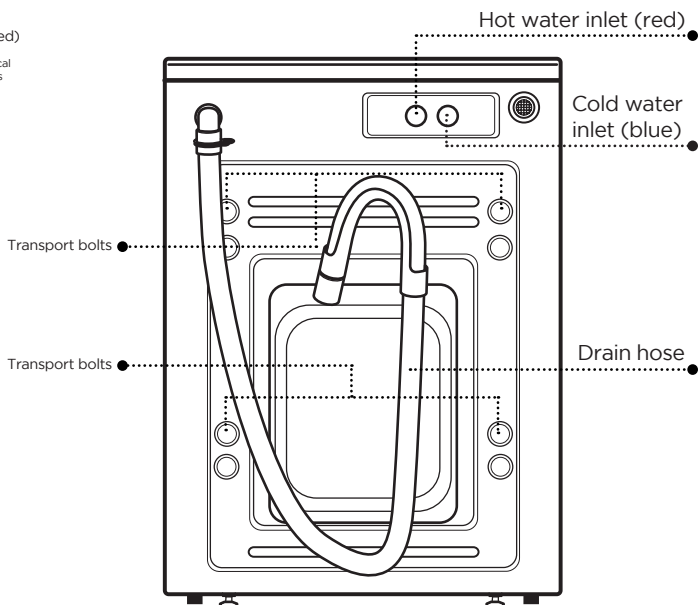

INSTALLATION INSTRUCTIONS

TOOLS NEEDED



Adjustable wrench

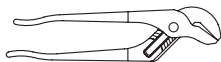

Channel-lock adjustable pliers



Level

Siphon break kit, additional hoses or other parts could be purchased separately depending on selected drainage method. Please check your local hardware store.

CHOOSE THE PROPER LOCATION

⚠ WARNING: Do not install your washer in areas where water may freeze, since your washer will always retain some water in its water valve, pump, and hose areas. Frozen water can damage the belts, the pump, hoses, and other components. Never install on a platform or weakly supported structure.

DO NOT INSTALL THE WASHER

1. In an area exposed to dripping water or outside weather conditions. The ambient temperature should never be below 60°F (15.6°C) for proper washer operation.
2. In an area where it will come in contact with curtains or drapes.
3. On carpet the floor **MUST** be a hard surface with a maximum slope of 1/2" per foot (1.27 cm per 30 cm). To make sure the washer does not vibrate or move, you may have to reinforce the floor.

NOTE: If floor is in poor condition, use 3/4" impregnated plywood sheet solidly attached to the existing floor covering.

⚠ IMPORTANT: MINIMUM INSTALLATION CLEARANCES

- When installed in alcove: Top and Sides = 0" (0 cm), Back = 3" (7.6 cm).
- When installed in closet: Top and Sides = 0" (0 cm), Front = 2" (5 cm). Back = 3" (7.6 cm).
- Closet door ventilation openings required: 2 louvers each 60 square in. (387 cm), located 3" (7.6 cm) from top and bottom of door.

ELECTRICAL REQUIREMENTS

Read these instructions completely and carefully.

⚠ WARNING: TO REDUCE THE RISK OF FIRE, ELECTRICAL SHOCK AND PERSONAL INJURY:

- **DO NOT USE AN EXTENSION CORD OR AN ADAPTER PLUG WITH THIS APPLIANCE, WASHER MUST BE ELECTRICALLY GROUNDED IN ACCORDANCE WITH LOCAL CODES AND ORDINANCES.**

CIRCUIT - Individual, properly polarized and grounded 16-amp branch circuit fused with 16-amp time delay fuse or circuit breaker.

POWER SUPPLY - 2-wire with ground, 120V~, single-phase, 60Hz, alternating current.

OUTLET RECEPTACLE - Properly grounded receptacle located so the power supply cord is accessible when the washer is in an installed position.

INSTALLATION INSTRUCTIONS

ROUGH-IN DIMENSIONS

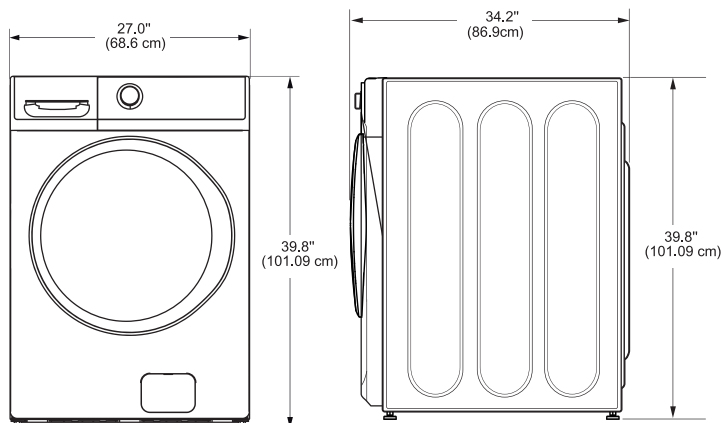

WATER SUPPLY REQUIREMENTS

Hot and cold water faucet **MUST** be installed within 42" (107 cm) of your washer's water inlet. The faucet **MUST** be 3/4" (1.9 cm) garden hose-type so inlet hoses can be connected. Water pressure **MUST** be between 10 and 120 psi. Your water department can advise you of your water pressure.

DRAIN REQUIREMENTS

1. Drain capable of eliminating 64.3 L per minute.
2. A standpipe diameter of 1 1/4" (3.18 cm) minimum.
3. The standpipe height above the floor should be:
Minimum height: 24" (61 cm)
Maximum height: 47.24" (120 cm)

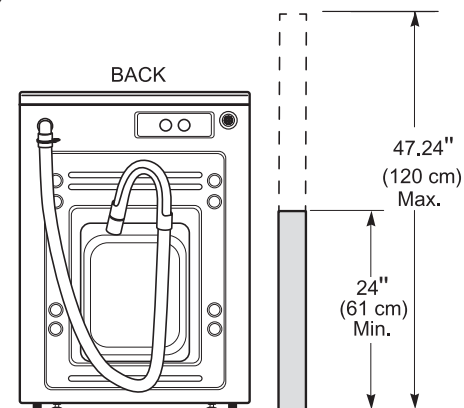

NOTE: If you must transport the washer at a later date, you must reinstall the shipping support hardware to prevent shipping damage. Keep the hardware in the plastic bag provided.

INSTALLATION INSTRUCTIONS

Connecting the water hoses

NOTE: The water supply hoses are not supplied with your washer and must be purchased separately.

⚠ CAUTION:

- Use new water supply hoses, Using old hoses can result in leakage or overflow that can damage your property.
- Do not connect multiple water supply hoses together to increase the length of the hoses. Hoses connected this way can leak and cause electrical shock. If a hose is too short, replace the hose with a longer, high-pressure hose.

INSTALLING THE WASHER

1. Run some water from the cold faucet to flush the water lines and remove particles that might clog up the inlet hose.
2. Reinstall the rubber washer into the hose fitting if it has fallen out during shipment. Carefully connect the inlet hose marked HOT to the rear "H" (red) inlet of the water valve. Tighten by hand; then tighten another 2/3 turn with pliers. And COLD inlet hose to the rear "C" (blue) inlet of the water valve. Tighten by hand; then tighten another 2/3 turn with pliers.

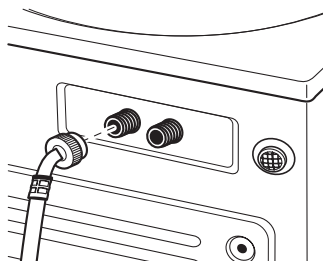

Do not cross thread or over-tighten these connections.

3. Remove the Rubber Washers temporarily from the end of the hoses that will connect to the faucets. Use a pair of needle-nose pliers or your fingers to gently pull them out. Insert the Inlet Hose Screens: Place the screens inside the threaded ends of the hoses. They should fit snugly at the bottom. Reinsert the Rubber Washers. The washers should sit on top of the screens to ensure a proper seal.
4. Connect the inlet hose ends to the HOT and COLD water faucets tightly by hand, then tighten another 2/3 turn with pliers. Turn the water on and check for leaks.

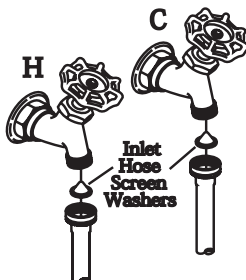

INSTALLATION INSTRUCTIONS

- Carefully move the washer to its final location, Gently rock the washer into position ensuring inlet hoses do not become kinked. It is important not to damage the rubber leveling legs when moving your washer to its final location, Damaged legs can increase washer vibration. .

NOTE: To reduce vibration, ensure that all four rubber leveling legs are firmly touching the floor. .

NOTE: Do not use the dispenser drawer or door to lift the washer.

- With the washer in its final position, place a level on top of the washer(if the washer is installed under a counter, the washer should not be able to rock). Adjust the front leveling legs up or down to ensure the washer is resting solid, Turn the locknuts on each leg up towards the base of the washer and snug with a wrench.

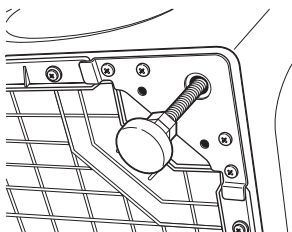

NOTE: Keep the leg extension at a minimum to prevent excessive vibration. The farther out the legs are extended, the more the washer will vibrate.

If the floor is not level or is damaged, you may have to extend the rear leveling legs.

- Attach the U-shaped hose guide to the end of the drain hose. Place the hose in a laundry tub or standpipe and secure it with the cable tie provided in the enclosure package.

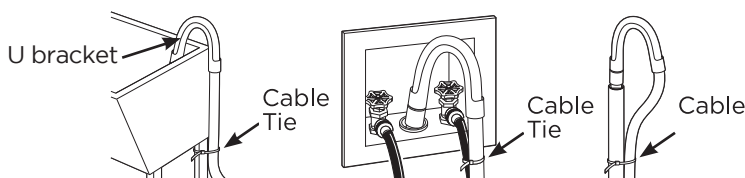

NOTE: Placing the drain hose too far down the drain pipe can cause a siphoning action, No more than 7 inch (17.78 cm) of hose should be in the drain pipe, There must be an air gap around the drain hose. A snug fit can also cause a siphoning action.

- Make sure the power is turned on at the main circuit, fuse box.

TROUBLESHOOTING & WARRANTY

BEFORE YOU CALL FOR SERVICE

IF THE UNIT FAILS TO OPERATE:

- A) Check to make sure that the unit is plugged in securely. If it is not, remove the plug from the outlet, wait 10 seconds and plug it in again securely.
- B) Check for a blown circuit fuse or a tripped main circuit breaker. If these seem to be operating properly, test the outlet with another appliance.

IF NONE OF THE ABOVE SOLVES THE PROBLEM, CONTACT OUR CUSTOMER SATISFACTION CENTER. DO NOT TRY TO ADJUST OR REPAIR YOURSELF.

IMPORTANT

DO NOT RETURN THIS PRODUCT TO THE STORE

If you have a problem with this product, please contact the BLACK+DECKER Customer Satisfaction Center at 844-299-0879.

**DATED PROOF OF PURCHASE, MODEL # AND SERIAL #
REQUIRED FOR WARRANTY SERVICE.**

TROUBLESHOOTING & WARRANTY

TROUBLESHOOTING

Troubleshoot your problem by using the chart below. If the unit still does not work properly, contact W Appliance Co. customer service center or the nearest authorized service center. Customer must never troubleshoot internal components.

SYMPTOMS	POSSIBLE CAUSE	SOLUTIONS
Washer will not start	<p>Door may not be closed tightly.</p> <p>Power plug may not be inserted.</p> <p>Water supply tap may not be opened.</p> <p>“On/Off” may not be pressed.</p> <p>“Start/Pause” may be pressed.</p>	<p>Close the door tightly.</p> <p>Make sure the power plug is inserted well.</p> <p>Open the water supply tap.</p> <p>Press “On/Off”.</p> <p>Check if the “Start/Pause” button is pressed. If so press the button again to start.</p>
Door Cannot be opened	Washer’s safety protection design is working.	Disconnect the power, restart the machine
Thumping sound	<p>Heavy wash loads may produce a thumping sound.</p> <p>Washer load may be out of balance.</p>	<p>This is normal.</p> <p>If sound continues, washer is probably out of balance. Stop and redistribute wash load. Pause the cycle and redistribute the load.</p>
Vibrating noise	<p>Packaging materials were not removed.</p> <p>Wash load may be unevenly distributed in the tub.</p> <p>Not all leveling feet are resting firmly and evenly on the floor.</p> <p>Floor not level/rigid enough.</p>	<p>See the UNPACKING AND REMOVING SHIPPING MATERIAL section in the installation instructions.</p> <p>Pause the cycle and redistribute the load.</p> <p>See Leveling the Washer in the Installation Instructions.</p> <p>Make sure that the floor is solid and does not flex. See Flooring in the Installation Requirements.</p>
Rattling and clanking noise	Foreign objects, such as keys, coins, or safety pins, may be in tub or pump.	<p>Stop washer, check tub and drain filter for foreign objects.</p> <p>If noise continues after washer is restarted, call for service.</p>

TROUBLESHOOTING & WARRANTY

SYMPTOMS	POSSIBLE CAUSE	SOLUTIONS
Excessive suds	Too much detergent or incorrect detergent.	HE detergents are formulated specifically for High-Efficiency washers and contain suds reducing agents. Only use detergent with the High-Efficiency (HE) logo.
Water leaking	<p>Inlet hose connection is loose at faucet or washer.</p> <p>Drain hoses are clogged.</p> <p>Drain pipe has come out of drain or is not inserted far enough..</p> <p>Door gasket is damaged.</p> <p>Too much detergent is being used or HE detergent was not used.</p> <p>Detergent Dispenser is clogged.</p>	<p>Check hoses for leaks, cracks and splits. Check and tighten hose connections.</p> <p>The washer pumps out water very rapidly.</p> <p>Check for water backing up out of the drain pipe during drain. If water is seen coming out of the drain, check for proper drain hose installation and check for restrictions in the drain.</p> <p>Contact a plumber to repair drain pipe.</p> <p>Tie drain hose to inlet hose or standpipe to prevent it from unfastening. For smaller drain pipes, insert the drain hose into the pipe as far as the drain hose flange. For larger drain pipes, insert the drain hose into the pipe 1"-2" past the flange.</p> <p>Stop the washer and check the load. If water is leaking from the front of the unit, check to make sure the door gasket is sealed and not damaged.</p> <p>Sometimes objects left in pockets can cause damage to the inside of the unit. Clean and dry the door gasket to make sure there is no residue or small object causing a small leak in the seal of the gasket.</p> <p>If leaking is in the back left side of the unit it can be caused by oversudsing from too much detergent or the wrong type of detergent.</p> <p>Powdered detergent may cause clogs inside the dispenser and cause water to leak out of the front of the dispenser. Remove the drawer and clean the dispenser compartment and the drawer.</p>

TROUBLESHOOTING & WARRANTY

SYMPTOMS	POSSIBLE CAUSE	SOLUTIONS
Wrinkling	Washer not unloaded promptly. Washer overloaded. Hot and cold water inlet hoses are reversed.	Always remove items from the washer as soon as the cycle is complete. The tub should not be tightly packed with items. Hot water rinse can set wrinkles in garments. Check the inlet hose.
Stains on fabrics	Washer was not unloaded promptly. Clothes were not properly sorted.	Always remove items from the washer as soon as possible after the cycle is complete. Always wash dark colors separately from light colors and whites to prevent discoloration. Never wash heavily soiled items with lightly soiled items.
Clothes are too wet	Load is out of balance Pump is clogged Overloading	Re-distribute load and run the rinse and spin cycle Clean the pump filter Do not load tub more than 3/4 full of dry clothes.
Musty or mildew odor in washer	Inside of tub was not cleaned properly.	Run the Tub Clean cycle with bleach once a month to clean tub and remove any mold from inside washer.
The machine does not drain or spin properly	Something is blocking the pump.	Check and clean the pump filter.
Error Code E30	Door is not closed properly.	Disconnect the power, make sure fabric is not stuck, Restart the machine.
Error Code E10	This indicates an issue with water filling into the machine.	Make sure the water pressure is not too low. Make sure no kinks in the hoses. Make sure the inlet valve is not blocked.
Error Code E21	Water is draining slowly.	Make sure the drain hose is not blocked.
Error Code E12	Water overflow	Restart the washer.
Error Code EXX	Other	Restart the washer, if error remains, contact customer service.

LIMITED WARRANTY

ACTIVATE WARRANTY

Any repair, replacement, or warranty service, and all questions about this product should be directed to W Appliance Co. at 844-299-0879 from the US, including Puerto Rico, or Canada.

Some issues can be addressed without service. Before contacting regarding your warranty, please visit the "Troubleshooting" section of your user manual.

All warranty service is provided exclusively by our authorized W Appliance Co. service providers. For service in US, including Puerto Rico, and Canada call 1-844-299-0879 to create a ticket. When calling, please have the following information available: date of purchase, model number, proof of purchase and a brief description of the problem.



WHAT IS COVERED

YOUR SOLE AND EXCLUSIVE REMEDY UNDER THIS LIMITED WARRANTY SHALL BE PRODUCT REPAIR AS PROVIDED HEREIN. This limited warranty is valid only in the United States or Canada and applies only when the major appliance is used in the country in which it was purchased:

ONE (1) YEAR FROM THE DATE OF DELIVERY OF THE ORIGINAL PURCHASE (PARTS AND LABOR INCLUDED):

W Appliance Co. will pay for factory-specified replacement parts and labor to correct defects in materials or workmanship that existed when this major appliance was purchased, or at its sole discretion, replace the product with a new, or remanufactured, unit equivalent to your original purchase. In the event of product replacement, your appliance will be warranted for the remaining term of the original unit's warranty period.

YEARS TWO (2) THROUGH FIVE (5) FROM DATE OF DELIVERY OF THE ORIGINAL PURCHASE (CERTAIN COMPONENT PARTS ONLY - LABOR NOT INCLUDED): W Appliance Co. will pay for factory-specified replacement parts for the component parts listed below to correct non-cosmetic defects in materials or workmanship in these parts that prevent function of this major appliance and that existed when this major appliance was purchased:

DISHWASHER	WASHING MACHINE	DRYER	REFRIGERATORS AND FREEZERS	MICROWAVE
Lower, Upper and Third Level (where applicable) Wire Racks (excludes cup shelves, silverware basket, and third rack trays), Chopper Blade, Stainless Steel Tub and Inner Door Liner	Drive Motor (Stator and Rotor Only)	Drive Motor Only	Compressor Only	Magnetron Tube Only

LIMITED WARRANTY

WHAT IS NOT COVERED / EXCLUSIONS

1. Commercial, non-residential or multiple family use or use inconsistent with the product instructions and manuals.
2. In-home instruction on how to use your product.
3. Repair to correct improper maintenance, installation not in accordance with installation instructions or electrical or plumbing codes, or repair of household electrical or plumbing systems.
4. Consumable parts (e.g., light bulbs, batteries, air or water filters, preservation solutions, etc.).
5. Defects or damage resulting from accident, misuse, abuse, alteration, fire, floods, acts of God or improper installation.
6. Damages, defects, or repairs caused by unauthorized servicers or use of non-genuine or third-party parts.
7. Any damage to the finish of appliance or home incurred during installation, including but not limited to floors, cabinets, walls, etc.
8. Cosmetic damage (e.g., scratches, dents, chips, and other damage to appliance finishes), unless such damage results from defects in materials and workmanship and is reported to W Appliance Co., within 48 hours from date of delivery.
9. If the appearance or exterior of the product has been damaged or defaced, altered or modified in design or construction.
10. Discoloration, rust or oxidation of surfaces resulting from caustic or corrosive environments (e.g., high salt concentrations, high moisture or humidity or exposure to chemicals).
11. Product pick-up or delivery. This warranty is for in-home repair only.
12. Travel or transportation expenses for service in remote locations where an authorized servicer is not available.
13. Products not accessible to provide required service or for expenses making the product accessible for servicing.
14. Surcharges including but not limited to, any after hour, weekend, or holiday service calls, tolls, ferry trip charges, or mileage expenses for service calls to remote areas, including the state of Alaska.
15. Repair, removal or reinstallation of inaccessible appliances or built-in fixtures (e.g., trim, decorative panels, flooring, cabinetry, islands, countertops, drywall) that interfere with servicing, removal or replacement of the product.
16. Appliances with original, factory installed model/serial numbers removed, altered or not easily determined.
17. Incidental or consequential damages (e.g., loss of food or medicine) resulting from appliance breakdown or delay in service, repair or replacement.
18. Transportation and shipping costs associated with the replacement of the unit.
19. Glass parts and other accessory items included with the unit.
20. Products that have been purchased as refurbished, like new, second-hand, under "as is" or "final sale" terms.
21. Units that have been transferred from the original owner/purchaser.
22. If there is damage due to power line surge, user damage to the AC power cord or connection to improper voltage source.
23. Products which are not defective or broken, or which are working as described in the owner's manual.

DISCLAIMER OF IMPLIED WARRANTIES

Repair or replacement as provided under this warranty is the exclusive remedy to the customer. W. Appliance Co. shall not be liable for any incidental or consequential damages for breach of any express or implied warranty on this product, except to the extent prohibited by applicable law. Any implied warranties, including any implied warranty of merchantability or implied warranty of fitness for a particular purpose, are limited to the duration of this warranty or the shortest period allowed by law. Some states do not allow the exclusion or limitations of consequential damages, or limitations on how long the warranty lasts. In these cases, the above exclusions or limitations may not apply to you. This warranty gives you specific legal rights and you may also have other rights which may vary from state to state.

W. Appliance Co. does not warrant that the appliance will work properly in all environmental conditions and makes no warranty and representation, either implied or expressed, with respect to the quality, performance, merchantability, or fitness for a particular purpose other than the purpose identified within this user's manual. W Appliance Co. has made every effort to ensure that this user's manual is accurate and disclaims liability for any inaccuracies or omissions that may have occurred. Information in this user's manual is subject to change without notice and does not represent a commitment on the part of W Appliance Co. W Appliance Co. reserves the right to make improvements to this user's manual and/or to the product described at any time without notice. If you find information in this manual that is incorrect, misleading or incomplete, please call 844-299-0879.

W Appliance Co.
New York, NY 10018

EXTENDED WARRANTY COVERAGE

Protect Your Appliance with Extended Warranty Coverage

Thank you for purchasing your new appliance! Your product comes with our one-year limited warranty, but why stop there? With our Extended Warranty and Accidental Damage Protection Plan, provided by Mulberry, you can ensure your appliances are covered for longer—without worrying about unexpected breakdowns or accidents.

Why Upgrade to the Extended Warranty Plan?

- Comprehensive Protection – Extend your warranty coverage and get full protection for accidental damage and mechanical/ electrical failures, giving you peace of mind well beyond the first year.
- No Hidden Costs – You won't pay any deductibles or service fees for repairs or replacements. We've got you covered!
- Avoid Expensive Repairs – Appliances like refrigerators, air conditioners, and dishwashers can be costly to repair. Keep your products running smoothly without the worry of unexpected repair bills.
- Quick & Easy Claims – Mulberry offers hassle-free claims and quick, reliable service when you need it most—no complicated paperwork, just fast and efficient help.



Coverage	Basic Warranty	Protection +
Mechanical / Electrical Failure Coverage	Yes (1 year)	Yes (2 - 4 years)
Service Fee or Deductible	Yes (may apply)	No
Parts & Labor Costs Covered	Yes (limited to 1 year)	Yes (2 - 4 years)
Hassle-Free Claims Process	Standard	Priority (faster service)
Repair / Replacement Options	Yes (limited to 1 year)	Yes (2 - 4 years)
Convenience & Peace of Mind	Limited to 1 year	Guaranteed for up to 4 years



BLACK & DECKER, BLACK+DECKER, the BLACK & DECKER and BLACK+DECKER logos and product names are trademarks of The Black & Decker Corporation, used under license. All rights reserved.

Product in this box may differ slightly from that pictured. Does not affect function. Not all accessories shown in photography are included in this package.

Imported by W Appliance, Inc., 1356 Broadway, New York, NY 10018
Customer Service: 844-299-0879