

BLACK+[®] DECKER



**4.1 CU. FT.
TOP LOAD WASHER**

INSTRUCTION MANUAL

CATALOG NUMBER

BTLW41MW



Thank you for choosing BLACK+DECKER!

**PLEASE READ BEFORE RETURNING THIS PRODUCT FOR
ANY REASON.**

If you have a question or experience a problem with your BLACK+DECKER purchase, go to www.blackanddecker.com/instantanswers.

If you can't find the answer or do not have access to the Internet, call 844-299-0879 from 10:30 a.m. to 6:30 p.m. EST Mon. - Fri. to speak with an agent. Please have the catalog number available when you call.

SAVE THIS MANUAL FOR FUTURE REFERENCE.

PRODUCT REGISTRATION

Thank you for purchasing our BLACK+DECKER product. This easy-to-use manual will guide you in getting the best use of your product.

Remember to record the model and serial numbers. They are on a label on the back of the product.

Model number

Serial number

Date of purchase

Staple your receipt to your manual.
You will need it to obtain warranty service.

SAFETY INFORMATION

DANGER

DANGER - Immediate hazards which **WILL** result in severe personal injury or death

WARNING

WARNING - Hazards or unsafe practices which **COULD** result in severe personal injury or death

CAUTION

CAUTION - Hazards or unsafe practices which **COULD** result in minor personal injury

IMPORTANT SAFETY INSTRUCTIONS

WARNING

When using electrical appliances, basic safety precautions should be followed, including the following:
READ ALL INSTRUCTIONS BEFORE USING THE UNIT

1. Read all instructions before using the appliance.
2. Use this appliance only for its intended purpose as described in this owner's Manual.
3. Before use, the washer must be properly installed as described in this manual.
4. ALWAYS follow the fabric care instructions supplied by the garment manufacturer.
5. Do not wash articles that have been previously cleaned in, washed in, soaked in, or spotted with gasoline, dry-cleaning solvents, other flammable or explosive substances as they give off vapors that could ignite or explode.
6. Do not allow children to play on or in the appliance. Close supervision of children is necessary when the appliance is used near children.
7. Before the appliance is removed from service or discarded, remove the lid of the washing compartment.
8. Do not reach into the appliance if the tub or agitator is moving.
9. Do not install or store this appliance where it will be exposed to the weather or freezing temperatures.
10. Do not tamper with the controls.
11. Do not repair or replace any part of the appliance or attempt any servicing unless it is specifically recommended in the user-maintenance instructions or in published user-repair instructions that you understand and have the skills to carry out.
12. Do not add gasoline, dry-cleaning solvents, or other flammable or explosive substances to the wash water. These substances give off vapors that could ignite or explode.

SAFETY INFORMATION

13. Under certain conditions, hydrogen gas may be produced in a hot water system that has not been used for 2 weeks or more. **HYDROGEN GAS IS EXPLOSIVE.** If the hot water system has not been used for 2 weeks or more, before using a washer or combination washer-dryer, turn on all hot water faucets and let the water flow from each for several minutes. This will release any accumulated hydrogen gas. As the gas is flammable, do not smoke or use an open flame during this time.
14. Keep the area underneath and around your appliances free of combustible materials (lint, paper, rags, etc.), gasoline, chemicals and other flammable vapors and liquids.
15. Do not place items exposed to cooking oil in your washer. Items contaminated with cooking oils may contribute to a chemical reaction that could cause a load to catch fire.
16. This washer is not designed for maritime use or for mobile installations such as in RVs, aircraft, etc.
17. Turn off the water faucets and unplug the washer if the machine is to be left for an extended period of time, such as during vacations.
18. Packaging material can be dangerous for children. There is a risk of suffocation! Keep all package away from children.
19. Always check the inside of the washer for foreign objects before loading laundry. Keep the lid closed when not in use.

SAVE THESE INSTRUCTIONS
HOUSEHOLD USE ONLY

SAFETY INFORMATION

INSTALLATION WARNINGS AND PRECAUTIONS

CAUTION

1. Plug the power cord into an AC 120V/60Hz wall socket rated at 15 amps or higher. Use the socket for this washer only. Do not use an extension cord.
 - Sharing a wall socket with another appliance, using a power strip, or extending the power cord may result in electric shock or fire.
 - Do not use an electric transformer. It may result in electric shock or fire.
 - Make sure that the power voltage, frequency and current match the product's specifications. Failing to do so may result in electric shock or fire.
2. Remove all foreign substances such as dust or water from the power plug terminals and contact points using a dry cloth on a regular basis.
 - Unplug the power plug and clean it with a dry cloth.
 - Failing to do so may result in electric shock or fire.
3. Plug the power plug into the wall socket in the right direction so that the cord runs towards the floor.
 - If you plug the power plug into the socket in the opposite direction, the electric wires within the cable may be damaged and this may result in electric shock or fire.
4. Plug the power plug into the wall socket firmly. Do not use a damaged power plug or loose wall socket, because this may result in electric shock fire.
5. Do not pull or excessively bend the power cord. Do not twist or tie the power cord.
6. Do not hook the power cord over a metal object. Place a heavy object on the power cord, insert power cord between objects, or push the power cord into the space behind the appliance, because this may result in electric shock or fire.
7. Do not pull the power cord when unplugging the power plug.
 - Unplug the power plug by holding the plug.
 - Failing to do so may result in electric shock or fire.
8. If the power plug or power cord is damaged, contact your nearest service center.
9. Do not install on carpet. Install the washer on a level and solid floor that can support its weight. Failure to do so may result in abnormal vibration, noise or problems with the product.
10. The washer is heavy. Two or more people may be needed to install and move the appliance. Failure to do so may result in bodily or other injuries.
11. Store and install the washer where it will not be exposed to temperatures below freezing or exposed to outdoor weather conditions. Failure to do so may result in serious leak damage.
12. Position the appliance so that the power plug is easily accessible. Failure to do so may result in electric shock or fire due to an electrical short circuit.
13. Failure to follow all of the safety warnings in this guide may result in property damage or injury to persons.
14. Do not add gasoline, dry-cleaning solvents, or other flammable or explosive substances to the wash water. These substances give off vapours that ignite or explode.

SAFETY INFORMATION

15. If the appliance is flooded, cut the power immediately and contact your nearest service center.
16. If the appliance emits a strange noise, a burning smell or smoke, unplug the power plug immediately and contact your nearest service center. Failure to do so may result in electric shock or fire.
17. In the event of a gas leak (such as propane or LP gas) ventilate the area immediately. Do not turn any appliance or light on or off.
 - Do not use a ventilating fan.
 - A spark may result in an explosion or fire
18. Do not force the washer lid open while the washer is operating (high temperature washing, drying or spinning).
 - Water flowing out of the washer may cause burns or cause the floor to be slippery. This may result in injury.
 - Forcing the lid open can damage the product or cause injury.
19. Make sure to remove the packaging (sponge, styrofoam) attached to the bottom of the washer before using it.
20. Do not insert your hand or a metal object under the washer. This may result in injury.
21. Do not attempt to operate this appliance if it is damaged, malfunctioning, partially disassembled or has missing or broken parts, including a damaged cord or plug. This may result in electric shock, fire or death.
22. Do not touch the power plug with wet hands. This may result in electric shock.
23. Do not turn the appliance off by unplugging the power plug while the washer is in operation. Plugging the power plug into the wall socket again may cause a spark and result in electric shock or fire.
24. Keep all packaging material well out of the reach of children, as packaging materials can be dangerous to children. If a child places a bag over his or her head, he or she may suffocate.
25. Do not let children or infirm persons use this washer unsupervised. Failure to do so may result in electric shock, burns or injury.
26. Do not attempt to repair, disassemble or modify the appliance yourself.
 - Do not use any fuse (such as copper, steel wire etc.) other than the standard fuse.
 - If you need to repair or reinstall the appliance, contact your nearest service center.
 - Failure to do so may result in electric shock, fire, problems with the product or injury.
27. If any foreign substance such as water enters the appliance in any area other than the tub, unplug the power plug and contact your nearest service center. Failure to do so may result in electric shock or fire.
28. If the water supply hose comes loose from the faucet and floods the appliance, unplug the power plug. Failure to do so may result in electric shock or fire.
29. Do not mix chlorine bleach with ammonia or acids such as vinegar. Incorrect usage can produce poisonous gas, resulting in serious injury.
30. Do not reach into the washer while parts are moving. Before loading, unloading or adding items, press the Start/Pause button and allow the tub to come to a complete stop before reaching inside. Failure to do so may result in electric shock or injury.

SAFETY INFORMATION

31. Do not allow children to play on or in the washer. Close supervision of children is necessary when the washer is used near children. As children grow, teach them the proper, safe use of all appliances. Failure to do so may result in serious injury.
32. Keep laundry products out of reach of children. Observe all warnings on product labels and follow them. Failure to do so may result in serious injury.
33. Disconnect this appliance from the power supply before attempting any user maintenance. Pressing the Power button does not disconnect this appliance from the power supply. Failure to do so may result in electric shock, injury or fire.
34. Do not clean the appliance by spraying water directly onto it.
35. Do not use benzene, thinner or alcohol to clean the appliance. This may result in discoloration, deformation, damage, electric shock or fire.
36. Unplug the power plug when the appliance is not being used for long periods of time or during a thunder/lightning storm. Failure to do so may result in electric shock or fire.
37. Keep hands and foreign objects clear of the lid and latch area when closing the lid. Failure to do so may result in personal injury.
38. If the washer is contaminated by a foreign substance such as detergent dirt, or food waste, unplug the power plug and clean the washer with a damp, soft cloth. Failure to do so may result in discoloration, deformation, damage or rust.
39. The clear portion of the lid can be broken by a strong impact. Take care when using the washer. If the clear portion is cracked or broken, it may result in injury.
40. After a water supply failure or when reconnecting the water supply hose, open the faucet slowly.
41. Open the faucet slowly after a long period of non-use. The air pressure in the water supply hose or the water pipe may result in damage to a part or in water leakage.
42. If a drain error occurs during an operation, check if there is a draining problem. If the washer is used when it is flooded because of a draining problem, it may result in electric shock or fire due to an electrical short circuit. Do not insert your hand or a metal object under the washer. This may result in injury.
43. Insert laundry into the washer completely so that the laundry does not get caught in the lid. If laundry gets caught in the lid, it may result in damage to the laundry or the washer, or result in water leakage.
44. Make sure that the faucet is turned off when the washer is not being used.
45. Make sure that the water supply hose connectors are properly tightened. Failure to do so may result in property damage or injury.
46. Open the faucet and check if the water supply hose connector is firmly tightened and that there is no water leaking before using the product. If the water supply hose connectors are loose, it may result in water leakage.
47. Do not stand on top of the appliance or place objects (such as laundry, lighted candles, lighted cigarettes, dishes, chemicals, metal objects, etc.) on the appliance. This may result in electric shock, fire, problems with the product, or injury.
48. Do not operate the appliance with wet hands. This may result in electric shock.
49. Do not spray volatile material such as insecticide onto the surface of the appliance. As well as being harmful to humans, it may also result in electric shock, fire or problems with the product.

SAFETY INFORMATION

50. Do not place an object that generates an electromagnetic field near the washer, This may result in injury due to a malfunction.
51. Since the water drained during a high temperature wash or drying cycle is hot, do not touch the water. This may result in burns or injury.
52. Do not wash, spin or dry water-proof seats, mats or clothing.
53. Do not wash thick, hard mats even if the washer mark is on the care label. This may result in injury or damage to the washer, walls, floor or clothing due to abnormal vibrations.
54. Do not operate the washer when the detergent dispenser is removed. This may result in electric shock or injury due to water leakage.
55. Do not insert your hand into the detergent dispenser after opening it. This may result in injury because your hand may be caught.
56. Do not place any non-laundry objects, such as shoes, food waste or animals into the washer. This can cause abnormal vibrations that can damage the washer, and in the case of pets, cause severe injury or death.
57. Do not press the buttons using sharp objects such as pins, knives, or fingernails. This may result in electric shock or injury.
58. Do not wash laundry contaminated by oils, creams or lotions usually found in skin-care shops or massage clinics. This may result in the rubber seal becoming deformed and water leakage.
59. Make sure that the water inlet pipe is connected and the tap is opened before washing clothes.
60. Do not leave metal objects (safety pins, hair pins, and so on) or bleach in the tub for long periods of time. This may cause the tub to rust.
- If rust appears on the surface of the tub, apply a neutral cleansing agent to the surface and use a sponge to clean it. Never use a metal brush.
61. Do not use hot water from water cooling/heating devices. This may result in problems with the washer.
62. Do not use natural hand-washing soap in the washer. If it hardens and accumulates inside the washer, it may cause problems with the product, discoloration, rust or bad odors.
63. If using a washing net with this machine (not provided), do not wash laundry items such as bedding in the washing net. Doing so may result in injury due to abnormal vibrations. Place only smaller items such as lace socks and lingerie in the washing net.
64. Do not use hardened powdered detergent. If it accumulates inside the washer, it may result in water leakage.
65. Do not wash throw rugs or doormats. Doing so may cause sand to accumulate inside the washer, resulting in mechanical problems.

SAFETY INFORMATION

GROUNDING INSTRUCTIONS

This appliance must be grounded. In the event of malfunction or breakdown, grounding will reduce the risk of electric shock by providing a path of the last resistance for electric current. This appliance is equipped with a cord having an equipment-grounding conductor and a grounding plug. The plug must be plugged into an appropriate outlet that is properly installed and grounded in accordance with all local codes and ordinances.

WARNING

Improper use of the grounding plug can result in a risk of electric shock.

Consult a qualified electrician or serviceman if:

- 1) The grounding instructions are not completely understood.
- 2) You are unsure that the appliance is properly grounded.
- 3) You have any questions about the grounding or electrical instructions.

WARNING

Improper connection of the equipment-grounding conductor can result in a risk of electric shock. Check with a qualified electrician or serviceman if you are in doubt as to whether the appliance is properly grounded.

Do not modify the plug provided with the appliance - if it will not fit the outlet, have a proper outlet installed by a qualified electrician.

SAFETY INFORMATION

UNPACKING AND REMOVING SHIPPING MATERIAL

Remove the packing box and lift the washer up and away from the foam base cushion. Open the lid of washer to take out all accessories including protection foam.

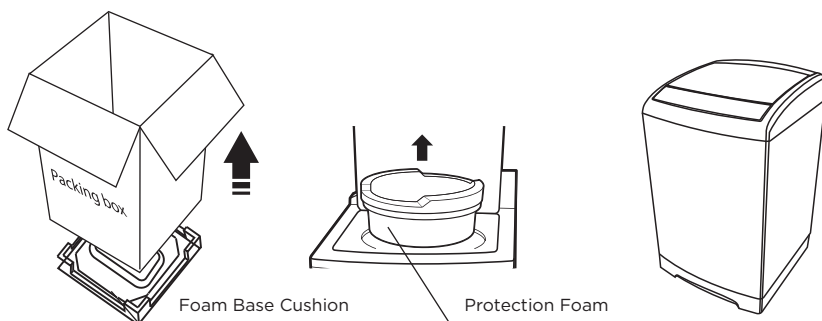

⚠ WARNING

Packaging materials can be dangerous to children; Keep all packaging material (plastic bags, polystyrene, etc.) well out of children's reach. Do not operate this appliance on the foam base cushion. Failing to do so will result in serious vibration.

⚠ WARNING

Styrofoam may be broken during transportation or unpacking the unit. Make sure to remove all Styrofoam the washer. It is important to check the bottom of the washer to make sure there is not any remaining Styrofoam at the bottom of the washer near the motor before operating the washer.

SET UP & USE

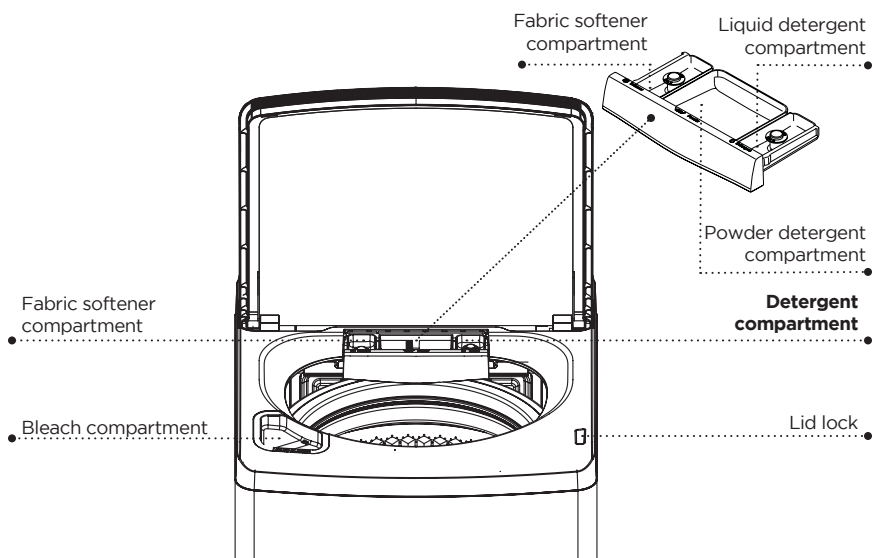
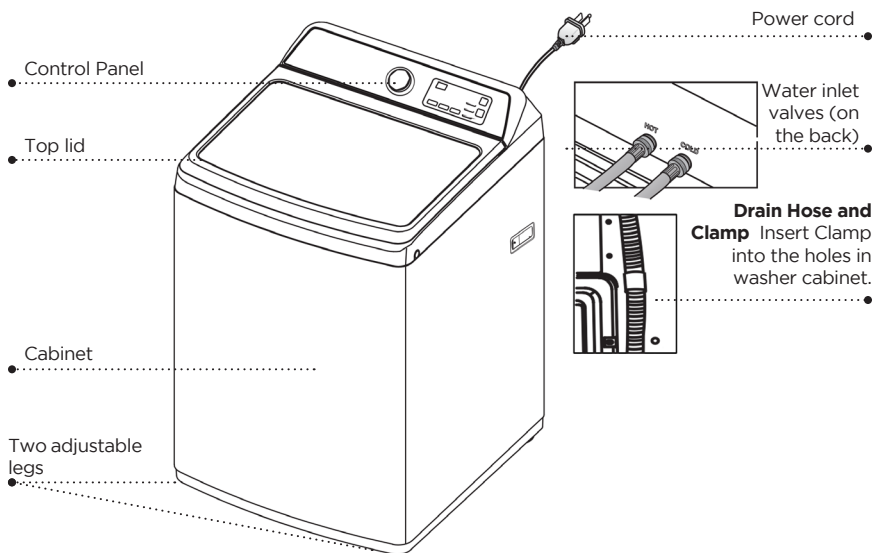

SET UP & USE

ACCESSORIES

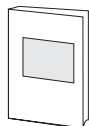

Owner's manual

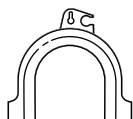

Drain Hose Guide (x1)



Inlet Hose Screens (x2)



Tie (x1)



Drain hose + Clamp

PARTS REQUIRED

Note: Water inlet hoses must be purchased separately at your local home or hardware store. Various lengths up to 8 ft. (240 cm) are available.

TOOLS NEEDED FOR INSTALLATION



Pliers



Level

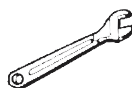

Adjustable wrench that opens to 1" (25 mm)

WASHER DIMENSIONS

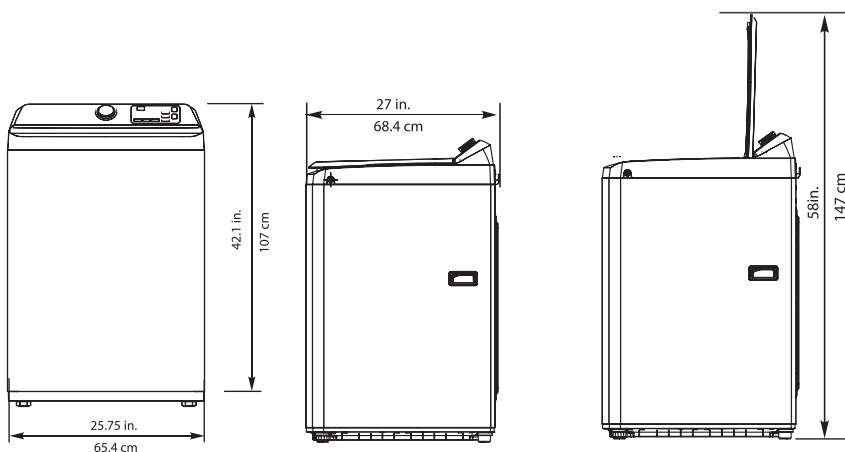

SET UP & USE

If you install your washer in an alcove or closet, the front of the closet must have two unobstructed air openings for a combined minimum total area of 72 sq. in. (465 sq.cm) with a minimum clearance of 3 in. (7.6 mm) at the top and bottom. A slatted door with equivalent space clearance is acceptable.

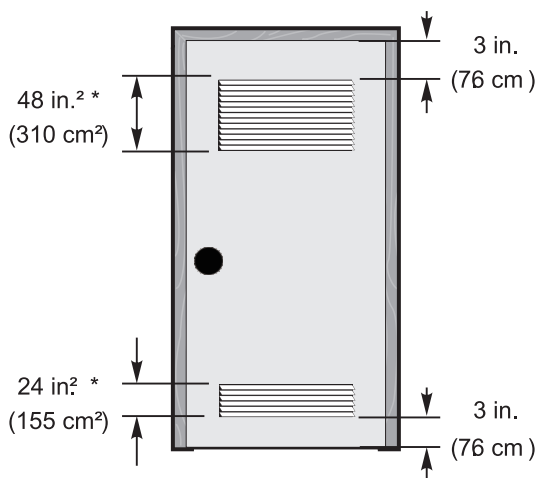

Installing in an alcove or closet

Minimum clearances between your washer and adjacent walls or other surfaces are:

- Either side: 1 in. (25 cm)
- Rear: 6 in. (15.2 cm)
- Closet Front: 2 in. (5.1 cm)
- Top: 24 in. (61 cm)
- Gap between the end of water valve and the wall 6 in. (15.2 cm)

If you install your washer and dryer side-by-side in a closet, the closet front must have an unobstructed air opening of at least 72 square inches (465 square cm).

SET UP & USE

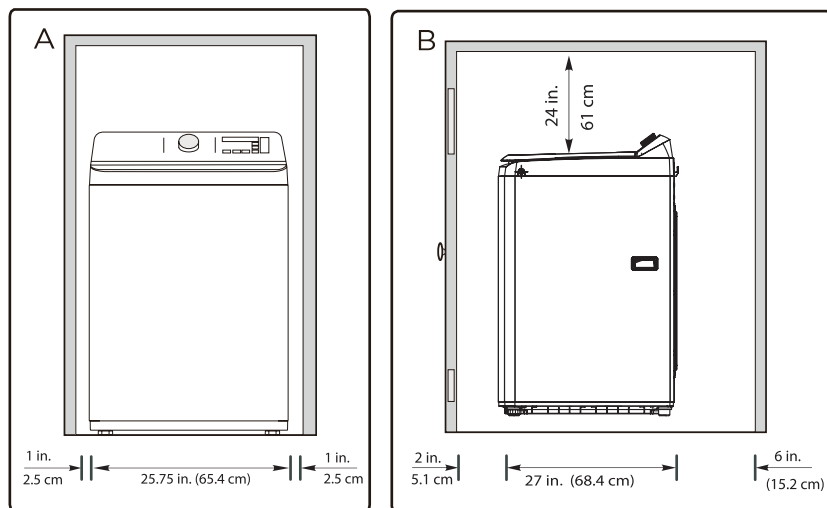

A. Recessed area

B. Side view-closet or confined area

WARNING

- Washer should be placed on a flat level surface without carpeting or other soft flooring that can obstruct ventilation.
- Washer should not be located in direct sunlight.
- Washer should be adequately ventilated.
- Washer should not be exposed to any freezing temperatures (32 °F or 0 °C).
- Washer should not be near any heat sources.
- Washer should not be located near oil or gas.
- Washer should have enough space so it does not rest on the power cord.

SET UP & USE

CHOOSE THE PROPER LOCATION

FLOORING

For best performance, you must install your washer on a solidly constructed floor. Wood floors may need to be reinforced to minimize vibration and/or unbalanced load situations.

- Carpeting and soft tile surfaces are contributing factors to vibration which can cause your washer to move slightly during the spin cycle.

 **CAUTION:** Do not install your washer in areas where water may freeze, since your washer will always retain some water in its water valve, pump, and hose areas. Frozen water can damage the belts, the pump, hoses, and other components. Never install on a platform or weakly supported structure.

ELECTRIC

Use 120Volt 60Hz 15 Amps fuse or circuit breaker. Individual branch circuit serving only for your washer is recommended.

 **CAUTION:** Never use an extension cord.

GROUNDING

Electrical grounding is required for this washer.

This appliance must be grounded. In the event of malfunction or breakdown, grounding will reduce the risk of electric shock by providing a path of least resistance for electric current. This appliance is equipped with a power cord having a three-prong grounding plug for use in a properly installed and grounded outlet. The plug must be plugged into an appropriate outlet that is properly installed and grounded in accordance with all local codes and ordinances.

 **CAUTION:** An improperly connected equipment-grounding conductor can increase the risk of electrical shock. Check with a qualified electrician or serviceman if you are not sure whether the appliance is properly grounded. Do not modify the plug provided with the appliance. If it does not fit the outlet, have a proper outlet installed by a qualified electrician. To prevent unnecessary risk of fire, electrical shock or personal injury, all wiring and grounding must be done in accordance with the National Electrical Code ANSI/FNPA, No.70 Latest Revision and local codes and ordinances. It is the personal responsibility of the appliance owner to provide adequate electrical service for this appliance.

 **WARNING:** Never connect the ground wire to plastic plumbing lines, gas lines, or hot water pipes.

SET UP & USE

Water Supply Requirements

To fill your washer in the correct amount of time, the water pressure needs to be between 14 and 116 psi (100 to 800 kPa).

If the water pressure is less than 14 psi (100 kPa):

- The water valve may fail or may not shut off completely.
- The time it takes to fill your washer may be longer than the time your washer controls allow. Your washer will turn off and report an error. A time-limit is built into the controls to prevent flooding in your home if a hose becomes loose.
- Water inlet hoses must be purchased separately. You can buy inlet hoses in various lengths up to 8 ft. (240 cm).

To avoid the possibility of water damage:

- Make sure that the water faucets are easily accessible.
- Turn off the faucets when you are not using your washer.
- Periodically check to make sure that water is not leaking from the water hose fittings.

Drainage requirements

The recommended height for the drain standpipe is 48 in. (122 cm).

The drain hose must be routed through the drain hose clip to the standpipe.

The standpipe must be large enough to accept the outside diameter of the drain hose.

CONNECTING THE WATER HOSES

NOTE: The water supply hoses are not supplied with your washer and must be purchased separately.

CAUTION

- Use new water supply hoses. Using old hoses can result in leakage or overflow that can damage your property.
 - Do not connect multiple water supply hoses together to increase the length of the hose. Hoses connected this way can leak and cause electrical shock. If a hose is too short, replace the hose with a longer, high-pressure hose.
1. Make sure that there are rubber washers inside the fittings at both ends of each new water hose. Remove the Rubber Washers temporarily from the end of the hoses that will connect to the faucets. Use a pair of needle-nose pliers or your fingers to gently pull them out. Insert the Inlet Hose Screens: Place the screens inside the threaded ends of the hoses. They should fit snugly at the bottom. Reinsert the Rubber Washers. After installing the Inlet Hose Screens, put the rubber washers back in. The washers should sit on top of the screens to ensure a proper seal

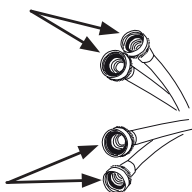

SET UP & USE

2. Tighten the hose and faucet fittings by hand until they are snug, then tighten them an additional two-thirds of a turn with pliers or a wrench. Pull the water supply hoses downwards to make sure that they are connected securely.

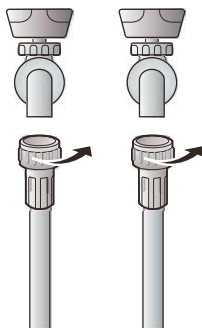

CAUTION

Do not overtighten the fittings or apply tape or sealant to the faucets or water supply inlets. This can damage the fittings.

3. Place the unconnected ends of the hoses into a sink or basin. Turn on the faucets connected to the water supply hoses for 10 or 15 seconds to remove any foreign substances. Turn off the faucets.

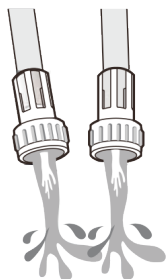

4. Connect the ends of the water supply hoses to the water supply inlet connections at the top of the washer. Make sure that the rubber washers are in place. The water supply hose connected to the hot faucet must be connected to the hot (red) water supply inlet and the water hose connected to the cold faucet must be connected to the cold (blue) water supply inlet.

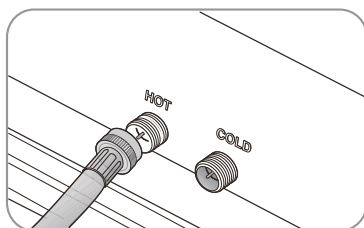

SET UP & USE

5. Tighten the fittings by hand until they are snug, and then tighten them an additional two-thirds of a turn with pliers.

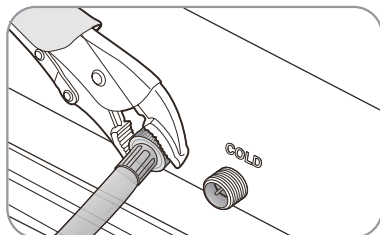

⚠ CAUTION

Do not overtighten the fittings or apply tape or sealant to the faucets or water supply inlets. This can damage the fittings.

Make sure that the water supply hoses are not twisted or bent. A bent or twisted hose can leak and cause an electric shock due to the water leakage. To ensure the correct water usage, connect both hot and cold water faucets. If either or both are not connected, an error code could occur.

6. Turn on the hot and cold water supplies and check all the water supply inlet connections and the faucets for water leaks.

Connecting the drain hose

1. Remove the drain hose from the clamp.
2. Position the other end of the drain hose. It can be positioned in three ways:
Over the edge of wash basin.
In a standpipe
In a laundry tub

⚠ CAUTION

Make sure that the connection between the drain hose and the wash basin, standpipe or laundry tub is not airtight.

- **Over the edge of sink or wash basin** - Secure the guide to side of the basin wall with a hook, tape it or tie it with a piece of cord to prevent the drain hose from moving.
- **In a standpipe** - The standpipe must be no shorter than 39 in. (99 cm) and no longer than 96 in. (244 cm).
- **In a laundry tub** - The laundry tub must be no shorter than 39-in (99 cm) and no higher than 96-in (244 cm) maximum.

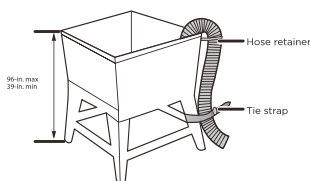
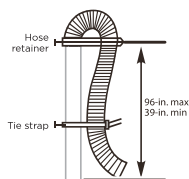
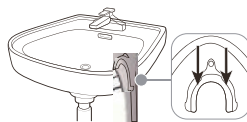

SET UP & USE

Level your washer

CAUTION

Do not use your washing machine without leveling. If your washer is not level, it may:

- Vibrate excessively which can cause your washer to malfunction.
- Make excessive noise.
- Indicate error codes when the washer is running.

Extend the leveling legs only as much as is necessary. If the legs are extended too much, your washer may vibrate.

Determine if the washer is level by checking the position of the tub or by using a level.

1. Place the washer in position.
2. Open the lid of the washer, and fill the bottom of the tub with water to reach the rim on the edge.
3. If the washer is level, the water level will reach the bottom rim of the tub evenly. If it is not level turn the front leveling leg clockwise or counterclockwise as necessary.

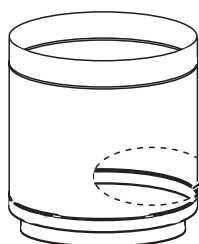

Bottom rim of the tub

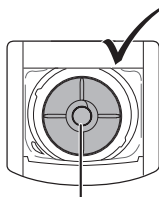

Washer is level - The water level is even all around

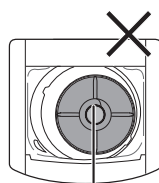

Washer not level - The water level is uneven and will need adjustments to be level.

4. If your washer is not level, carefully tilt your washer just enough to adjust the leveling legs on the bottom front of your washer. Extend the legs only as much as is necessary. If the legs are extended too much, your washer may vibrate.

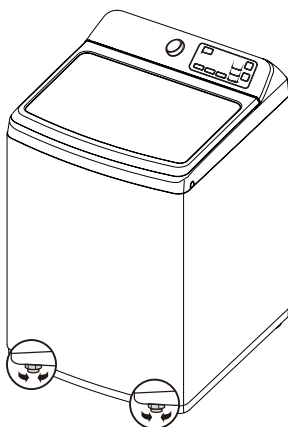

Turn the front leveling legs clockwise or counterclockwise as necessary.

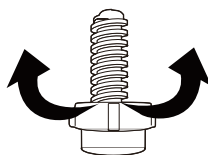

Adjustable legs

SET UP & USE

Power on

Plug the power cord into a well-grounded, 3-prong, 120 Volt 60 Hz approved electrical outlet, protected by a 15-amp fuse or comparable circuit breaker. Your washer is grounded through the third prong of the power cord.

BEFORE FIRST USE

- Run a test cycle to ensure your washer is properly installed.
- Load the wash tub approximately 1/4 full with dry laundry.
- Turn the Cycle Selector Knob to select the Rinse & Spin cycle.
- Press the Power button.
- Press the Start/Pause button to begin the test cycle.

Your washer should not rock or vibrate excessively when water fills the tub or during washing or spinning. It should also drain well during the spin cycle.

- If any water leaks are detected while the washer is filling or draining, check the water connections.
- If the washer rocks and/or vibrates excessively, level it again.

⚠ WARNING: The electrical components (valve, retractor, motor, and drain pump) in this washer are intentionally not grounded. This means they could cause an electric shock if touched while the washer is plugged in and running. Do not touch these parts when the washer is on.

NOTE: For best performance do not load the tub more than $\frac{3}{4}$ full of dry clothes. DO NOT OVERLOAD.

QUICK START GUIDE

Default settings can be changed. See USING THE CONTROL PANEL section for more details.

Add HE detergent to the detergent dispenser according to detergent manufacturer's instructions. HE detergent pods can be added to the wash tub before adding clothes. Add optional pre-wash and/or fabric softener to the detergent dispenser.

Load clothing, maximum $\frac{3}{4}$ full.

Close the Lid.

NOTE: Unit will not start with the lid open.
Press ON/OFF to power on the unit.

Turn the selector dial to a cycle such as NORMAL
Select Temp, Water Lever and Soil Level.

Press the Start/Pause button.

For more details on cycles and default setting refer to the wash program chart.

When the wash cycle is complete, promptly remove the laundry.

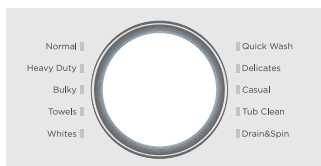

SET UP & USE

USING THE CONTROL PANEL

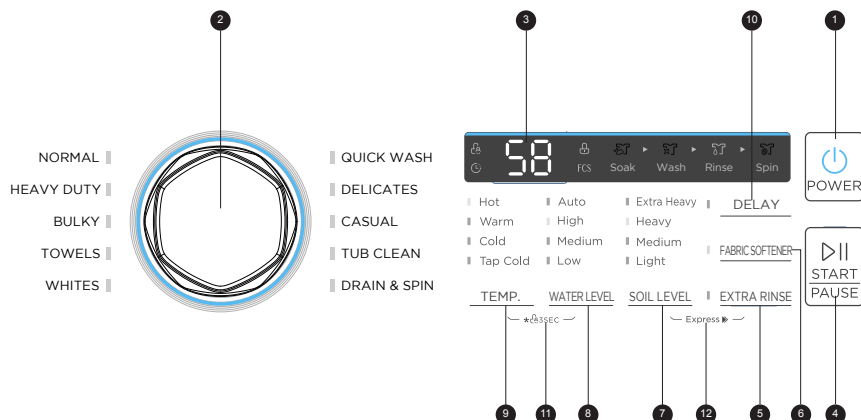

1. POWER

Press the On/Off button once to turn ON the power to the washer. Press again to turn OFF the unit. If the washer is left on and the START/PAUSE button is not pressed within 10 minutes. The washer will turn off.

2. Cycle Selector Knob

Turn to select a wash cycle.

3. Digital Display

The digital display will show and count down the estimated minutes for the wash cycle selected. If delay start is set, the display will indicated the amount of hours until the wash cycle is to begin. Indicator lights show selected options and cycle status.

4. START/PAUSE

Press the START/PAUSE button once to start the wash cycle.

Press again during operation to PAUSE the cycle, to add or remove clothes.

Press again to continue the cycle.

NOTE: When the cycle is paused the settings cannot be changed.

5. Extra Rinse

Press the Extra Rinse button to select an additional rinse cycle.

6. Fabric Softener

Add liquid fabric softener to the fabric softener compartment, then press this button. The softener will be added to the cycle at the correct time.

7. Soil Level

Press to select the soil level Extra Heavy, Heavy, Medium, Light.

SET UP & USE

8. Water Level

Select the water level for the wash and rinse cycles:

Auto - Automatically selects the water level according to the load weight.

High - For Large Loads

Medium- For Medium Sized Loads

Low - For Small Loads

9. Temp

Select Hot, Warm, Cold or Tap Cold Wash Cycles.

NOTE: Rinse cycles are cold.

10. Delay

You can delay the start of the wash cycle up to 24 hours. Activate Delay by pressing the button to add to the start time you press the button. The digital display will show the amount of hours remaining until the wash cycle is programmed to start.

11. Control Lock

Press and hold the Water Level and Temp. buttons at the same time for three seconds to turn on the control lock function. Press and hold these buttons again for three seconds to turn off the function. When the control lock function is turned on, the only button that works is the POWER button, Water Level and Temp. buttons used to control the lock function.

12. Express

After selecting a program, press the Soil Level and Extra Rinse buttons at the same time to shorten the program by 5 minutes.

SET UP & USE

Wash Program Chart

Program	Water Level	Default Time (minutes)	Temp.	Extra Rinse	Soil Level	Delay (minutes)	Express	Fabric Softener
Normal Regular clothing like T-shirts and jeans.	Auto High Medium Low	23 20 18	Hot Warm Cold Tap Cold	Y/N	Light Medium Heavy Extra Heavy	2-24	N	Y/N
Heavy Duty Heavily soiled items	Auto High Medium Low	26 21 16	Hot Warm Cold Tap Cold	Y/N	Light Medium Heavy Extra Heavy	2-24	Y/N	Y/N
Bulky Large items	Auto High Medium Low	17 12 7	Hot Warm Cold Tap Cold	Y/N	Light Medium Heavy Extra Heavy	2-24	Y/N	Y/N
Towels Towels, wash cloths etc.	Auto High Medium Low	22 17 12	Hot Warm Cold Tap Cold	Y/N	Light Medium Heavy Extra Heavy	2-24	Y/N	Y/N
Whites White clothing and linens.	Auto High Medium Low	24 19 14	Hot Warm Cold Tap Cold	Y/N	Light Medium Heavy Extra Heavy	2-24	Y/N	Y/N
Quick Wash A short cycle for lightly soiled items	Medium Low	4 3	Hot Warm Cold Tap Cold	Y/N	Light Medium	1-24	N	Y/N
Delicates For fabrics such as silk, lace, and lingerie.	Medium Low	9 7	Hot Warm Cold Tap Cold	Y/N	Light Medium Heavy	2-24	Y/N	Y/N
Casual For lightly soiled items and synthetic fabrics.	Auto High Medium Low	26 22 18	Warm Cold Tap Cold	Y/N	Light Medium Heavy	2-24	Y/N	Y/N
Tub Clean Cleans the washer drum.	High	24	Hot	-----	Extra Heavy	2-24	-----	-----
Drain & Spin Used to remove excess water from clothes without adding more water. This can be used for hand washed clothes to dry faster	-----	-----	-----	-----	-----	1-24	-----	-----

Note: Default settings are in bold. Wash times are automatically adjusted when default settings are changed.

Overloading may reduce washing efficiency, cause excess wear, and possible creasing and wrinkling of fabrics.

When washing large bulky items such as rugs or pillows that do not fill the tub completely, add a few towels to improve spin performance.

Wash delicate items such as bras, hosiery and other lingerie on the delicate cycle with other lightweight fabrics.

SET UP & USE

! WARNING

To reduce the risk of electric shock, or injury to persons, read the important safety instructions before operating this appliance.

! WARNING:

- Never insert hands inside washer until drum stops spinning.
- Do not insert any fabric with gasoline, petroleum, benzene, paint thinner, alcohol or any other flammable substances.
- Do not put oil soaked items in the washer.
- Do not attempt to wash items with plastic, foam or rubber.
- Never keep clothing in the tub for long periods of time. This can cause mildew, wrinkling etc.

Detergent

- This washer is designed for high efficiency (HE) detergent only, to avoid excessive sudsing.
- Add the manufacturer's recommended amount of detergent directly into the detergent compartment before starting your washer.
- Always reduce the amount of detergent if the load is small or lightly soiled, or if your water is very soft. Never use more than the maximum amount recommended by the detergent manufacturer.

Detergent Dispenser

- Load liquid or powder detergent in the compartment indicated.
- Pour the recommended amount of laundry detergent directly into the compartment before starting your washer.
- If you are using color-safe bleach, add it with the detergent to the detergent compartment.

Detergent Dispenser

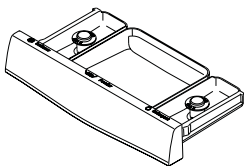

- When adding color-safe bleach with detergent, both laundry products should be in the same form (liquid).

Loading PODs in the washer

- Place the laundry pods directly at the bottom of an empty washing machine drum. Then, add clothes on top of the pods.

Loading PODs at the bottom of the basket will improve wash performance and will enable detergent to dissolve more easily in the wash.

SET UP & USE

Bleach Compartment

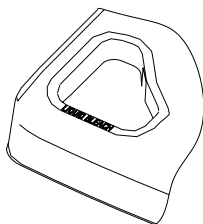

Using the bleach compartment (chlorine bleach)

- Add chlorine bleach to the bleach compartment. Do not over-fill the compartment.
- There is no water inlet to the bleach dispenser, so the bleach will directly load into the tub when you pour it in.
- Avoid splashing or over-filling the compartment.
- Never pour undiluted liquid chlorine bleach directly onto the load or into the tub. Doing so can damage fabrics, by weakening of the fibers or stripping the color.

NOTE: Do not pour color-safe bleach into the bleach compartment. Instead, add it to the detergent compartment.

Using the fabric softener compartment

- Whenever fabric softener is used, make sure to press the **FABRIC SOFTENER** button on the control panel. The dispenser will automatically release the liquid fabric softener at the correct time during the rinse cycle.

CAUTION

- Use the softener compartment **ONLY** for liquid fabric softeners.
- Do not use liquid fabric softener that is too thick as it may not mix with the water sufficiently.
- Be sure to select the **Fabric Softener** option when using fabric softener so that it is released in the rinse portion of the cycle.

Add detergent and additives to the compartment

- Turn the cycle selector to select a washing cycle. For information on wash cycles, see Washer Program Chart on Page 24.

SET UP & USE

SORTING AND LOADING

1. Before loading your laundry, be sure to take out coins, keys and other hard objects, and fasten all hooks and zippers.
2. Follow manufacturer's instructions on clothing tag for washing instructions. Sort laundry according to color (light, medium, dark), Fabric type, (delicates, permanent press items) required wash temperature, soil level etc., Washing items that are not color safe can discolor the other items in the load. Mixing colors can cause the dyes to bleed into the other clothes.
3. Items with embroidery or buttons should be turned inside out.
4. Clothes with hooks or zippers can be washed in a mesh bag as to not get caught on other clothing or scratch the drum.
5. Items that produce a lot of lint should be washed separate.
6. Single heavy items can cause the load to be unbalanced. If the washer vibrates and makes loud sound press start/pause to redistribute the load.
7. Do not load more than $\frac{3}{4}$ full of dry clothes.

CARE AND CLEANING

CLEANING AND MAINTENANCE

 **WARNING:** Turn off and unplug appliance before cleaning or maintenance.

Turn off the water faucets after final use. This shuts off the water supply to your washer and prevents the possibility of water damage. Leave the lid open to let the inside of your washer dry out.

Cleaning the Exterior

Use a soft cloth to wipe up all detergent, bleach, or other spills as they occur.

Cleaning the Interior

Periodically clean the interior to remove any dirt, soil, odor, mold, mildew, or bacterial residue from washing clothes.

Failure to follow these instructions may result in unpleasant conditions, including odors or permanent stains in the washer or on laundry.

To remove hard water deposits, use a cleaner labeled “Washer safe”.

Cleaning the Control Panel

Clean with a soft, damp cloth. Do not use abrasive powders or cleaning pads.

Do not spray cleaners directly on the panel. The control panel finish may be damaged by some laundry pre-treatment soil and stain remover products. Apply such products away from the washer and wipe up any spills or over-spray immediately.

Cleaning the Detergent, Bleach, or Softener Compartment

Clean with a soft, damp cloth. Do not use abrasive powders or cleaning pads.

Do not spray cleaners directly on the panel. The control panel finish may be damaged by some laundry pre-treatment soil and stain remover products. Apply such products away from the washer and wipe up any spills or over-spray immediately.

Cleaning the Tub

The Self Clean cycle is a self-cleaning cycle that removes the causes of odors inside the washer without using a cleaning agent. It is suggested to clean the tub about once a month.

 **WARNING:** The electrical components (valve, retractor, motor, and drain pump) in this washer are intentionally not grounded. This means they could cause an electric shock if touched while the washer is plugged in and running. **Do not touch these parts when the washer is on.**

CARE AND CLEANING



CAUTION:

Never use the tub clean cycle when laundry is in the washer. This may damage the laundry or the washer.

- With the tub empty, add one cup of chlorine bleach to the bleach dispenser.
- Turn the control knob to power on.
- Turn the cycle selector to Self Clean.
- Press the Start/Pause button.

Storing the Washer

Damage can occur if water is not removed from hoses and internal components before storage. To prepare the washer for storage:

Select the Quick Wash cycle and add bleach. Run the washer through the cycle without a load.

- Turn off the water faucets and disconnect the inlet hoses.
- Unplug the washer from the electrical outlet and leave the lid open to let air circulate inside the tub.



CAUTION: If the washer has been stored in below-freezing temperatures, allow time for any leftover water to dry out before use.

CLEANING AND CARE

CLEANING THE INLET FILTER

Shut off the water supply and disconnect the inlet hose.

Pull out the filter with pliers, removing as shown. Clean the filter and reinstall it. Reconnect the inlet hose.

Turn on the water supply and make sure there is no water leakage.

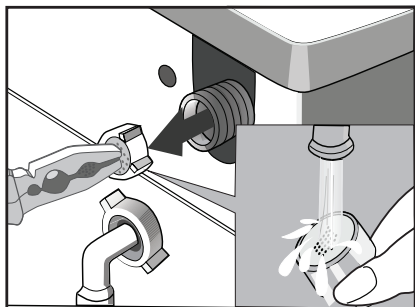

Drain pump filter:

The drain pump filter collects lint and small items so it does not pass through the drain. It should be cleaned approximately once a month depending on frequency of use.

If the washer does not empty or spin properly or if it makes an unusual noise during draining, there may be an obstruction.

⚠ WARNING: The drain pump filter should not be accessed while the unit is operating or cycle has just been completed. There may be hot water in the pump. Allow time for water to cool before accessing.

⚠ WARNING: When cleaning the pump filter be aware that there may be residual water remaining even after draining cycle has finished. To avoid spills, place a tray underneath the compartment.

CLEANING AND CARE

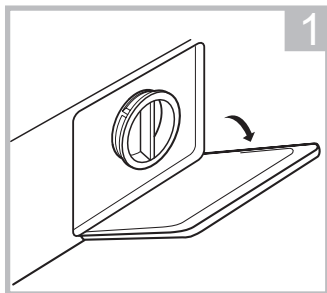

To access the drain pump filter, open the compartment on the bottom right of the machine using a flat head screwdriver, in the notch on the door.

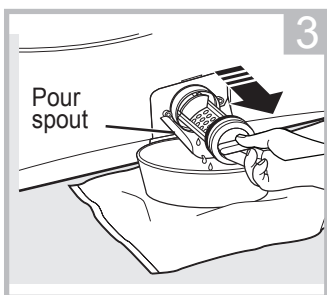

Turn the pump filter counterclockwise to remove. Pull out slowly to allow the water to drain. Clean the debris from the filter.

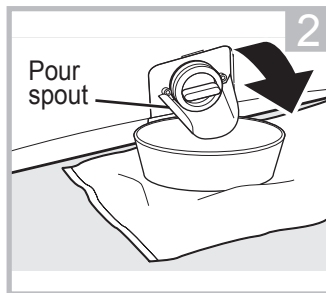

Pull down the pour spout.

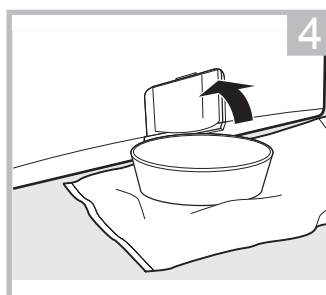

To re-insert the pump filter, turn it clockwise. Tighten securely. Push the pour spout back into place. Close the compartment.

TROUBLESHOOTING & WARRANTY

BEFORE YOU CALL FOR SERVICE

IF THE UNIT FAILS TO OPERATE:

A) Check to make sure that the unit is plugged in securely. If it is not, remove the plug from the outlet, wait 10 seconds and plug it in again securely.

B) Check for a blown circuit fuse or a tripped main circuit breaker. If these seem to be operating properly, test the outlet with another appliance.

IF NONE OF THE ABOVE SOLVES THE PROBLEM, CONTACT OUR CUSTOMER SATISFACTION CENTER. DO NOT TRY TO ADJUST OR REPAIR YOURSELF.

IMPORTANT

DO NOT RETURN THIS PRODUCT TO THE STORE

**If you have a problem with this product, please contact the
W Appliance Co. Customer Satisfaction Center at
844-299-0879 or service@equitybrands.com.**

**DATED PROOF OF PURCHASE, MODEL # AND SERIAL #
REQUIRED FOR WARRANTY SERVICE.**

TROUBLESHOOTING & WARRANTY

TROUBLESHOOTING

Troubleshoot your problem by using the chart below. If the unit still does not work properly, contact W Appliance Co. customer service center or the nearest authorized service center. Customer must never troubleshoot internal components.

PROBLEM	SOLUTIONS
Washer does not start	<ul style="list-style-type: none"> • Make sure that your washer is plugged in. • Make sure that the lid is closed. • Make sure that the water source faucets are open. • Make sure that you press the Start/Pause button to start your washer. • Before your washer starts to fill, it makes a series of clicking noises to make sure that the lid is locked. The washer doesn't drain after the lid locks. For automatic cycles: Before filling, and after the lid locks, a load sensing program starts. Washer will agitate clothing without water to determine load type, water level, and cycle time. Then it fills. This can take up to one minute. Its normal. For non automatic cycles the washer fills after the lid locks. • Check the fuse or reset the circuit breaker.
No water or not enough water	<ul style="list-style-type: none"> • Make sure that both faucets are fully turned on. • Make sure that the water pressure is in the range listed in water requirements on page 17. • Make sure that the water inlet hoses are not kinked. Straighten if necessary. Disconnect the hoses and clean the screens. The inlet screens may be clogged. • This is a water efficiency washer. It does not fill to the levels of a standard washer. Low water levels are normal. It is normal for clothing to float above the surface of the water level. • For automatic cycles: Before filling, and after the lid locks, a load sensing program starts. Washer will agitate clothing without water to determine load type, water level, and cycle time. Then it fills. This can take up to one minute. Its normal. For non automatic cycles the washer fills after the lid locks.

TROUBLESHOOTING & WARRANTY

PROBLEM	SOLUTIONS
When Washer has excessive vibration or noise	<ul style="list-style-type: none"> • Make sure that your washer is set on a level surface. If surface is not level, adjust your washer's feet to level your washer. • Make sure your washer is not touching any other object. • Make sure that the laundry load is balanced. • During the spin process, if the clothes are piled to one side of the tub, your washer may stop because of the imbalance. Your washer tries up to three times to solve the problem automatically. If the washer cannot solve the problem, try to manually redistribute clothes inside the tub. • Check to make sure foam packaging pieces are not stuck under washer.
Washer stops	<ul style="list-style-type: none"> • Make sure the power outlet is a working outlet. • Check the fuse or reset the circuit breaker. • Close the lid, then press the Start/Pause button to start your washer. For your safety, your washer does not spin unless the lid is closed. • Before your washer starts to fill, it makes a series of clicking noise to make sure that the lid is locked. The washer doesn't drain after the lid is locked. For automatic cycles; Before filling, after the lid locks, a load sensing program starts. Washer will agitate clothing without water to determine load type, water level, and cycle time. Then it fills. This can take up to one minute. Its normal. For non automatic cycles the washer fills after the lid locks. • Sometimes your washer may pause between stages in the cycle. Wait to see if your washer starts again. • Disconnect the inlet hoses and clean the screens periodically. The inlet screens may be clogged.
Lid is locked or will not open	<ul style="list-style-type: none"> • Press the Start Pause button to pause the washer. • You cannot open the lid if the washer is running. • After you pause the washer, it may take a few seconds for the lid lock to release. • If the lid is locked when your washer is not running, press the Power button to turn on your washer. • If power fails when your washer is running, when power is restored, the lid unlocks. Your washer waits three minutes the runs the rest of the cycle.

TROUBLESHOOTING & WARRANTY

PROBLEM	SOLUTIONS
The washer does not drain or spin	<ul style="list-style-type: none"> • Check the fuse or reset the circuit breaker. • Close the lid, then press the Start Pause button to start your washer. For your safety, your washer does not spin unless the lid is closed. • Make sure that the drain hose is not kinked. Straighten as necessary. Make sure that the height of the drain hose is within specified limits. See Drainage requirements on Page 17. • The Pipes to your sewer system may be clogged. Contact a plumber or qualified repair professional. • Make sure that you have selected the correct temp. • Make sure that the water source faucets are fully opened. • Make sure that the hoses are connected to connect faucet and water intake connections on your washer, then flush the lines. See Connect the inlet hoses on page 17. • Disconnect the hoses and clean the screens. The inlet screens may be clogged.
Load is too wet at the end of the cycle	<ul style="list-style-type: none"> • Use a high-efficiency detergent to reduce over-sudsing. See Detergent information on Page 25. • The load may be too small. Very small loads (One or two items) may become unbalanced and not spin out completely.
Water leaks	<ul style="list-style-type: none"> • Make sure that all hose connections are tight. See Connect the water hose on page 17 and Connect the drain hose on page 19. • Make sure that the end of the drain hose is correctly inserted and secured to the drainage system. See Connect the drain hose on page 19. • Avoid overloading. • Use a high-efficiency detergent to reduce over-sudsing. see Detergent information on Page 25.
Over-sudsing / detergent residue	<ul style="list-style-type: none"> • Use a high-efficiency detergent to reduce over-sudsing. • If you have "soft" water, reduce the amount of detergent. • For small or highly soiled loads, reduce the amount of detergent.

TROUBLESHOOTING & WARRANTY

PROBLEM	SOLUTIONS
Prevent odor	<ul style="list-style-type: none">Periodically run a Tub Clean cycle to clean the tub. SeeCleaning the tub on page 28. <p>Use a high-efficiency detergent to reduce over-sudsing that can leave residue in the washer.</p>

TROUBLESHOOTING & WARRANTY

Error Codes

Your washer is equipped with an automatic error-monitoring system to detect and diagnose problems.

ERROR CODE	POSSIBLE CAUSE	SOLUTIONS
E1	<p>Water is not supplied</p> <p>The Water Level sensor is not working properly.</p>	<ul style="list-style-type: none"> • Make sure the water taps are open. • Make sure the water hoses are not clogged. • Make sure the water taps are not frozen. • Make sure the washing machine is operating with sufficient water pressure. • Make sure that the cold water tap and the hot water tap are properly connected. • Clean the inlet hose screens as it may be clogged. • If the information code remains, Call service center.
E2	The Water is not draining	<ul style="list-style-type: none"> • Make sure the drain hose is not clogged. • Make sure the drain hose is positioned correctly, depending on the connection type. • Clean the debris filter as it may be clogged. • Make sure the drain hose not bent or kinked. • If the information code remains, Call service center.
E3	The lid is open.	<ul style="list-style-type: none"> • Close the lid. See Installation instructions to, "Level your washer". • If the information code remains, Call service center.
E4	Spinning does not work.	<ul style="list-style-type: none"> • Make sure laundry is spread out evenly. • Make sure the washing machine is on a flat, stable surface. • Redistribute the load. If only one item of clothing needs washing, such as a bathrobe or pair of jeans, the final spin result might be unsatisfactory.

TROUBLESHOOTING & WARRANTY

ERROR CODE	POSSIBLE CAUSE	SOLUTIONS
E5	The unit is out of balance in spin operation.	<ul style="list-style-type: none"> •Adjust the washer level refer to installation instructions. •If situation continues, call service center
F5	Load sensing failed.	<ul style="list-style-type: none"> •Call service center.
F8	Water Leveling sensing failed.	<ul style="list-style-type: none"> •Call service center.
Fd	Lid is not locked properly.	<ul style="list-style-type: none"> •Make sure that the lid is closed properly and press the Start/Pause button. You can hear the locking sound to lock the lid in the beginning of the cycle. The washer will not operate unless the lid is locked. •Make sure that nothing is caught under the lid, including shipping material or clothing. •Make sure that the latch mechanism is fully retracted.Make sure that the latch mechanism is fully retracted. •If the lid is closed and this error message is still displayed, Call service center.
CL	The lid has opened for over 20 seconds with the control lock function activated.	<ul style="list-style-type: none"> •Press the Power button to turn off your washer. •Turn off the control lock function. See instructions on page 23.
C9	The PCB is failed.	<ul style="list-style-type: none"> •Call service center.
C9		<ul style="list-style-type: none"> •Call service center.

LIMITED WARRANTY

ACTIVATE WARRANTY

Any repair, replacement, or warranty service, and all questions about this product should be directed to W Appliance Co. at 844-299-0879 from the US, including Puerto Rico, or Canada.

Some issues can be addressed without service. Before contacting regarding your warranty, please visit the "Troubleshooting" section of your user manual.

All warranty service is provided exclusively by our authorized W Appliance Co. service providers. For service in US, including Puerto Rico, and Canada call 1-844-299-0879 to create a ticket. When calling, please have the following information available: date of purchase, model number, proof of purchase and a brief description of the problem.



WHAT IS COVERED

YOUR SOLE AND EXCLUSIVE REMEDY UNDER THIS LIMITED WARRANTY SHALL BE PRODUCT REPAIR AS PROVIDED HEREIN. This limited warranty is valid only in the United States or Canada and applies only when the major appliance is used in the country in which it was purchased:

ONE (1) YEAR FROM THE DATE OF DELIVERY OF THE ORIGINAL PURCHASE (PARTS AND LABOR INCLUDED):

W Appliance Co. will pay for factory-specified replacement parts and labor to correct defects in materials or workmanship that existed when this major appliance was purchased, or at its sole discretion, replace the product with a new, or remanufactured, unit equivalent to your original purchase. In the event of product replacement, your appliance will be warranted for the remaining term of the original unit's warranty period.

YEARS TWO (2) THROUGH FIVE (5) FROM DATE OF DELIVERY OF THE ORIGINAL PURCHASE (CERTAIN COMPONENT PARTS ONLY - LABOR NOT INCLUDED):

W Appliance Co. will pay for factory-specified replacement parts for the component parts listed below to correct non-cosmetic defects in materials or workmanship in these parts that prevent function of this major appliance and that existed when this major appliance was purchased:

DISHWASHER	WASHING MACHINE	DRYER	REFRIGERATORS AND FREEZERS	MICROWAVE
Lower, Upper and Third Level (where applicable) Wire Racks (excludes cup shelves, silverware basket, and third rack trays), Chopper Blade, Stainless Steel Tub and Inner Door Liner	Drive Motor (Stator and Rotor Only)	Drive Motor Only	Compressor Only	Magnetron Tube Only

LIMITED WARRANTY

WHAT IS NOT COVERED / EXCLUSIONS

1. Commercial, non-residential or multiple family use or use inconsistent with the product instructions and manuals.
2. In-home instruction on how to use your product.
3. Repair to correct improper maintenance, installation not in accordance with installation instructions or electrical or plumbing codes, or repair of household electrical or plumbing systems.
4. Consumable parts (e.g., light bulbs, batteries, air or water filters, preservation solutions, etc.).
5. Defects or damage resulting from accident, misuse, abuse, alteration, fire, floods, acts of God or improper installation.
6. Damages, defects, or repairs caused by unauthorized servicers or use of non-genuine or third-party parts.
7. Any damage to the finish of appliance or home incurred during installation, including but not limited to floors, cabinets, walls, etc.
8. Cosmetic damage (e.g., scratches, dents, chips, and other damage to appliance finishes), unless such damage results from defects in materials and workmanship and is reported to W Appliance Co., within 48 hours from date of delivery.
9. If the appearance or exterior of the product has been damaged or defaced, altered or modified in design or construction.
10. Discoloration, rust or oxidation of surfaces resulting from caustic or corrosive environments (e.g., high salt concentrations, high moisture or humidity or exposure to chemicals).
11. Product pick-up or delivery. This warranty is for in-home repair only.
12. Travel or transportation expenses for service in remote locations where an authorized servicer is not available.
13. Products not accessible to provide required service or for expenses making the product accessible for servicing.
14. Surcharges including but not limited to, any after hour, weekend, or holiday service calls, tolls, ferry trip charges, or mileage expenses for service calls to remote areas, including the state of Alaska.
15. Repair, removal or reinstallation of inaccessible appliances or built-in fixtures (e.g., trim, decorative panels, flooring, cabinetry, islands, countertops, drywall) that interfere with servicing, removal or replacement of the product.
16. Appliances with original, factory installed model/serial numbers removed, altered or not easily determined.
17. Incidental or consequential damages (e.g., loss of food or medicine) resulting from appliance breakdown or delay in service, repair or replacement.
18. Transportation and shipping costs associated with the replacement of the unit.
19. Glass parts and other accessory items included with the unit.
20. Products that have been purchased as refurbished, like new, second-hand, under "as is" or "final sale" terms.
21. Units that have been transferred from the original owner/purchaser.
22. If there is damage due to power line surge, user damage to the AC power cord or connection to improper voltage source.
23. Products which are not defective or broken, or which are working as described in the owner's manual.

DISCLAIMER OF IMPLIED WARRANTIES

Repair or replacement as provided under this warranty is the exclusive remedy to the customer. W Appliance Co. shall not be liable for any incidental or consequential damages for breach of any express or implied warranty on this product, except to the extent prohibited by applicable law. Any implied warranties, including any implied warranty of merchantability or implied warranty of fitness for a particular purpose, are limited to the duration of this warranty or the shortest period allowed by law. Some states do not allow the exclusion or limitations of consequential damages, or limitations on how long the warranty lasts. In these cases, the above exclusions or limitations may not apply to you. This warranty gives you specific legal rights and you may also have other rights which may vary from state to state.

W Appliance Co. does not warrant that the appliance will work properly in all environmental conditions and makes no warranty and representation, either implied or expressed, with respect to the quality, performance, merchantability, or fitness for a particular purpose other than the purpose identified within this user's manual. W Appliance Co. has made every effort to ensure that this user's manual is accurate and disclaims liability for any inaccuracies or omissions that may have occurred. Information in this user's manual is subject to change without notice and does not represent a commitment on the part of W Appliance Co. W Appliance Co. reserves the right to make improvements to this user's manual and/or to the product described at any time without notice. If you find information in this manual that is incorrect, misleading or incomplete, please call 844-299-0879.

W Appliance Co.
New York, NY 10018

EXTENDED WARRANTY COVERAGE

Protect Your Appliance with Extended Warranty Coverage

Thank you for purchasing your new appliance! Your product comes with our one-year limited warranty, but why stop there? With our Extended Warranty and Accidental Damage Protection Plan, provided by Mulberry, you can ensure your appliances are covered for longer—without worrying about unexpected breakdowns or accidents.

Why Upgrade to the Extended Warranty Plan?

- **Comprehensive Protection** – Extend your warranty coverage and get full protection for accidental damage and mechanical/electrical failures, giving you peace of mind well beyond the first year.
- **No Hidden Costs** – You won't pay any deductibles or service fees for repairs or replacements. We've got you covered!
- **Avoid Expensive Repairs** – Appliances like refrigerators, air conditioners, and dishwashers can be costly to repair. Keep your products running smoothly without the worry of unexpected repair bills.
- **Quick & Easy Claims** – Mulberry offers hassle-free claims and quick, reliable service when you need it most—no complicated paperwork, just fast and efficient help.



Coverage	Basic Warranty	Protection +
Mechanical / Electrical Failure Coverage	Yes (1 year)	Yes (2 - 4 years)
Service Fee or Deductible	Yes (may apply)	No
Parts & Labor Costs Covered	Yes (limited to 1 year)	Yes (2 - 4 years)
Hassle-Free Claims Process	Standard	Priority (faster service)
Repair / Replacement Options	Yes (limited to 1 year)	Yes (2 - 4 years)
Convenience & Peace of Mind	Limited to 1 year	Guaranteed for up to 4 years



BLACK & DECKER, BLACK+DECKER, the BLACK & DECKER and BLACK+DECKER logos and product names are trademarks of The Black & Decker Corporation, used under license. All rights reserved.

Product in this box may differ slightly from that pictured. Does not affect function. Not all accessories shown in photography are included in this package.

Imported by W Appliance, Inc., 1356 Broadway, New York, NY 10018
Customer Service: 844-299-0879