



M832 Portable Printer User Guide

Before using this product, please read this manual carefully.

English

01. Package Contents

- Printer*1
- Flannel Bag*1
- Data Cable*1
- Quick Start Guide*1

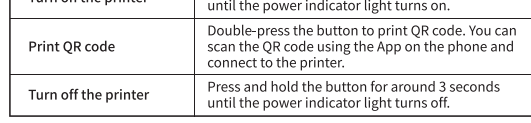

*Attention: All pictures in this instruction manual are for illustration purposes only. The actual product may vary due to product enhancement.

02. Printer Components

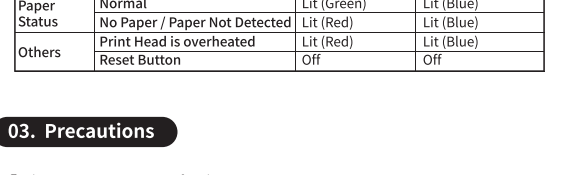

Button Function

(Power) Button Function	Operation
Turn on the printer	Press and hold the button for around 3 seconds until the power indicator light turns on.
Print QR code	Double-press the button to print QR code. You can scan the QR code using the App on the phone and connect to the printer.
Turn off the printer	Press and hold the button for around 3 seconds until the power indicator light turns off.

Indicator Light

	Status	Power Indicator	Status Indicator Light
Printer Status	Normal	Lit (Green)	Lit (Blue)
	Cover is open	Lit (Green)	Lit (Blue)
	Charging while powered off	Off	Blink Slowly (Blue)
	Charging while powered on	Off	Blink Slowly (Blue)
	Fully Charged	Lit (Green)	Lit (Blue)
	Low Power	Blink Slowly (Red)	/
Connection Status	Bluetooth: Connected	Lit (Green)	Lit (Blue)
Paper Status	Normal	Lit (Green)	Lit (Blue)
	No Paper / Paper Not Detected	Lit (Red)	Lit (Blue)
	Print Head is overheated	Lit (Red)	Lit (Blue)
Others	Reset Button	Off	Off

03. Precautions

- Please use 5V=2A input for charging.
- Please connect the USB cable to the power adapter before charging, please gently insert or unplug the charging cable when charging, to prevent excessive force from damaging the port.
- After the charging is completed, please unplug the charging cable in time.
- In order to avoid danger, do not use or charge in the environment of high temperature, high humidity, heavy smoke and dust, such as in bathroom, steam room, near to open flame, etc.
- Improper charging may cause damage to the print head.
- Do not touch the print head to prevent scalding caused by overheating.
- The tearing blade is sharp, please be careful to avoid touching it by mistake.
- If the machine is malfunctioning, insert the reset hole to restart the machine.

Battery warning instructions

- * It is forbidden to disassemble, hit, squeeze the battery, or throw it into fire;
- * If severe swelling occurs, please do not reuse it;
- * Do not place in a high temperature environment, and it is strictly prohibited to use the battery after soaking in water;
- * There is a danger of explosion if the battery is replaced by the wrong type. Be sure to dispose of the used battery according to the instructions;
- * If consumers use a power adapter for power supply, they should purchase a power adapter that meets the requirements of corresponding safety standards or a power adapter with CCC certification.

04. Install App

1. Download the App

Please search for "Phomemo" on your phone's App market and download the App.

Search for Phomemo in the Apple App Store, click to download and install



Search for Phomemo in the Google App Store, click to download and install

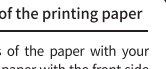
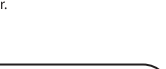

2. How to download and install driver

Download the latest driver from the official website. Download the relevant driver according to the your operating system version and follow the instruction to install the driver.

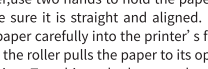
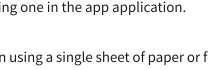
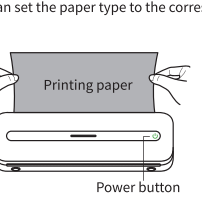

05. Instructions

1. Instructions for consumable usage

- Press the two Open Cover Buttons at the same time to open the cover.
- Take out the randomly included paper roll and unfold it.
- Install the paper roll back into the paper compartment and pull the cover of the Paper Output Slot. Close the Cover.
- Press and hold the power button for 3 seconds to start the printer.

Hint: How to differentiate the front and back of the printing paper

- Take a piece of printing paper and scratch both sides of the paper with your fingernails. The front side is the side with colors. Install the paper with the front side facing upward.
- This product can print different sizes of paper. Please adjust the position of the consumable holder according to the width of the consumables.
- To achieve the best result, please use our genuine printing paper.

2. Instructions for single sheet paper and folded paper usage.

- You can set the paper type to the corresponding one in the app application.
- When using a single sheet of paper or folded paper, use two hands to hold the paper and make sure it is straight and aligned. Insert the paper carefully into the printer's feeder until the roller pulls the paper to its optimal position. To achieve the best result, please use our genuine printing paper.
- When you need to take out the printed paper, press the open cover button simultaneously, and the machine's top cover will gently pop open. Then, remove the paper.

Hint

- The paper must be inserted aligned to the paper feeder.
- This product can print different sizes of paper. Please adjust the position of the consumable holder according to the width of the con
- When using "Folded paper", after printing your documents, tear along the perforation lines.

3-1. Connect the printer to the App



- Method 1**
Turn on the Bluetooth on your phone, launch the Phomemo APP, tap on the icon at the upper right corner of the Phomemo APP main interface, and select the corresponding model from the drop-down list to establish a connection.

*Note: system needs to enable positioning and allow app to obtain relevant permissions.

- Method 2**
Double-press the printer's power button to print a QR code. Open your Phomemo App and press the button on the top right of your Phomemo App home page. On the selection page, press scan and scan the QR code to connect to the printer.

3-2. Connect the printer to the computer

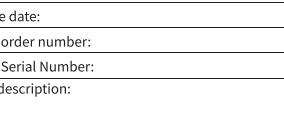

- Step One**
Connect one end of the data cable to your computer and the other end to the printer's USB port. Turn on your printer.
- Step Two**
Enter official website and download the printer's drivers. Install the printer's driver.

Official website: M832.phomemo.com

- Step Three**
Add the printer to your computer and establish a connection. Once the connection is established, you can print your documents from your computer.

06. Official Printing Paper Type

- Normal thermal paper:** Does not contain Bisphenol-A.
- Writable Quick-drying thermal paper:** Thermal paper that does not contain Bisphenol-A, can be written on, and dries ink quickly.

* The printing papers mentioned above are official printing papers.

* Any issues with your printer arising from using non-official printing papers will not be covered under our warranty policy.

07. Warranty card

- Return Exchange Repair

User Info	Name:	Gender:	Phone:
	Address:		

Product Info	Purchase date:
	Product order number:
Product Serial Number:	

Requirements of return /replacement /repair	Reason description:	
---	---------------------	--

Maintenance records	Failure condition:	Maintenance person:
	Handling situation:	Delivery date:
	Maintenance ticket number:	Delivery date:

08. FCC Warning

FCC Warning statement:

This device complies with part 15 of the FCC Rules. Operation is subject to the following two conditions:(1) This device may not cause harmful interference, and (2) this device must accept any interference received, including interference that may cause undesired operation.

Any Changes or modifications not expressly approved by the party responsible for compliance could void the user's authority to operate the equipment.

This equipment has been tested and found to comply with the limits for a Class B digital device, pursuant to part 15 of the FCC Rules. These limits are designed to provide reasonable protection against harmful interference in a residential installation. This equipment generates uses and can radiate radio frequency energy and, if not installed and used in accordance with the instructions, may cause harmful interference to radio communications. However, there is no guarantee that interference will not occur in a particular installation. If this equipment does cause harmful interference to radio or television reception, which can be determined by turning the equipment off and on, the user is encouraged to try to correct the interference by one or more of the following measures:

- Reorient or relocate the receiving antenna.
- Increase the separation between the equipment and receiver.
- Connect the equipment into an outlet on a circuit different from that to which the receiver is connected.
- Consult the dealer or an experienced radio/TV technician for help.

FCC RF exposure statement:
The device has been evaluated to meet general RF exposure requirement. The device can be used in portable exposure condition without restriction.

09. IC Warning

IC Warning statement:

This device contains licence-exempt transmitter(s)/receiver(s) that comply with Innovation, Science and Economic Development Canada's licence-exempt RSS(s). Operation is subject to the following two conditions:

- This device may not cause interference.
- This device must accept any interference, including interference that may cause undesired operation of the device.

L'émetteur/récepteur exempt de licence contenu dans le présent appareil est conforme aux CNR d'Innovation, Sciences et Développement économique Canada applicables aux appareils radio exempts de licence. L'exploitation est autorisée aux deux conditions suivantes:

- L'appareil ne doit pas produire de brouillage;
- L'appareil doit accepter tout brouillage radioélectrique subi, même si le brouillage est susceptible d'en compromettre le fonctionnement.

RF exposure statement

IC RF exposure statement:

The device has been evaluated to meet general IC RF exposure requirement. The device can be used in portable exposure condition without restriction.

IC Déclaration d'exposition aux RF:

L'appareil a été évalué pour répondre aux exigences générales d'exposition aux RF d'IC. L'appareil peut être utilisé dans des conditions d'exposition portable sans restriction.