

Quick Start Guide

D30

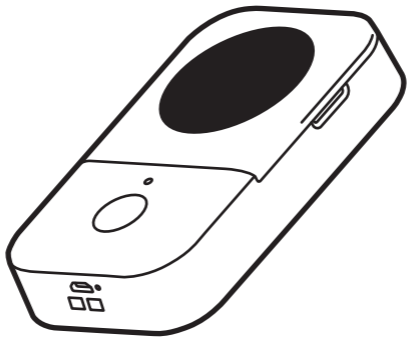

English

1. Product Introduction

1.1 Packing List



Printer × 1



Quick Start Guide × 1



USB Cable × 1

• Single unit



100-Pc 12*40 mm Paper Roll × 1

ⓘ Installed in printer

OR

• Package

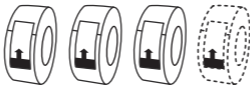

Paper Roll × n

ⓘ Quantity and size tailored to your purchased package

1.2 Printer Parts Instruction

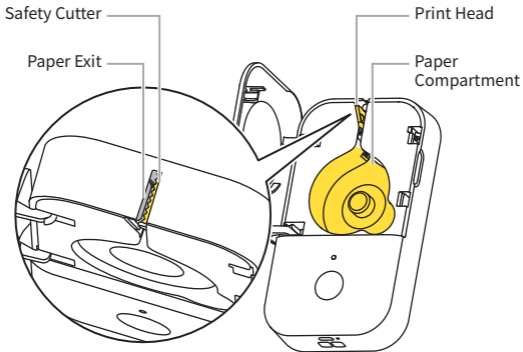
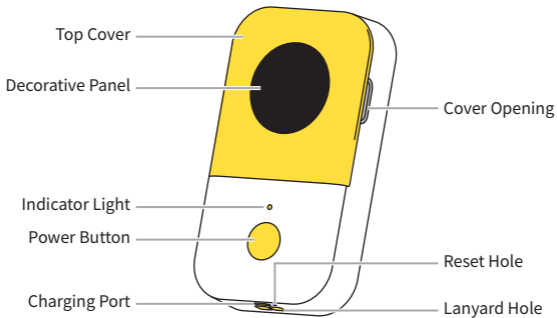

2. Getting Started

2.1 Downloading the App

Method 1: Search for the "Print Master" app on Google Play™ or App Store® to download and install it.



Method 2: Scan the QR code to download the app.



2.2 User Guide

- 01** Remove the protective film.

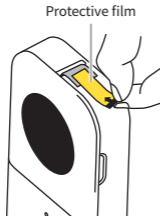

ⓘ Please skip this step if you are not a first-time user of the device.

- 02** Long press the Power Button for 3 seconds until the Indicator Light is green to power up the printer.

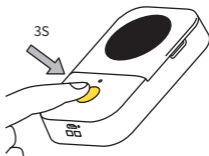

ⓘ If the indicator lighting red, see [6.2. Indicator Light Instructions](#) in this guide.

- 03** Open the "Print Master" app.



- 04** Click [Auto Connect].



- 05** Grant Authorization.

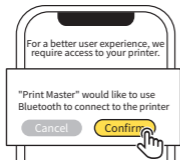

- 06** Wait for the printer to be connected.



ⓘ For more information about app permissions, see [5.2 Permission Description](#) in the electronic guide.

ⓘ You can also find manual connection options on [Home]. For more details, see [4. More Connection Methods](#) in this guide.

- 07** The printer is successfully connected.



- 08** Edit your first label, and tap [Print] after you finish editing.



- 09** Printing is completed.



- 10** Pull the label towards the Safety Cutter and tear it off.

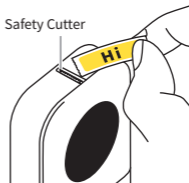

ⓘ The Safety Cutter is on the same side as the Cover Opening.

- 11** Remove the liner.

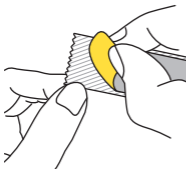

- 12** Attach the label to a dry, flat surface.

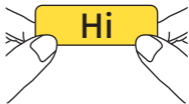

3. Replacing the Paper Roll

- 01** Long press the Power Button for 3 seconds until the Indicator Light is green to power up the printer.

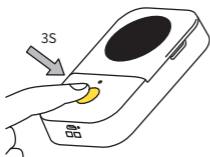

- 02** Take out the paper roll to be installed.

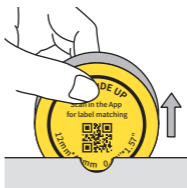

- ⓘ If the indicator lighting red, see [6.2. Indicator Light Instructions](#) in this guide.

- 03** Open the "Print Master" app.



- 04** Wait for the printer to be connected.

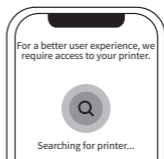

- 05** The printer is successfully connected.



- 06** Go to "Home" and tap [Scan].

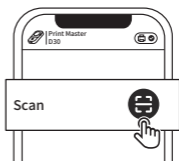

- 07** Scan the QR code on the side sticker.



- 08** The label size is identified.

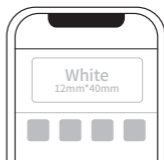

- ⓘ The illustration shows a paper roll with the new packaging. If your paper roll comes with the previous packaging editions without a QR code, please see [4. Confirming Label Sizes](#) in the electronic guide for instructions on identifying the label size and creating a label.

09 Open the Top Cover.

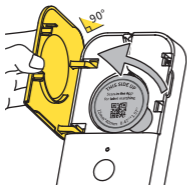

10 Remove the paper roll to be replaced.

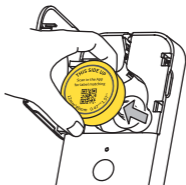

ⓘ Please skip this step if you are installing a paper roll for the first time.

11 Remove the anti-loosening sticker from the new paper roll.



ⓘ Please skip this step if the paper roll to be installed is not brand new.

12 Pull out a small amount of label paper with the side sticker facing up and place the paper roll in the Paper Compartment.

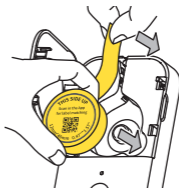

13 Insert the label paper into the Paper Outlet, and make sure the Short Edge is slightly higher than the Paper Outlet.

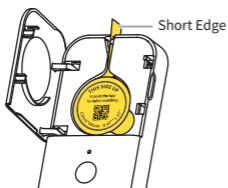

14 Close the Top Cover.

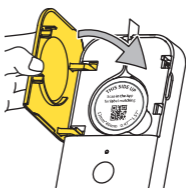

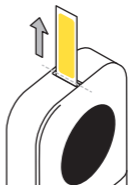
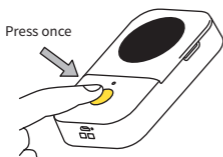

15 Press the Power Button once when the printer is on and the Paper Outlet will automatically release a blank piece of label paper, indicating calibration is complete.

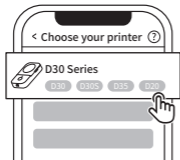

4. More Connection Methods

01 Select your printer.



02 Tap [] at the top right corner for connection.



03 Wait for the printer to be connected.

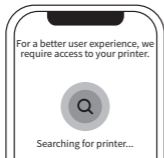

04 The printer is successfully connected.



5. Charging Instructions

1. Please prepare your own power adapter (DC 5V/2A) with a Type-A port.
2. Insert the Micro Port (smaller end) of the USB cable into D30's Micro charger port, and plug the Type-A Port (bigger end) of the USB cable into the Type-A port of the power adapter.
3. After connecting the printer to a power outlet through the power adapter, please check the status of the Indicator Light—a fast flashing green light indicates that the printer is off, while a slow flashing green light indicates that the printer is on.
4. Please charge the printer for at least 20 minutes for immediate use. Charging will be completed in 2 to 3 hours, or when the indicator light stays solid green.
5. As the printer may heat up during charging, avoid placing it on materials such as cotton or linen while charging.
6. Once the battery is fully charged, please unplug it promptly.

- Using the printer while charging will slow down the charging speed.
- To preserve battery life, it is not advisable to print while charging.

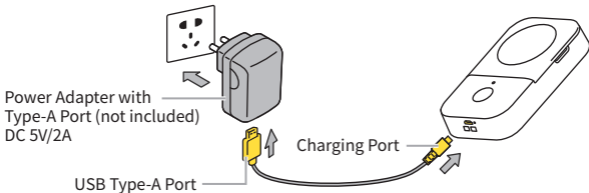







6. Additional Instructions

6.1 Button Instructions

Button Type	Operation	Function
Power Button	Long press for 3s	Power on/off
	Press once when printer is on	Calibrate label position
	Double press when printer is on	Print a self-test page

6.2 Indicator Light Instructions

Status	Meaning	Advised Action
 Solid Green Light	Device functioning properly and fully charged	/
 Fast Flashing Green Light	Charging when printer is off	/
 Slow Flashing Green Light	Charging when printer is on	/
 Solid Red Light	Out of paper	Properly insert label paper into Paper Outlet
	Printer overheat	Pause printing for 5 min for printer to cool down
 Slow Flashing Red Light	Low battery	Charge for 1 hour (or at least 20 min if in urgent need)
 Fast Flashing Red Light	Battery running low	Charge for 2-3 hours

Special Notes

The company assumes full responsibility for the revision and explanation of this manual, with utmost care taken to ensure its accuracy. However, please note that any technical improvements to the product may not be separately notified, and that the images of the product, accessories, software interfaces, etc. in this manual are for illustrative and reference purposes only. Due to product updates and upgrades, the actual product may exhibit slight variations from the images. Please refer to the actual product for accuracy.